



SOBHA ONE

SOBHA
REALTY

A woman with long hair, wearing a brown, draped, long-sleeved top and a matching skirt, stands in a tropical setting. She is surrounded by large palm fronds that create a fan-like pattern behind her. The lighting is warm and golden, suggesting a sunset or sunrise. The overall mood is serene and natural.

ONE

THE JOURNEY BEGINS

ONE that brings you
closer to nature



A place where you can take
one day at a time



ONE

BE ONESELF

It's one of a kind, like you



BEST THAT LIFE HAS TO OFFER

One where the world is
close yet far away

THE POWER OF ONE



*When imagination and vision
come together Life meets
style.*

City and nature hum together,
Work & play find a balance and become One

ONE WAY: YOUR WAY

The best places are hidden in plain sight

Near the vital Ras Al Khor Road, Sobha One is a little world tucked away. Look to the north at the calming waters of the Creek as they look back. Further north in the skyline with panoramic views of The Burj Khalifa, Creek Tower to the Northeast and Downtown to the West.



ARRIVE & DEPART WITH GRACE

Sobha One is right near two new metro lines on Ras Al Khor Road. So, getting home has never been faster. With the West and East, a new planned metro line behind Sobha One, you can be on your terms.





RELAXING BY THE WATER

...ing next to
... off the water,
... across the ripples
... rustling the leaves

... stroll down the path
... the calm water
... weekends lounging
... and
... soaking up the sun



ONE POINT OF VIEW: YOURS

With a canvas spread over 1.5 million square feet, its breathtaking views as far as your eye can see. Look around to views of Golf Course, calm water, iconic Burj Khalifa & Downtown. Every glance sets a different mood.



ONE

S P A C E

Sobha One spreads its tapestry over five interlinked towers. Rising from 30 stories tall and hitting a crescendo of 65 stories, it's one note after another that sings in chorus with the skyline

With 1 to 4 bedroom apartments & 2 to 4 bedroom Duplex, it's a world of its own.



ONE FOR
ALL ALL FOR
ONE



is too short to s... than
the best. At... living is a
... ee.

WAKE UP AND PUTT OFF IN STYLE

The first of its kind in Dubai, a new mini-golf and Putt golf course featuring 18 holes of golf, each meticulously designed.

It is the perfect way to unwind after a long day at work. After all, there's nothing like sinking a long putt on a green fairway. The clubhouse is appointed with upscale amenities for those looking the greens.



DINE BY THE WATERS

The food & beverage esplanade that borders the calm waters is also a feast for the palate to suit every taste and time.

Spread over almost half a kilometer, it offers fine restaurants for an intimate dinner, quick catch-up over a cup of coffee, or a power lunch.



SKY GARDEN

Rise high above and look at the city from the stunning views of the city. Catch the sun rays when the sun sets. Do it all from the magnificent panoramic sky terrace in the sky garden.



COURTYARD FOR THE SENSES



All the 5 Towers at Sobha One have interconnected four themed courtyards. As private outdoor retreats, these lush, landscaped spaces add to the overall aesthetic.

RELAX

In a fast-paced world, finding ways to relax is more important than ever. Take a leisurely stroll through the tree avenues, do yoga on the group decks, or stroll in the gardens. And when you need to refuel, enjoy a meal at the BBQ & dining areas or catch a movie under the stars on our cinema screen. There is something for everyone





REMEMBER

...spend quality
...lunch and enjoy
...ending a day cooling
...with the little ones. So
...memories with you





RECHARGE

We believe fitness should be fun! That's why we've created a unique courtyard that combines the best of gyms with exciting new outdoor features from static bikes to treadmills, circuit training areas and more. So sweat it out and be the best version of yourself.





REFRESH

This tranquil backyard is the way to do it after a long day. Step into the pool and the stress of daily life melts away. Relax, loosen up and your mind will be in the zone. Swim laps. Close your eyes and let the warm sun wash over you in a state of relaxation.





FIXED PAYMENT PLAN

60%	40%
-----	-----

During Construction

On Completion

Grand 1000+ units of 1, 2, 3 & 4 bedroom apartments & 2, 3 & 4 bedroom Duplex
Starting from AED 1.1 million

*T&C Apply

ONE

awaits you...

TOWER A

UNIT PLANS

1 BEDROOM APARTMENT

TYPE A (with powder room + balcony)

TOTAL SALEABLE AREA
 SUITE = 674.79 SQ.FT.
 BALCONY = 57.48 SQ.FT.
 TOTAL = 732.27 SQ.FT.

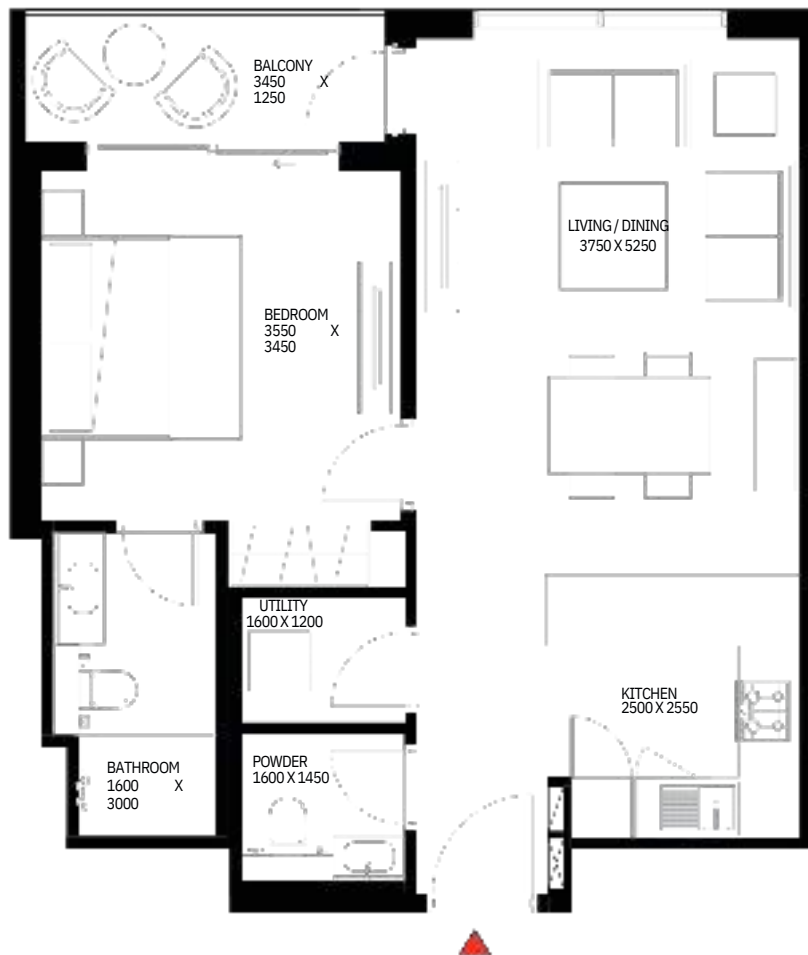
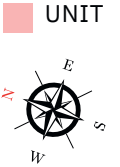
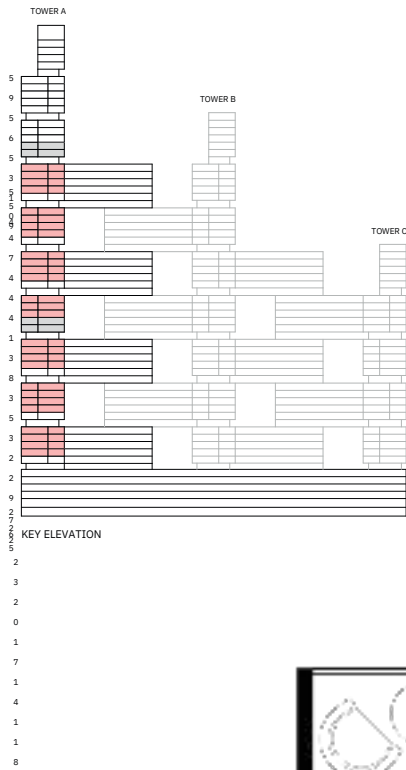

List of unit numbers with this unit plan:

VIEWS

Creek
 A802, A804, A902, A904, A1002, A1004, A1102, A1104, A1402, A1404, A1502, A1504, A1602, A1604, A1702, A1704, A2002, A2004, A2102, A2104, A2202, A2204, A2302, A2304, A2702, A2704, A2802, A2804, A2902, A2904, A3202, A3204, A3302, A3304, A3402, A3404, A3502, A3504, A3802, A3804, A3902, A3904, A4002, A4004, A4102, A4104, A4402, A4404, A4502, A4504, A4602, A4604, A4702, A4704

Disclaimer: 1. All dimensions are in metric, measured to wall finishes. 2. All materials, dimensions & drawings are approximate. 3. Information is subject to change without notice, at developer's absolute discretion. 4. Actual area may vary from the stated area. 5. Drawing are not to scale. 6. All images used are for illustrative purpose only and do not represent the actual size, features, specifications, fittings and furnishings. 7. The developer reserves the right to make revisions/ alterations, at its absolute discretion, without any liability whatsoever.

1 BEDROOM APARTMENT

TYPE A (with powder room + balcony)

TOTAL SALEABLE AREA
 SUITE = 674.79 SQ.FT.
 BALCONY = 57.48 SQ.FT.
 TOTAL = 732.27 SQ.FT.

UNIT

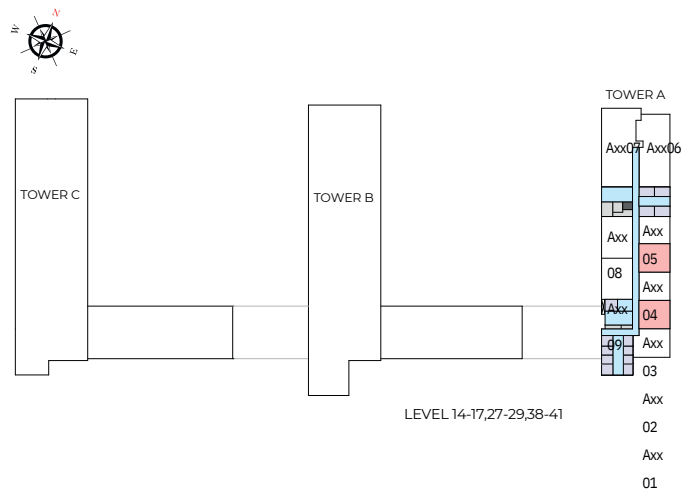
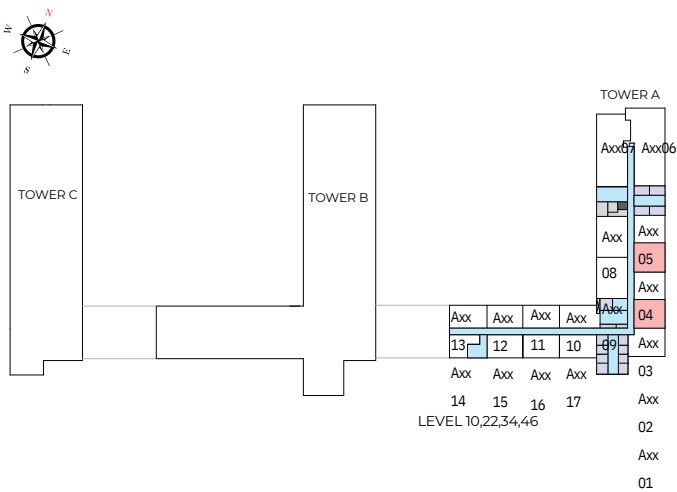
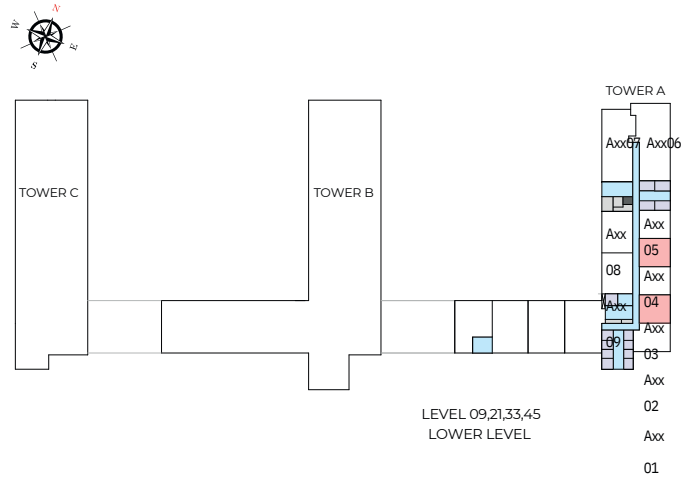
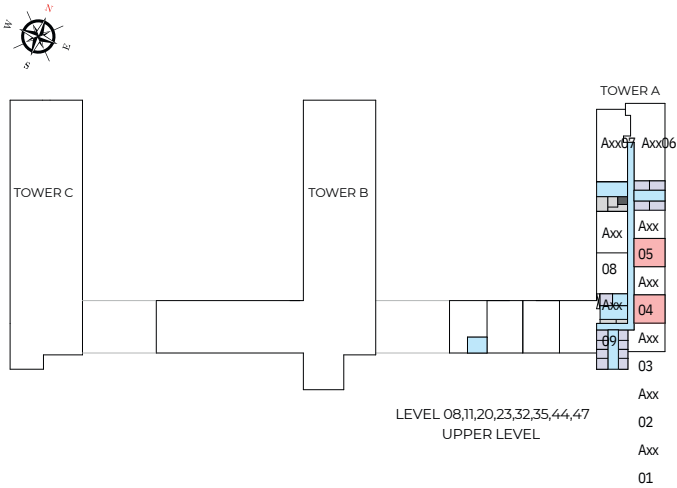

List of unit numbers with this unit plan:

VIEWS

Creek
 A802, A804, A902, A904, A1002, A1004, A1102, A1104, A1402, A1404, A1502, A1504, A1602, A1604, A1702, A1704, A2002, A2004, A2102, A2104, A2202, A2204, A2302, A2304, A2702, A2704, A2802, A2804, A2902, A2904, A3202, A3204, A3302, A3304, A3402, A3404, A3502, A3504, A3802, A3804, A3902, A3904, A4002, A4004, A4102, A4104, A4402, A4404, A4502, A4504, A4602, A4604, A4702, A4704

Disclaimer: 1. All dimensions are in metric, measured to wall finishes. 2. All materials, dimensions & drawings are approximate. 3. Information is subject to change without notice, at developer's absolute discretion. 4. Actual area may vary from the stated area. 5. Drawing are not to scale. 6. All images used are for illustrative purpose only and do not represent the actual size, features, specifications, fittings and furnishings. 7. The developer reserves the right to make revisions/ alterations, at its absolute discretion, without any liability whatsoever.

1 BEDROOM APARTMENT

TYPE A (with powder room + balcony) VARIANT 1

TOTAL SALEABLE AREA
 SUITE = 674.79 SQ.FT.
 BALCONY = 57.48 SQ.FT.
 TOTAL = 732.27 SQ.FT.

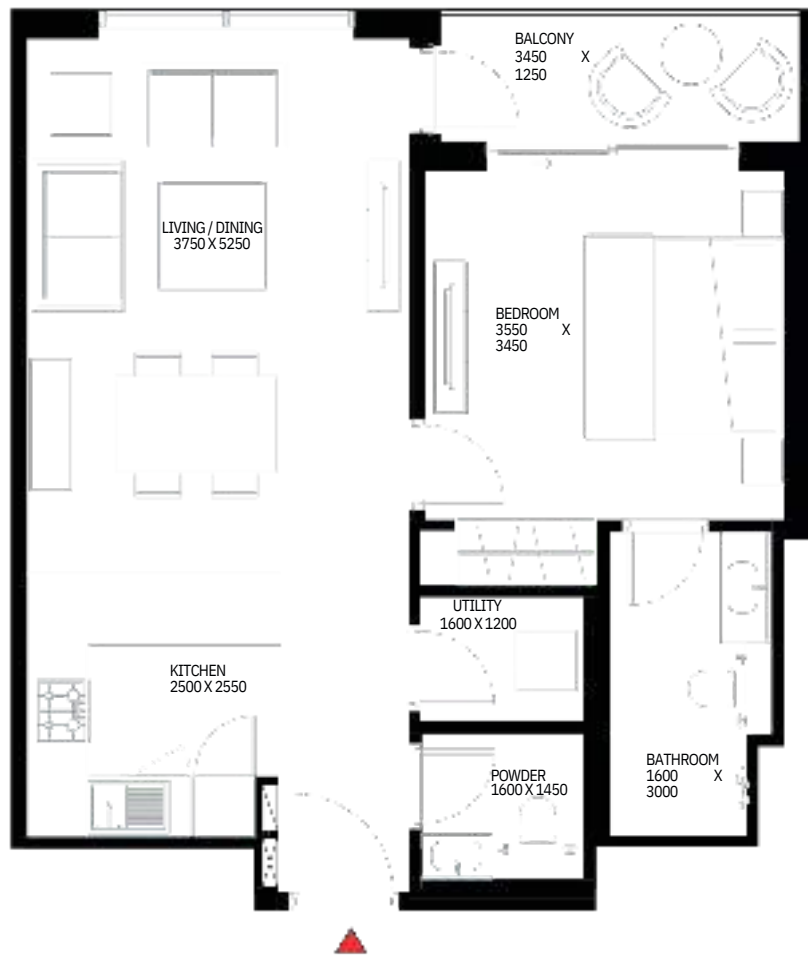
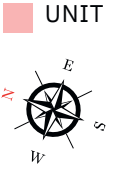
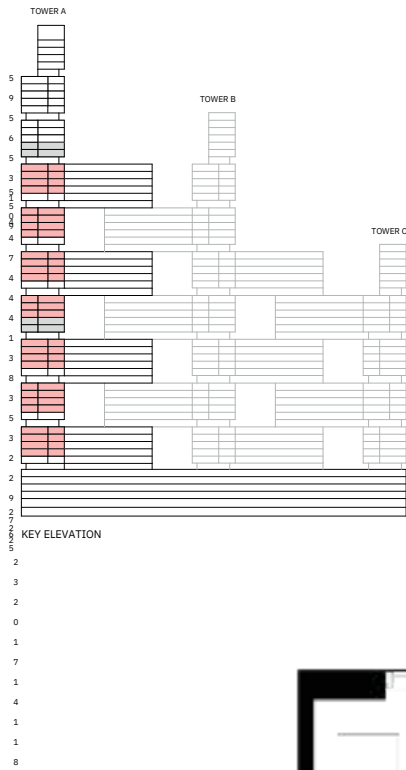

List of unit numbers with this unit plan:

VIEWS

Creek
 A803, A805, A903, A905, A1003, A1005, A1103, A1105, A1403, A1405, A1503, A1505, A1603, A1605, A1703, A1705, A2003, A2005, A2103, A2105, A2203, A2205, A2303, A2305, A2703, A2705, A2803, A2805, A2903, A2905, A3203, A3205, A3303, A3305, A3403, A3405, A3503, A3505, A3803, A3805, A3903, A3905, A4003, A4005,, A4103, A4105, A4403, A4405, A4503, A4505, A4603, A4605, A4703, A4705

Disclaimer: 1. All dimensions are in metric, measured to wall finishes. 2. All materials, dimensions & drawings are approximate. 3. Information is subject to change without notice, at developer's absolute discretion. 4. Actual area may vary from the stated area. 5. Drawing are not to scale. 6. All images used are for illustrative purpose only and do not represent the actual size, features, specifications, fittings and furnishings. 7. The developer reserves the right to make revisions/ alterations, at its absolute discretion, without any liability whatsoever.

1 BEDROOM APARTMENT

TYPE A (with powder room + balcony) VARIANT 1

TOTAL SALEABLE AREA
 SUITE = 674.79 SQ.FT.
 BALCONY = 57.48 SQ.FT.
 TOTAL = 732.27 SQ.FT.

UNIT

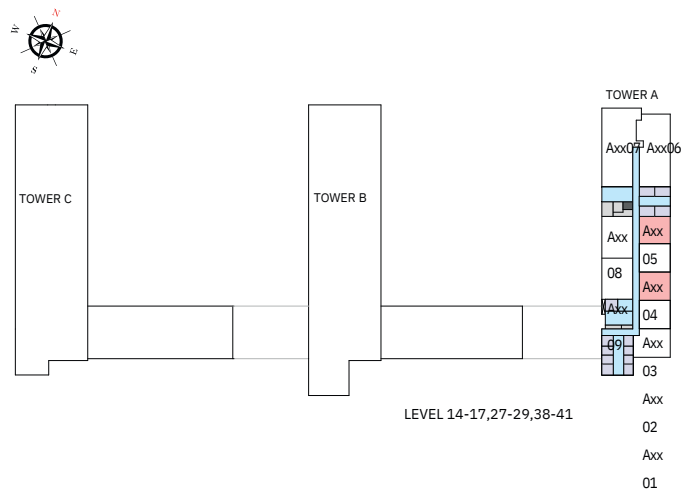
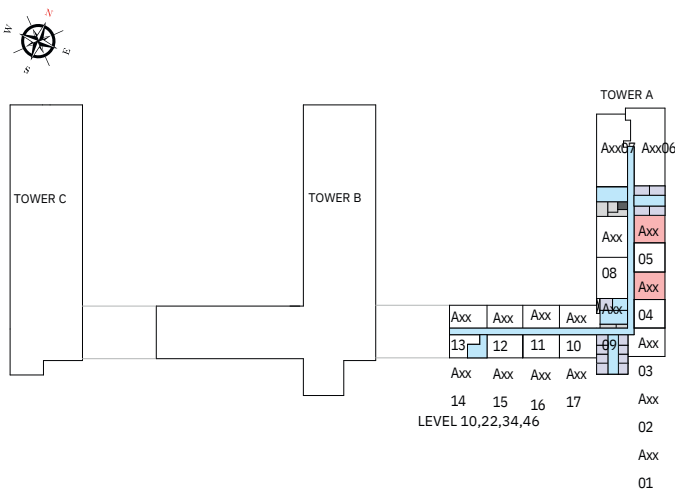
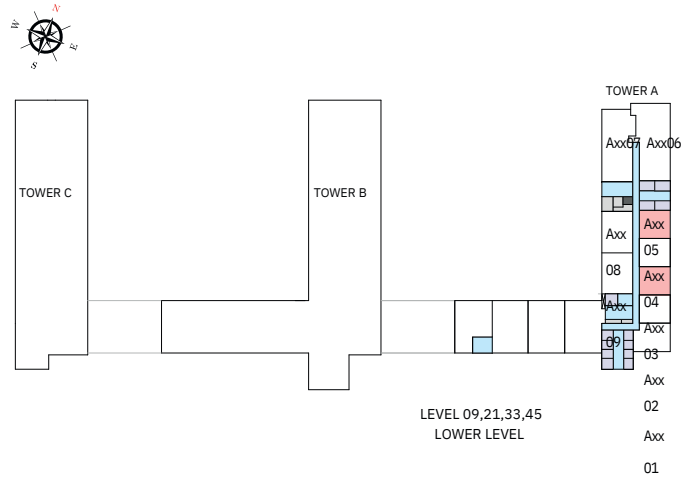
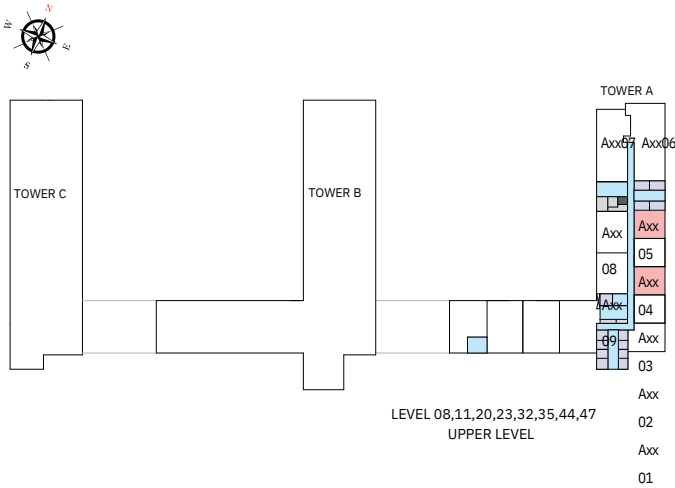

List of unit numbers with this unit plan:

VIEWS

Creek
 A803, A805, A903, A905, A1003, A1005, A1103, A1105, A1403, A1405, A1503, A1505, A1603, A1605, A1703, A1705, A2003, A2005, A2103, A2105, A2203, A2205, A2303, A2305, A2703, A2705, A2803, A2805, A2903, A2905, A3203, A3205, A3303, A3305, A3403, A3405, A3503, A3505, A3803, A3805, A3903, A3905, A4003, A4005, A4103, A4105, A4403, A4405, A4503, A4505, A4603, A4605, A4703, A4705

Disclaimer: 1. All dimensions are in metric, measured to wall finishes. 2. All materials, dimensions & drawings are approximate. 3. Information is subject to change without notice, at developer's absolute discretion. 4. Actual area may vary from the stated area. 5. Drawing are not to scale. 6. All images used are for illustrative purpose only and do not represent the actual size, features, specifications, fittings and furnishings. 7. The developer reserves the right to make revisions/ alterations, at its absolute discretion, without any liability whatsoever.

1 BEDROOM APARTMENT

TYPE B (with powder room + yard)

TOTAL SALEABLE AREA
 SUITE = 675.11 SQ.FT.
 YARD = 132.72 SQ.FT.
 TOTAL = 807.83 SQ.FT.

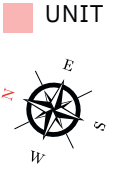
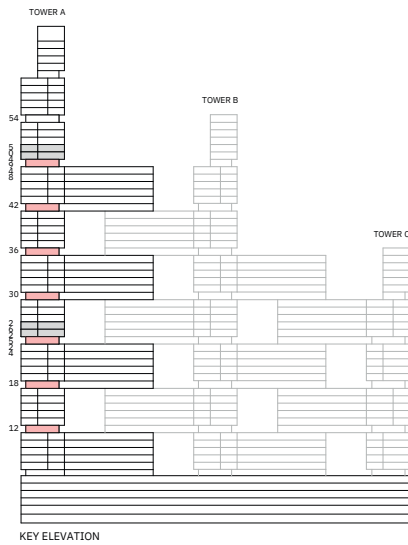

List of unit numbers with this unit plan:

VIEWS

Creek
 A1202, A1204, A1802, A1804, A2402, A2404, A3002, A3004, A3602, A3604, A4202, A4204, A4802, A4804

Disclaimer: 1. All dimensions are in metric, measured to wall finishes. 2. All materials, dimensions & drawings are approximate. 3. Information is subject to change without notice, at developer's absolute discretion. 4. Actual area may vary from the stated area. 5. Drawing are not to scale. 6. All images used are for illustrative purpose only and do not represent the actual size, features, specifications, fittings and furnishings. 7. The developer reserves the right to make revisions/ alterations, at its absolute discretion, without any liability whatsoever.

1 BEDROOM APARTMENT

TYPE B (with powder room + yard)

TOTAL SALEABLE AREA
 SUITE = 675.11 SQ.FT.
 YARD = 132.72 SQ.FT.
 TOTAL = 807.83 SQ.FT.

■ UNIT

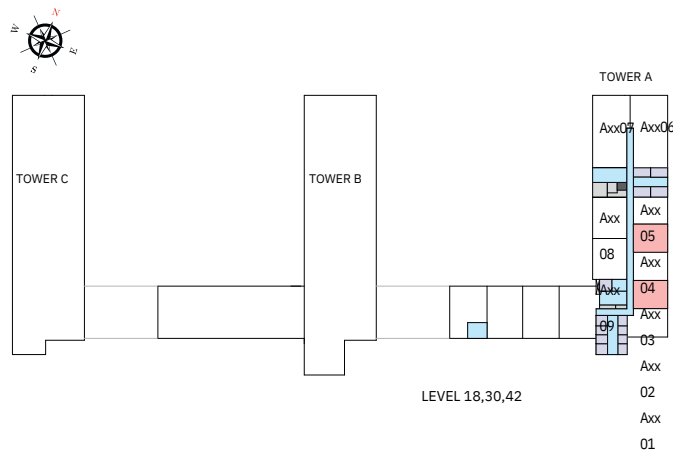
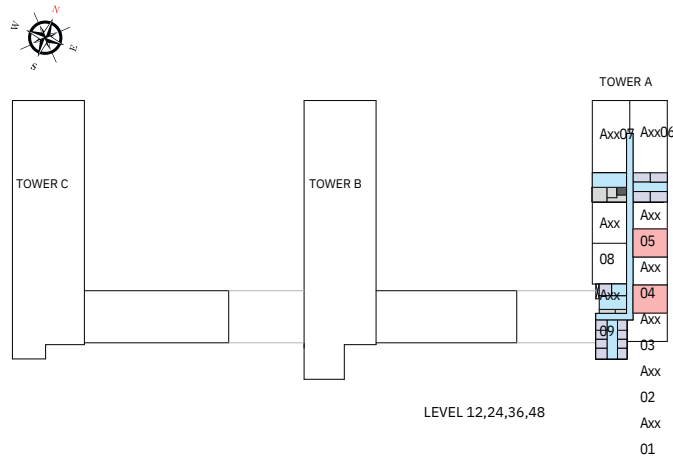

List of unit numbers with this unit plan:

VIEWS

Creek
 A1202, A1204, A1802, A1804, A2402, A2404, A3002, A3004, A3602, A3604, A4202, A4204, A4802, A4804

Disclaimer: 1. All dimensions are in metric, measured to wall finishes. 2. All materials, dimensions & drawings are approximate. 3. Information is subject to change without notice, at developer's absolute discretion. 4. Actual area may vary from the stated area. 5. Drawing are not to scale. 6. All images used are for illustrative purpose only and do not represent the actual size, features, specifications, fittings and furnishings. 7. The developer reserves the right to make revisions/ alterations, at its absolute discretion, without any liability whatsoever.

1 BEDROOM APARTMENT

TYPE B (with powder room + yard) VARIANT 1

TOTAL SALEABLE AREA
 SUITE = 675.11 SQ.FT.
 YARD = 132.72 SQ.FT.
 TOTAL = 807.83 SQ.FT.

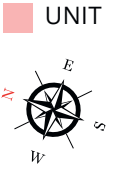
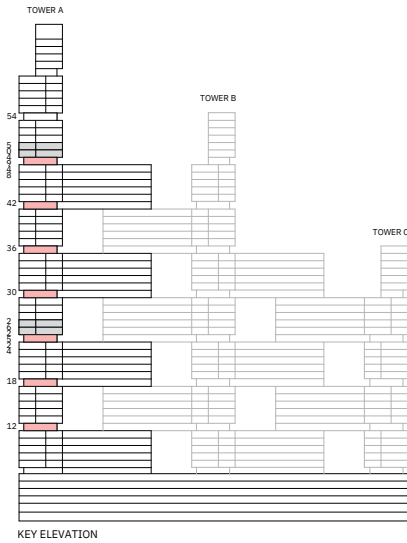

List of unit numbers with this unit plan:

VIEWS

Creek
 A1203, A1205, A1803, A1805, A2403, A2405, A3003, A3005, A3603, A3605, A4203, A4205, A4803, A4805

Disclaimer: 1. All dimensions are in metric, measured to wall finishes. 2. All materials, dimensions & drawings are approximate. 3. Information is subject to change without notice, at developer's absolute discretion. 4. Actual area may vary from the stated area. 5. Drawing are not to scale. 6. All images used are for illustrative purpose only and do not represent the actual size, features, specifications, fittings and furnishings. 7. The developer reserves the right to make revisions/ alterations, at its absolute discretion, without any liability whatsoever.

1 BEDROOM APARTMENT

TYPE B (with powder room + yard) VARIANT 1

TOTAL SALEABLE AREA
 SUITE = 675.11 SQ.FT.
 YARD = 132.72 SQ.FT.
 TOTAL = 807.83 SQ.FT.

■ UNIT

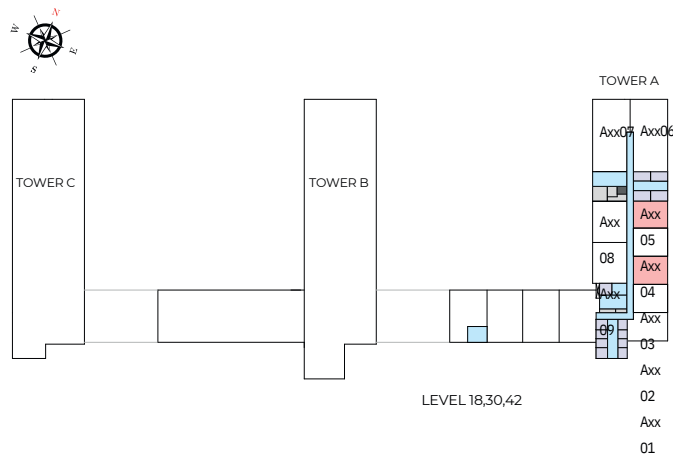
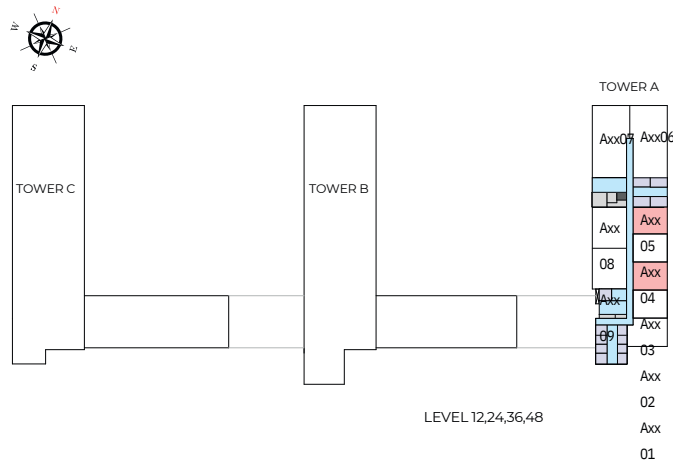

List of unit numbers with this unit plan:

VIEWS

Creek

A1203, A1205, A1803, A1805, A2403, A2405, A3003, A3005, A3603, A3605, A4203, A4205, A4803, A4805

Disclaimer: 1. All dimensions are in metric, measured to wall finishes. 2. All materials, dimensions & drawings are approximate. 3. Information is subject to change without notice, at developer's absolute discretion. 4. Actual area may vary from the stated area. 5. Drawing are not to scale. 6. All images used are for illustrative purpose only and do not represent the actual size, features, specifications, fittings and furnishings. 7. The developer reserves the right to make revisions/ alterations, at its absolute discretion, without any liability whatsoever.

1 BEDROOM APARTMENT

TYPE C (with powder room + yard)

TOTAL SALEABLE AREA
 SUITE = 674.79 SQ.FT.
 YARD = 133.04 SQ.FT.
 TOTAL = 807.83 SQ.FT.

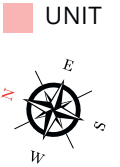
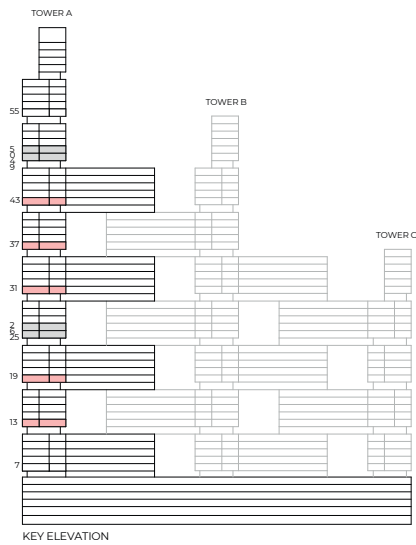

List of unit numbers with this unit plan:

VIEWS

Creek
 A1302, A1304, A1902, A1904, A3102, A3104, A3702, A3704, A4302, A4304

Disclaimer: 1. All dimensions are in metric, measured to wall finishes. 2. All materials, dimensions & drawings are approximate. 3. Information is subject to change without notice, at developer's absolute discretion. 4. Actual area may vary from the stated area. 5. Drawing are not to scale. 6. All images used are for illustrative purpose only and do not represent the actual size, features, specifications, fittings and furnishings. 7. The developer reserves the right to make revisions/ alterations, at its absolute discretion, without any liability whatsoever.

1 BEDROOM APARTMENT

TYPE C (with powder room + yard)

TOTAL SALEABLE AREA
 SUITE = 674.79 SQ.FT.
 YARD = 133.04 SQ.FT.
 TOTAL = 807.83 SQ.FT.

■ UNIT

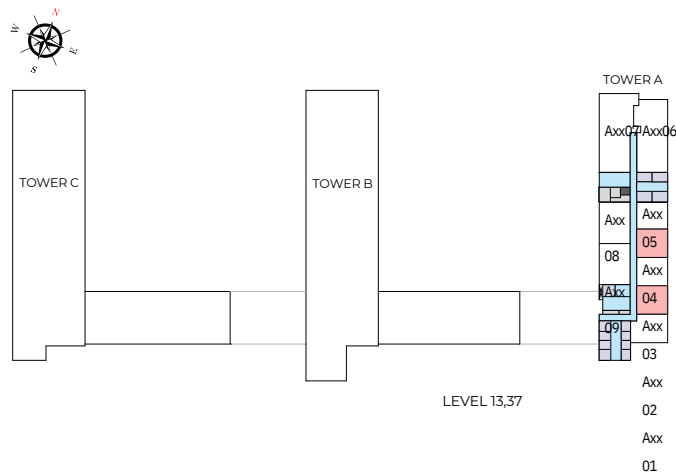
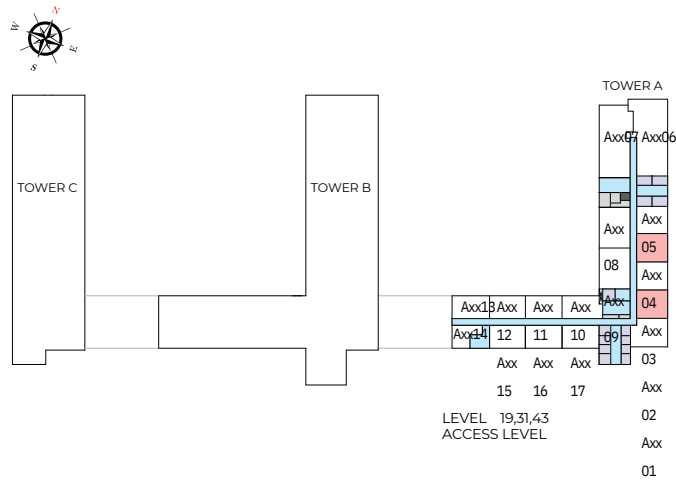

List of unit numbers with this unit plan:

VIEWS

Creek
 A1302, A1304, A1902, A1904, A3102, A3104, A3702, A3704, A4302, A4304

Disclaimer: 1. All dimensions are in metric, measured to wall finishes. 2. All materials, dimensions & drawings are approximate. 3. Information is subject to change without notice, at developer's absolute discretion. 4. Actual area may vary from the stated area. 5. Drawing are not to scale. 6. All images used are for illustrative purpose only and do not represent the actual size, features, specifications, fittings and furnishings. 7. The developer reserves the right to make revisions/ alterations, at its absolute discretion, without any liability whatsoever.

1 BEDROOM APARTMENT

TYPE C (with powder room + yard) VARIANT 1

TOTAL SALEABLE AREA
 SUITE = 674.79 SQ.FT.
 YARD = 133.04 SQ.FT.
 TOTAL = 807.83 SQ.FT.

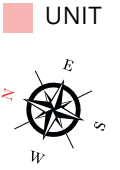
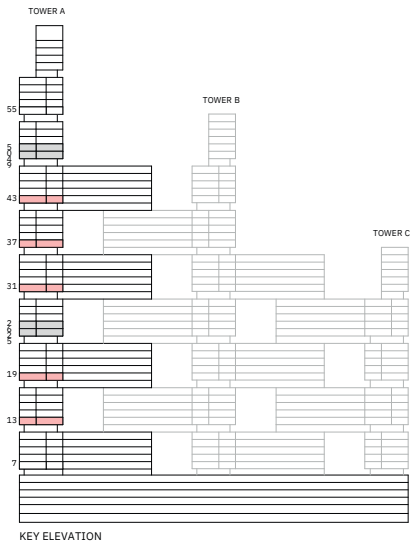

List of unit numbers with this unit plan:

VIEWS

Creek
 A1303, A1305, A1903, A1905, A3103, A3105, A3703, A3705, A4303, A4305

Disclaimer: 1. All dimensions are in metric, measured to wall finishes. 2. All materials, dimensions & drawings are approximate. 3. Information is subject to change without notice, at developer's absolute discretion. 4. Actual area may vary from the stated area. 5. Drawing are not to scale. 6. All images used are for illustrative purpose only and do not represent the actual size, features, specifications, fittings and furnishings. 7. The developer reserves the right to make revisions/ alterations, at its absolute discretion, without any liability whatsoever.

1 BEDROOM APARTMENT

TYPE C (with powder room + yard) VARIANT 1

TOTAL SALEABLE AREA
 SUITE = 674.79 SQ.FT.
 YARD = 133.04 SQ.FT.
 TOTAL = 807.83 SQ.FT.

■ UNIT

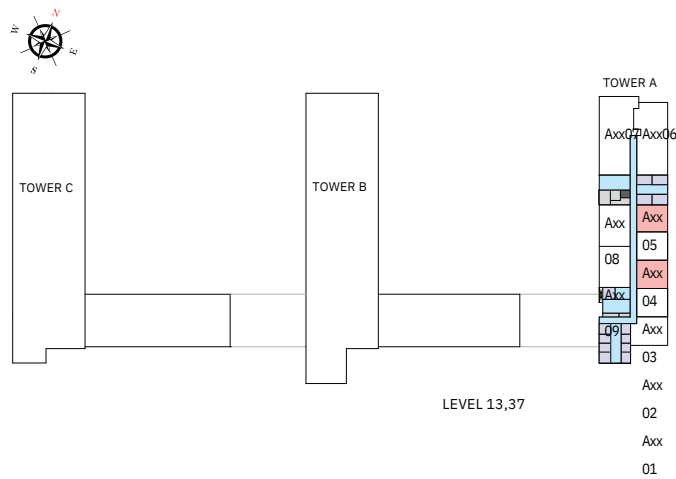
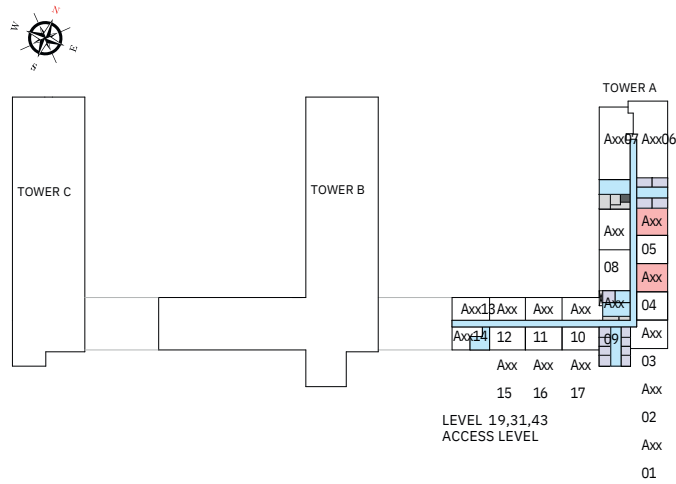

List of unit numbers with this unit plan:

VIEWS

Creek
 A1303, A1305, A1903, A1905, A3103, A3105, A3703, A3705, A4303, A4305

Disclaimer: 1. All dimensions are in metric, measured to wall finishes. 2. All materials, dimensions & drawings are approximate. 3. Information is subject to change without notice, at developer's absolute discretion. 4. Actual area may vary from the stated area. 5. Drawing are not to scale. 6. All images used are for illustrative purpose only and do not represent the actual size, features, specifications, fittings and furnishings. 7. The developer reserves the right to make revisions/ alterations, at its absolute discretion, without any liability whatsoever.

2 BEDROOM APARTMENT

TYPE A (with powder room + balcony)

TOTAL SALEABLE AREA
 SUITE = 1,034.63 SQ.FT.
 BALCONY = 64.69 SQ.FT.
 TOTAL = 1,099.32 SQ.FT.

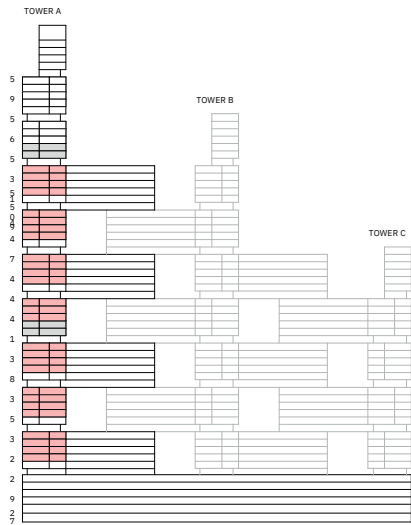

List of unit numbers with this unit plan:

VIEWS

Ras Al Khor, Amenities
 A809, A909

Ras Al Khor, Golf Course, Amenities
 A1009, A1109, A1409, A1509, A1609, A1709, A2009, A2109, A2209, A2309

Ras Al Khor, Golf Course
 A2709, A2809, A2909, A3209, A3309, A3409, A3509, A3809, A3909, A4009, A4109, A4409, A4509, A4609, A4709

Disclaimer: 1. All dimensions are in metric, measured to wall finishes. 2. All materials, dimensions & drawings are approximate. 3. Information is subject to change without notice, at developer's absolute discretion. 4. Actual area may vary from the stated area. 5. Drawing are not to scale. 6. All images used are for illustrative purpose only and do not represent the actual size, features, specifications, fittings and furnishings. 7. The developer reserves the right to make revisions/ alterations, at its absolute discretion, without any liability whatsoever.

2 BEDROOM APARTMENT

TYPE A (with powder room + balcony)

TOTAL SALEABLE AREA
 SUITE = 1,034.63 SQ.FT.
 BALCONY = 64.69 SQ.FT.
 TOTAL = 1,099.32 SQ.FT.

■ UNIT

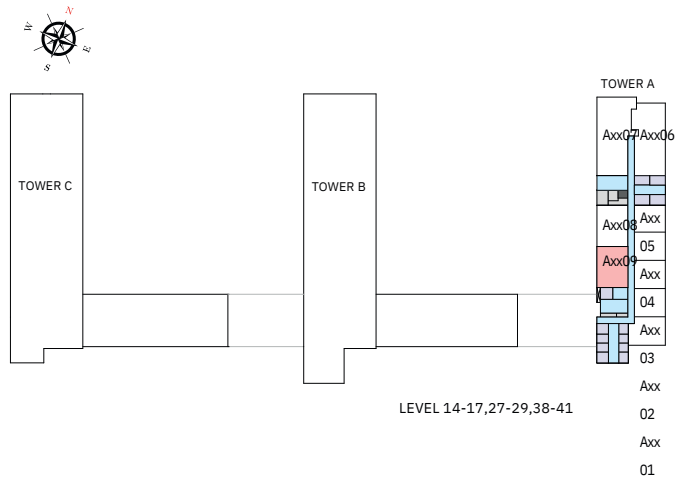
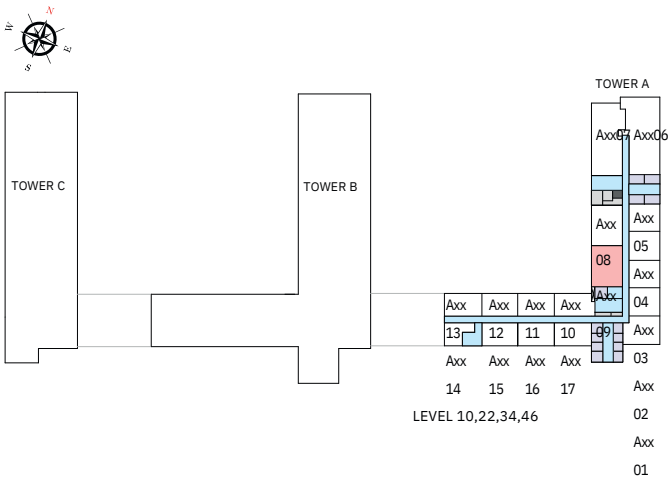
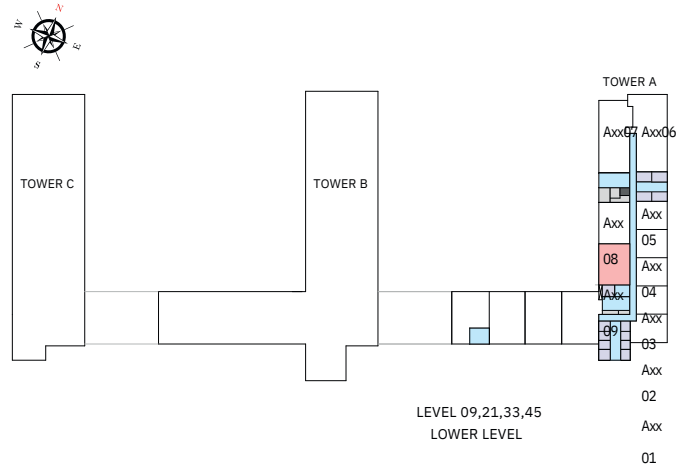
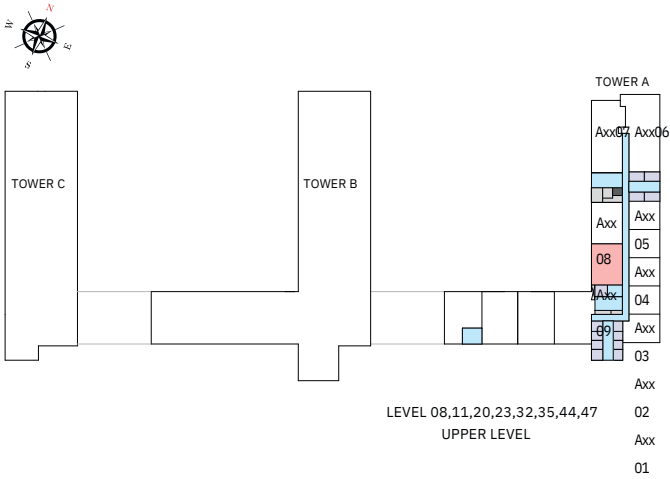

List of unit numbers with this unit plan:

VIEWS

Ras Al Khor, Amenities
 A809, A909

Ras Al Khor, Golf Course, Amenities
 A1009, A1109, A1409, A1509, A1609, A1709, A2009, A2109, A2209, A2309

Ras Al Khor, Golf Course
 A2709, A2809, A2909, A3209, A3309, A3409, A3509, A3809, A3909, A4009, A4109, A4409, A4509, A4609, A4709

Disclaimer: 1. All dimensions are in metric, measured to wall finishes. 2. All materials, dimensions & drawings are approximate. 3. Information is subject to change without notice, at developer's absolute discretion. 4. Actual area may vary from the stated area. 5. Drawing are not to scale. 6. All images used are for illustrative purpose only and do not represent the actual size, features, specifications, fittings and furnishings. 7. The developer reserves the right to make revisions/ alterations, at its absolute discretion, without any liability whatsoever.

2 BEDROOM APARTMENT

TYPE A (with powder room + balcony) VARIANT 1

TOTAL SALEABLE AREA
 SUITE = 1,034.63 SQ.FT.
 BALCONY = 64.69 SQ.FT.
 TOTAL = 1,099.32 SQ.FT.

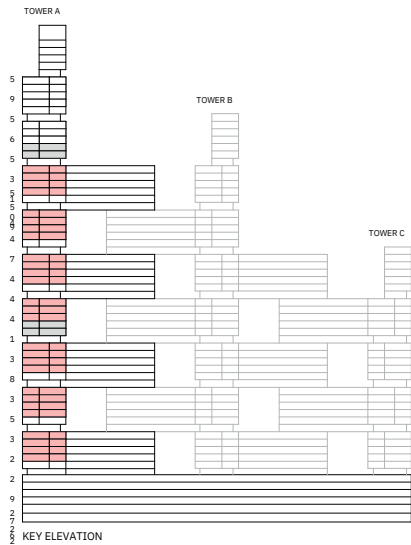

List of unit numbers with this unit plan:

VIEWS

Ras Al Khor, Amenities
 A808, A908

Ras Al Khor, Golf Course, Amenities
 A1008, A1108, A1408, A1508, A1608, A1708, A2008, A2108, A2208, A2308

Ras Al Khor, Golf Course
 A2708, A2808, A2908, A3208, A3308, A3408, A3508, A3808, A3908, A4008, A4108, A4408, A4508, A4608, A4708

Disclaimer: 1. All dimensions are in metric, measured to wall finishes. 2. All materials, dimensions & drawings are approximate. 3. Information is subject to change without notice, at developer's absolute discretion. 4. Actual area may vary from the stated area. 5. Drawing are not to scale. 6. All images used are for illustrative purpose only and do not represent the actual size, features, specifications, fittings and furnishings. 7. The developer reserves the right to make revisions/ alterations, at its absolute discretion, without any liability whatsoever.

2 BEDROOM APARTMENT

TYPE A (with powder room + balcony) VARIANT 1

TOTAL SALEABLE AREA
 SUITE = 1,034.63 SQ.FT.
 BALCONY = 64.69 SQ.FT.
 TOTAL = 1,099.32 SQ.FT.

■ UNIT

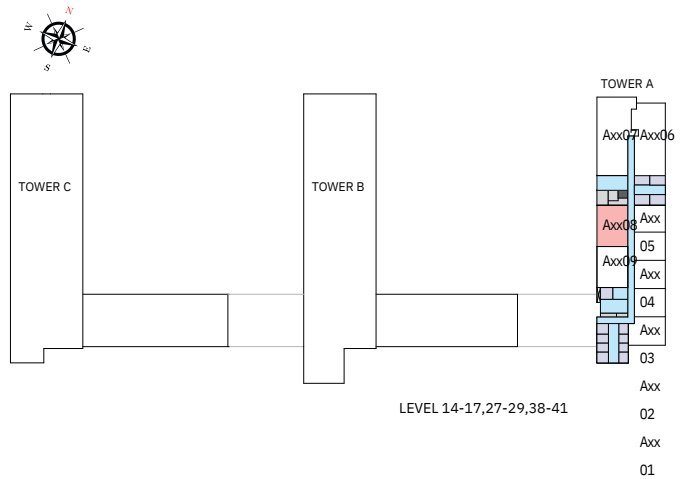
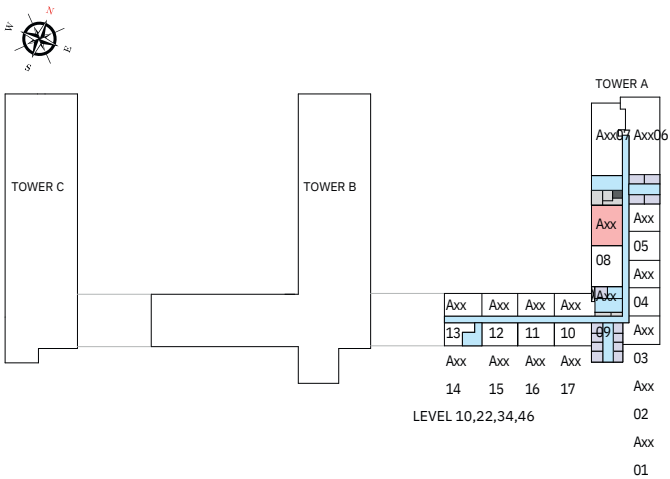
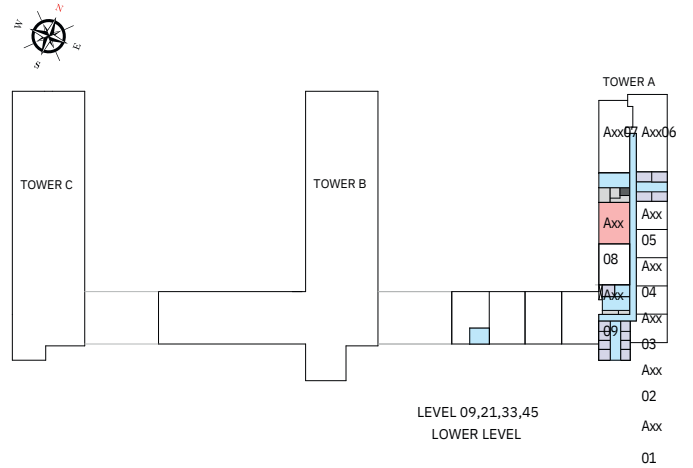
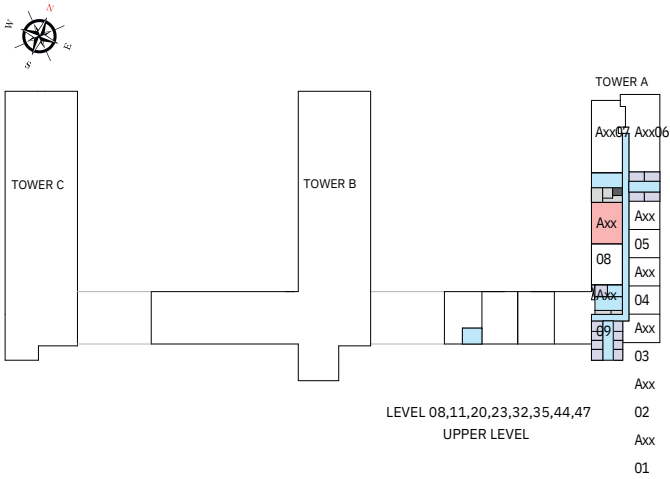

List of unit numbers with this unit plan:

VIEWS

Ras Al Khor, Amenities
 A808, A908

Ras Al Khor, Golf Course, Amenities
 A1008, A1108, A1408, A1508, A1608, A1708, A2008, A2108, A2208, A2308

Ras Al Khor, Golf Course
 A2708, A2808, A2908, A3208, A3308, A3408, A3508, A3808, A3908, A4008, A4108, A4408, A4508, A4608, A4708

Disclaimer: 1. All dimensions are in metric, measured to wall finishes. 2. All materials, dimensions & drawings are approximate. 3. Information is subject to change without notice, at developer's absolute discretion. 4. Actual area may vary from the stated area. 5. Drawing are not to scale. 6. All images used are for illustrative purpose only and do not represent the actual size, features, specifications, fittings and furnishings. 7. The developer reserves the right to make revisions/ alterations, at its absolute discretion, without any liability whatsoever.

2 BEDROOM APARTMENT

TYPE G (with powder room + yard)

TOTAL SALEABLE AREA

SUITE = 1,025.05 SQ.FT.

YARD = 184.82 SQ.FT.

TOTAL = 1,209.87 SQ.FT.

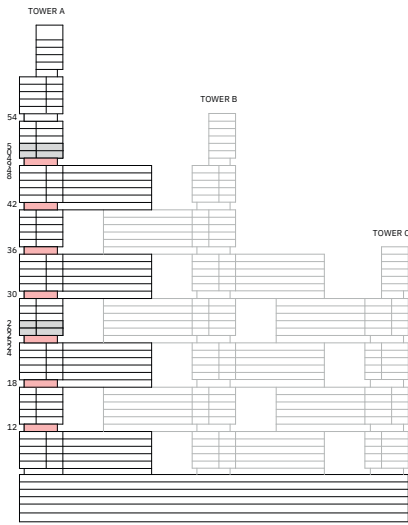

KEY ELEVATION



List of unit numbers with this unit plan:

VIEWS

Ras Al Khor, Golf Course, Amenities
A1209, A1809, A2409

Ras Al Khor, Golf Course
A3009, A3609, A4209, A4809

Disclaimer: 1. All dimensions are in metric, measured to wall finishes. 2. All materials, dimensions & drawings are approximate. 3. Information is subject to change without notice, at developer's absolute discretion. 4. Actual area may vary from the stated area. 5. Drawing are not to scale. 6. All images used are for illustrative purpose only and do not represent the actual size, features, specifications, fittings and furnishings. 7. The developer reserves the right to make revisions/ alterations, at its absolute discretion, without any liability whatsoever.

2 BEDROOM APARTMENT

TYPE G (with powder room + yard)

TOTAL SALEABLE AREA
 SUITE = 1,025.05 SQ.FT.
 YARD = 184.82 SQ.FT.
 TOTAL = 1,209.87 SQ.FT.

■ UNIT

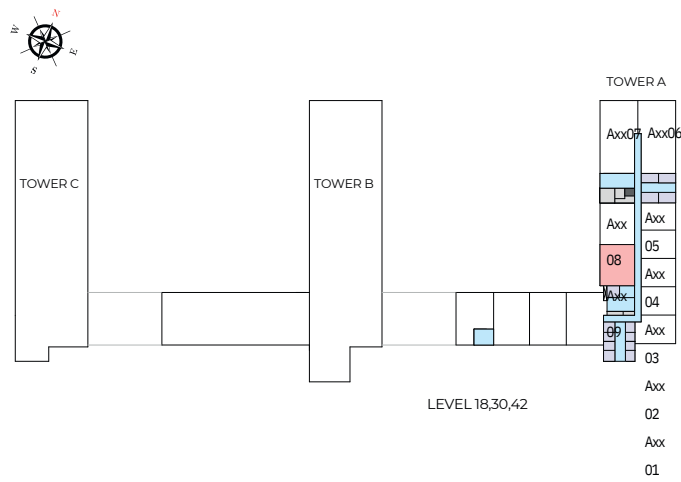
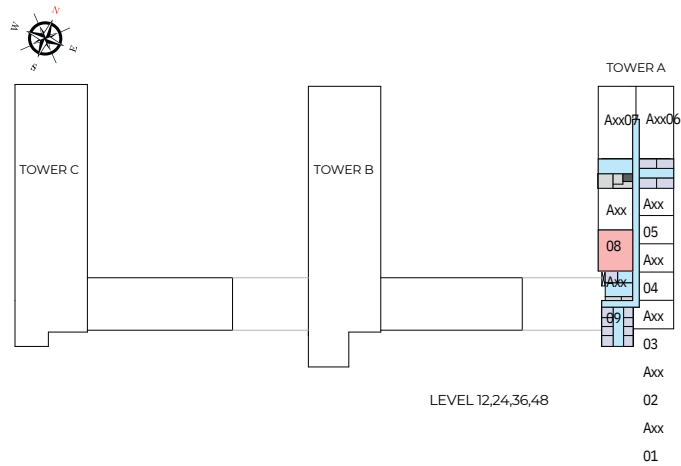

List of unit numbers with this unit plan:

VIEWS

Ras Al Khor, Golf Course, Amenities
 A1209, A1809, A2409

Ras Al Khor, Golf Course
 A3009, A3609, A4209, A4809

Disclaimer: 1. All dimensions are in metric, measured to wall finishes. 2. All materials, dimensions & drawings are approximate. 3. Information is subject to change without notice, at developer's absolute discretion. 4. Actual area may vary from the stated area. 5. Drawing are not to scale. 6. All images used are for illustrative purpose only and do not represent the actual size, features, specifications, fittings and furnishings. 7. The developer reserves the right to make revisions/ alterations, at its absolute discretion, without any liability whatsoever.

2 BEDROOM APARTMENT

TYPE G (with powder room + yard) VARIANT 1

TOTAL SALEABLE AREA

SUITE = 1,025.05 SQ.FT.

YARD = 184.82 SQ.FT.

TOTAL = 1,209.87 SQ.FT.

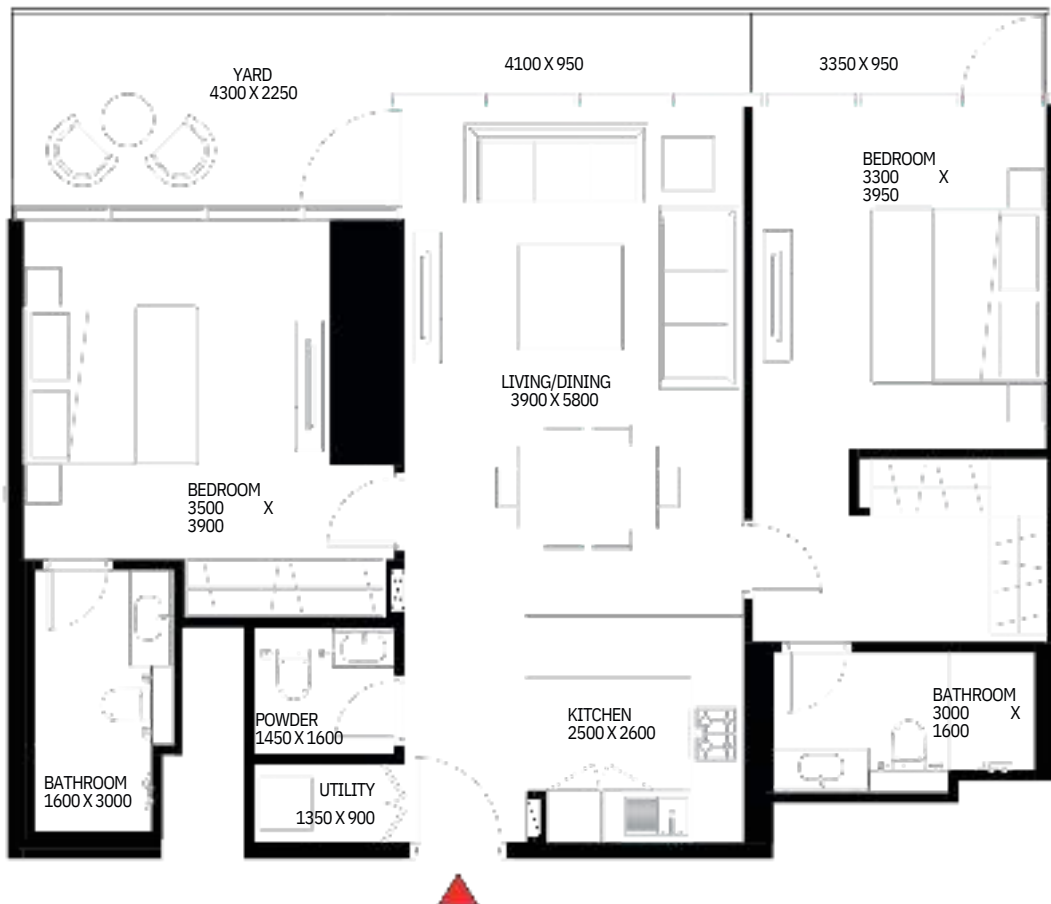
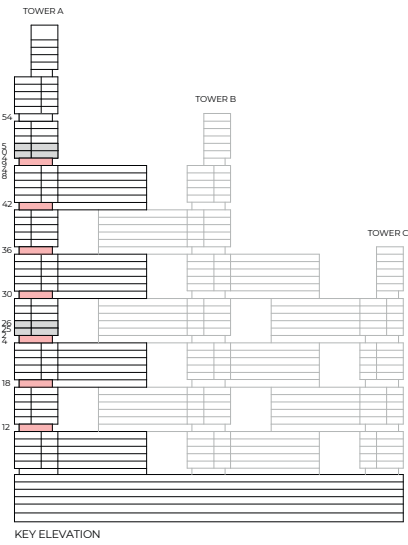

List of unit numbers with this unit plan:

VIEWS

Ras Al Khor, Golf Course, Amenities
A1208, A1808, A2408

Ras Al Khor, Golf Course
A3008, A3608, A4208, A4808

Disclaimer: 1. All dimensions are in metric, measured to wall finishes. 2. All materials, dimensions & drawings are approximate. 3. Information is subject to change without notice, at developer's absolute discretion. 4. Actual area may vary from the stated area. 5. Drawing are not to scale. 6. All images used are for illustrative purpose only and do not represent the actual size, features, specifications, fittings and furnishings. 7. The developer reserves the right to make revisions/ alterations, at its absolute discretion, without any liability whatsoever.

2 BEDROOM APARTMENT

TYPE G (with powder room + yard) VARIANT 1

TOTAL SALEABLE AREA
 SUITE = 1,025.05 SQ.FT.
 YARD = 184.82 SQ.FT.
 TOTAL = 1,209.87 SQ.FT.

■ UNIT

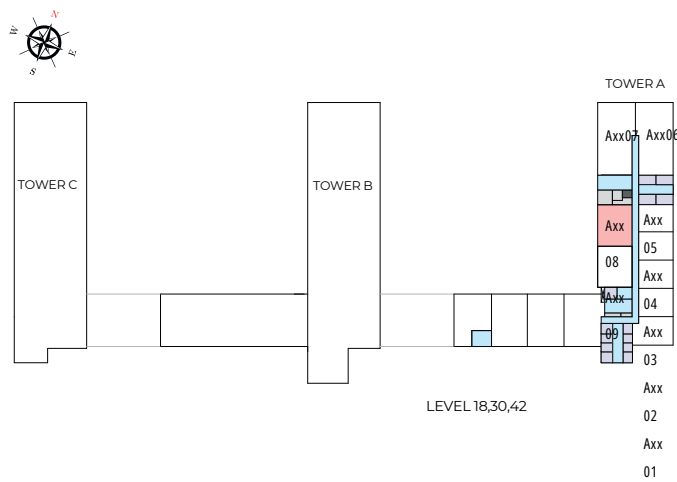
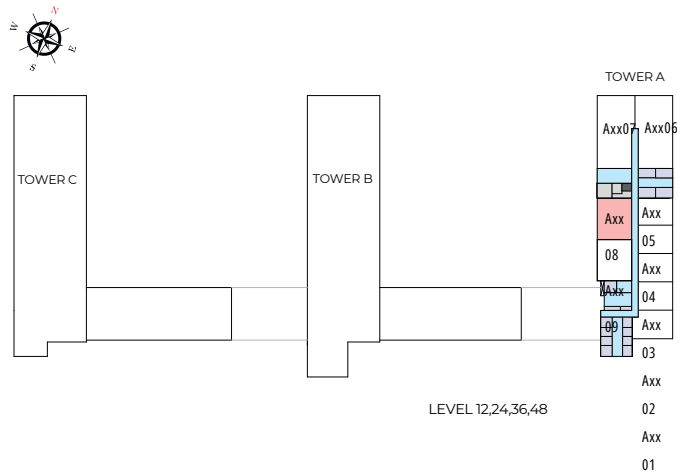

List of unit numbers with this unit plan:

VIEWS

Ras Al Khor, Golf Course, Amenities
 A1208, A1808, A2408

Ras Al Khor, Golf Course
 A3008, A3608, A4208, A4808

Disclaimer: 1. All dimensions are in metric, measured to wall finishes. 2. All materials, dimensions & drawings are approximate. 3. Information is subject to change without notice, at developer's absolute discretion. 4. Actual area may vary from the stated area. 5. Drawing are not to scale. 6. All images used are for illustrative purpose only and do not represent the actual size, features, specifications, fittings and furnishings. 7. The developer reserves the right to make revisions/ alterations, at its absolute discretion, without any liability whatsoever.

2 BEDROOM APARTMENT

TYPE P (with powder room + yard)

TOTAL SALEABLE AREA
 SUITE = 1,034.61 SQ.FT.
 YARD = 178.41 SQ.FT.
 TOTAL = 1,213.02 SQ.FT.

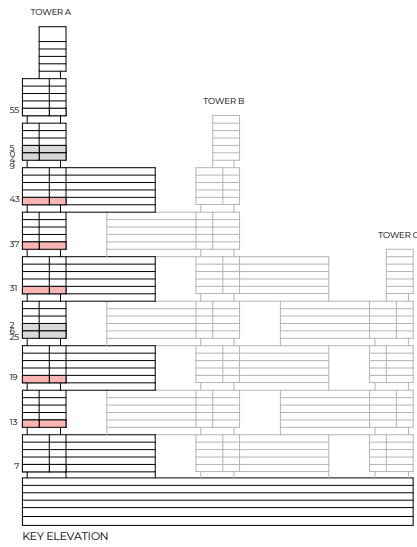

List of unit numbers with this unit plan:

VIEWS

Ras Al Khor, Golf Course, Amenities
 A1309, A1909

Ras Al Khor, Golf Course
 A3109, A3709, A4309

Disclaimer: 1. All dimensions are in metric, measured to wall finishes. 2. All materials, dimensions & drawings are approximate. 3. Information is subject to change without notice, at developer's absolute discretion. 4. Actual area may vary from the stated area. 5. Drawing are not to scale. 6. All images used are for illustrative purpose only and do not represent the actual size, features, specifications, fittings and furnishings. 7. The developer reserves the right to make revisions/ alterations, at its absolute discretion, without any liability whatsoever.

2 BEDROOM APARTMENT

TYPE P (with powder room + yard)

TOTAL SALEABLE AREA
 SUITE = 1,034.61 SQ.FT.
 YARD = 178.41 SQ.FT.
 TOTAL = 1,213.02 SQ.FT.

■ UNIT

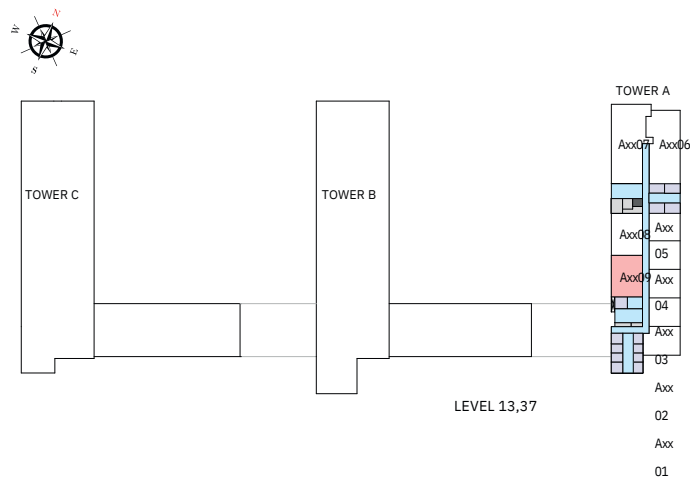
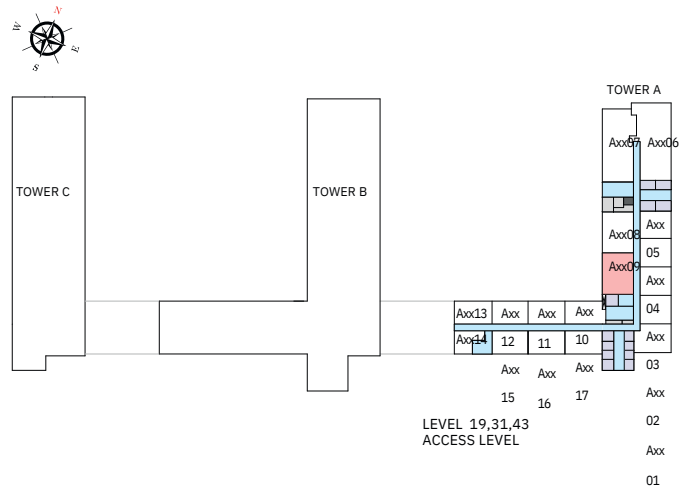

List of unit numbers with this unit plan:

VIEWS

Ras Al Khor, Golf Course, Amenities
 A1309, A1909

Ras Al Khor, Golf Course
 A3109, A3709, A4309

Disclaimer: 1. All dimensions are in metric, measured to wall finishes. 2. All materials, dimensions & drawings are approximate. 3. Information is subject to change without notice, at developer's absolute discretion. 4. Actual area may vary from the stated area. 5. Drawing are not to scale. 6. All images used are for illustrative purpose only and do not represent the actual size, features, specifications, fittings and furnishings. 7. The developer reserves the right to make revisions/ alterations, at its absolute discretion, without any liability whatsoever.

2 BEDROOM APARTMENT

TYPE P (with powder room + yard) VARIANT 1

TOTAL SALEABLE AREA

SUITE = 1,034.61 SQ.FT.

YARD = 178.41 SQ.FT.

TOTAL = 1,213.02 SQ.FT.

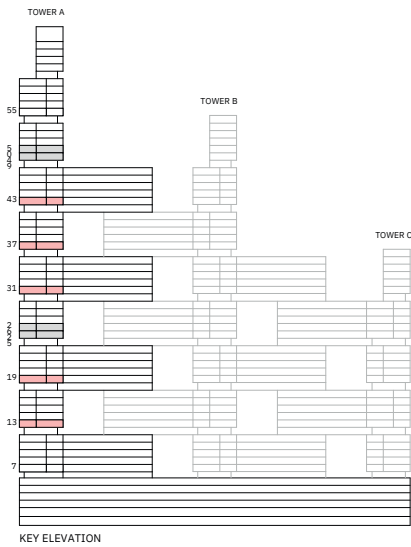

List of unit numbers with this unit plan:

VIEWS

Ras Al Khor, Golf Course, Amenities
A1308, A1908

Ras Al Khor, Golf Course
A3108, A3708, A4308

Disclaimer: 1. All dimensions are in metric, measured to wall finishes. 2. All materials, dimensions & drawings are approximate. 3. Information is subject to change without notice, at developer's absolute discretion. 4. Actual area may vary from the stated area. 5. Drawing are not to scale. 6. All images used are for illustrative purpose only and do not represent the actual size, features, specifications, fittings and furnishings. 7. The developer reserves the right to make revisions/ alterations, at its absolute discretion, without any liability whatsoever.

3 BEDROOM APARTMENT

TYPE A (with maid room + balcony)

TOTAL SALEABLE AREA
 SUITE = 1,642.57 SQ.FT.
 BALCONY = 274.54 SQ.FT.
 TOTAL = 1,917.11 SQ.FT.

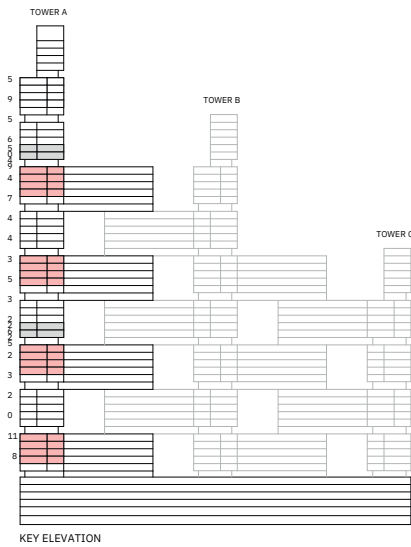

List of unit numbers with this unit plan:

VIEWS

Downtown, Ras Al Khor, Creek, Golf Course, water body, Amenities
 A807, A907, A1007, A1107, A2007, A2107, A2207, A2307

Downtown, Ras Al Khor, Creek, Golf Course, water body
 A3207, A3307, A3407, A3507, A4407, A4507, A4607, A4707

Disclaimer: 1. All dimensions are in metric, measured to wall finishes. 2. All materials, dimensions & drawings are approximate. 3. Information is subject to change without notice, at developer's absolute discretion. 4. Actual area may vary from the stated area. 5. Drawing are not to scale. 6. All images used are for illustrative purpose only and do not represent the actual size, features, specifications, fittings and furnishings. 7. The developer reserves the right to make revisions/ alterations, at its absolute discretion, without any liability whatsoever.

3 BEDROOM APARTMENT

TYPE A (with maid room + balcony)

TOTAL SALEABLE AREA
 SUITE = 1,642.57 SQ.FT.
 BALCONY = 274.54 SQ.FT.
 TOTAL = 1,917.11 SQ.FT.

UNIT

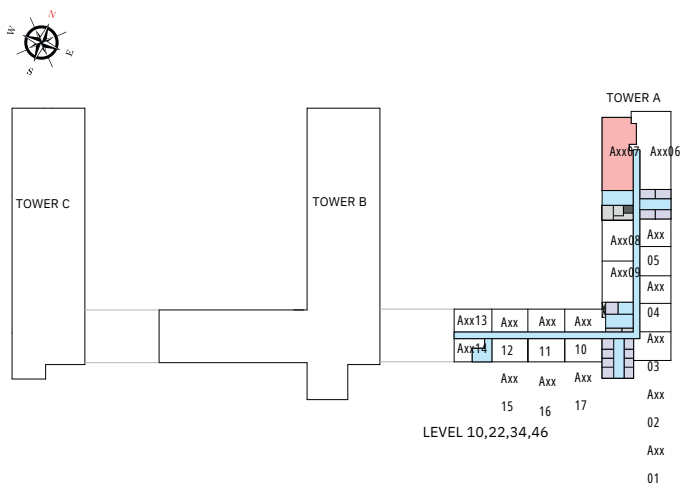
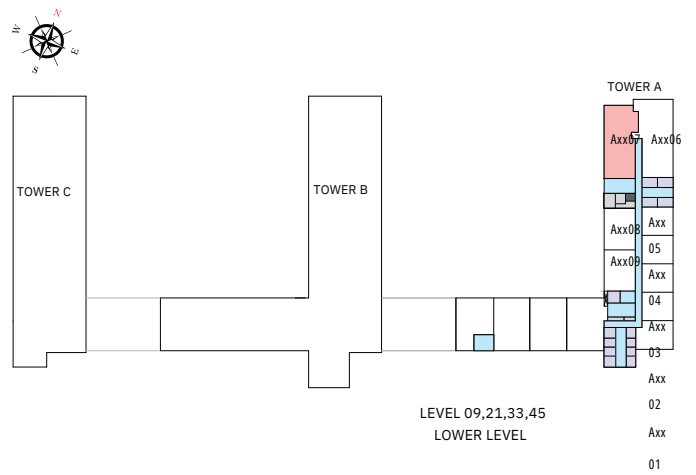
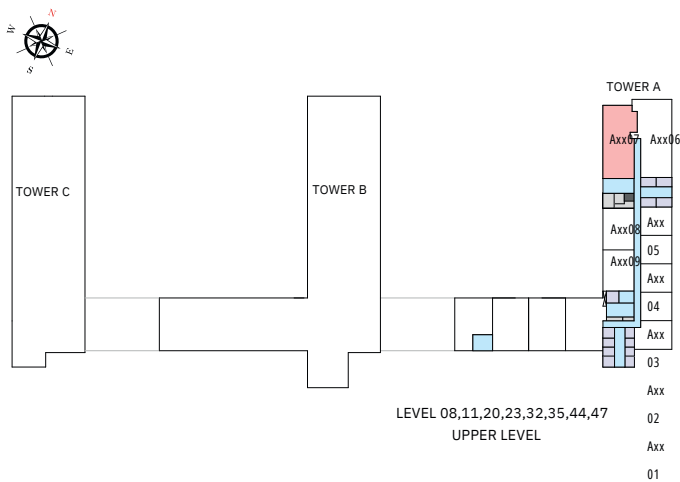

List of unit numbers with this unit plan:

VIEWS

Downtown, Ras Al Khor, Creek, Golf Course, water body, Amenities
 A807, A907, A1007, A1107, A2007, A2107, A2207, A2307

Downtown, Ras Al Khor, Creek, Golf Course, water body
 A3207, A3307, A3407, A3507, A4407, A4507, A4607, A4707

Disclaimer: 1. All dimensions are in metric, measured to wall finishes. 2. All materials, dimensions & drawings are approximate. 3. Information is subject to change without notice, at developer's absolute discretion. 4. Actual area may vary from the stated area. 5. Drawing are not to scale. 6. All images used are for illustrative purpose only and do not represent the actual size, features, specifications, fittings and furnishings. 7. The developer reserves the right to make revisions/ alterations, at its absolute discretion, without any liability whatsoever.

3 BEDROOM APARTMENT

TYPE A (with maid room + balcony) VARIANT 1

TOTAL SALEABLE AREA
 SUITE = 1,642.57 SQ.FT.
 BALCONY = 274.54 SQ.FT.
 TOTAL = 1,917.11 SQ.FT.

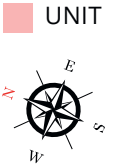
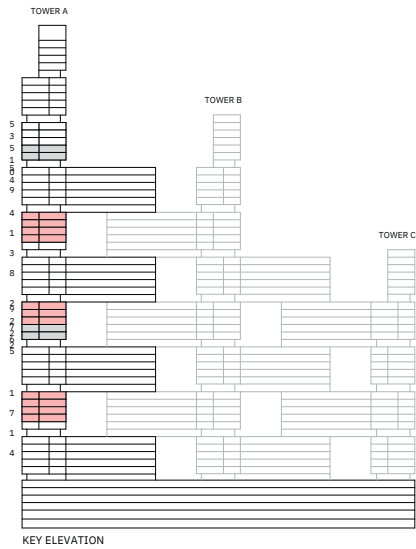

List of unit numbers with this unit plan:

VIEWS

Ras Al Khor, Creek, Golf Course
 A1406, A1506, A1606, A1706, A2706, A2806, A2906, A3806, A3906, A4006, A4106

Disclaimer: 1. All dimensions are in metric, measured to wall finishes. 2. All materials, dimensions & drawings are approximate. 3. Information is subject to change without notice, at developer's absolute discretion. 4. Actual area may vary from the stated area. 5. Drawing are not to scale. 6. All images used are for illustrative purpose only and do not represent the actual size, features, specifications, fittings and furnishings. 7. The developer reserves the right to make revisions/ alterations, at its absolute discretion, without any liability whatsoever.

3 BEDROOM APARTMENT

TYPE A (with maid room + balcony) VARIANT 1

TOTAL SALEABLE AREA
SUITE = 1,642.57 SQ.FT.
BALCONY = 274.54 SQ.FT.
TOTAL = 1,917.11 SQ.FT.

UNIT

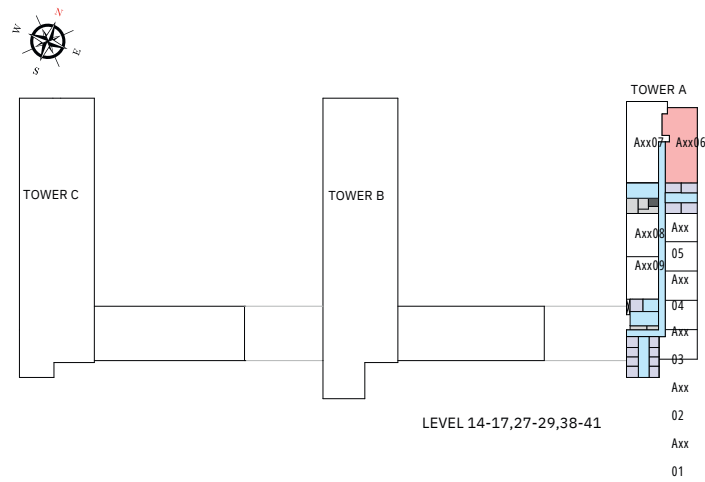

List of unit numbers with this unit plan:

VIEWS

Ras Al Khor, Creek, Golf Course
A1406, A1506, A1606, A1706, A2706, A2806, A2906, A3806, A3906, A4006, A4106

Disclaimer: 1. All dimensions are in metric, measured to wall finishes. 2. All materials, dimensions & drawings are approximate. 3. Information is subject to change without notice, at developer's absolute discretion. 4. Actual area may vary from the stated area. 5. Drawing are not to scale. 6. All images used are for illustrative purpose only and do not represent the actual size, features, specifications, fittings and furnishings. 7. The developer reserves the right to make revisions/ alterations, at its absolute discretion, without any liability whatsoever.

3 BEDROOM APARTMENT

TYPE C (with store room and maid room + yard)

TOTAL SALEABLE AREA
 SUITE = 1,708.66 SQ.FT.
 YARD = 782.88 SQ.FT.
 TOTAL = 2,491.54 SQ.FT.

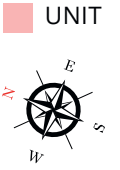
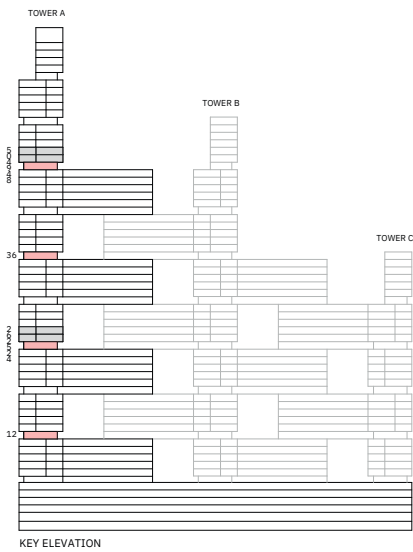

List of unit numbers with this unit plan:

VIEWS

Downtown, Ras Al Khor, Creek, Golf Course, Waterbody
 A1206, A2406, A3606, A4806

Disclaimer: 1. All dimensions are in metric, measured to wall finishes. 2. All materials, dimensions & drawings are approximate. 3. Information is subject to change without notice, at developer's absolute discretion. 4. Actual area may vary from the stated area. 5. Drawing are not to scale. 6. All images used are for illustrative purpose only and do not represent the actual size, features, specifications, fittings and furnishings. 7. The developer reserves the right to make revisions/ alterations, at its absolute discretion, without any liability whatsoever.

3 BEDROOM APARTMENT

TYPE C (with store room and maid room + yard)

TOTAL SALEABLE AREA
SUITE = 1,708.66 SQ.FT.
YARD = 782.88 SQ.FT.
TOTAL = 2,491.54 SQ.FT.

UNIT

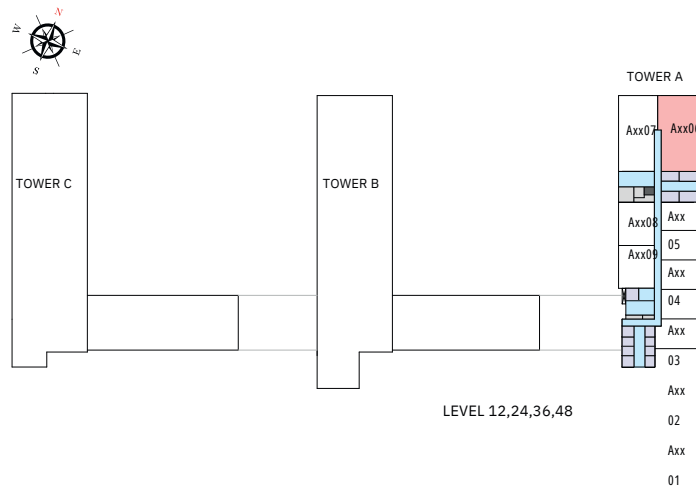

List of unit numbers with this unit plan:

VIEWS

Downtown, Ras Al Khor, Creek, Golf Course, Waterbody
A1206, A2406, A3606, A4806

Disclaimer: 1. All dimensions are in metric, measured to wall finishes. 2. All materials, dimensions & drawings are approximate. 3. Information is subject to change without notice, at developer's absolute discretion. 4. Actual area may vary from the stated area. 5. Drawing are not to scale. 6. All images used are for illustrative purpose only and do not represent the actual size, features, specifications, fittings and furnishings. 7. The developer reserves the right to make revisions/ alterations, at its absolute discretion, without any liability whatsoever.

3 BEDROOM APARTMENT

TYPE C (with store room and maid room + yard) VARIANT 1

TOTAL SALEABLE AREA
 SUITE = 1,708.66 SQ.FT.
 YARD = 782.88 SQ.FT.
 TOTAL = 2,491.54 SQ.FT.

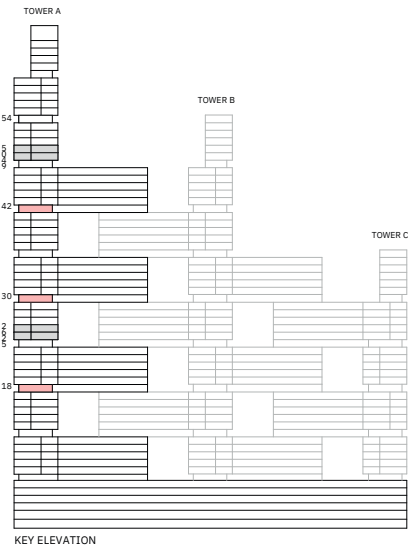

List of unit numbers with this unit plan:

VIEWS

Downtown, Ras Al Khor, Creek, Golf Course, water body, Amenities
 A1807

Downtown, Ras Al Khor, Creek, Golf Course, water body
 A3007, A4207

Disclaimer: 1. All dimensions are in metric, measured to wall finishes. 2. All materials, dimensions & drawings are approximate. 3. Information is subject to change without notice, at developer's absolute discretion. 4. Actual area may vary from the stated area. 5. Drawing are not to scale. 6. All images used are for illustrative purpose only and do not represent the actual size, features, specifications, fittings and furnishings. 7. The developer reserves the right to make revisions/ alterations, at its absolute discretion, without any liability whatsoever.

3 BEDROOM APARTMENT

TYPE C (with store room and maid room + yard) VARIANT 1

TOTAL SALEABLE AREA
SUITE = 1,708.66 SQ.FT.
YARD = 782.88 SQ.FT.
TOTAL = 2,491.54 SQ.FT.

UNIT

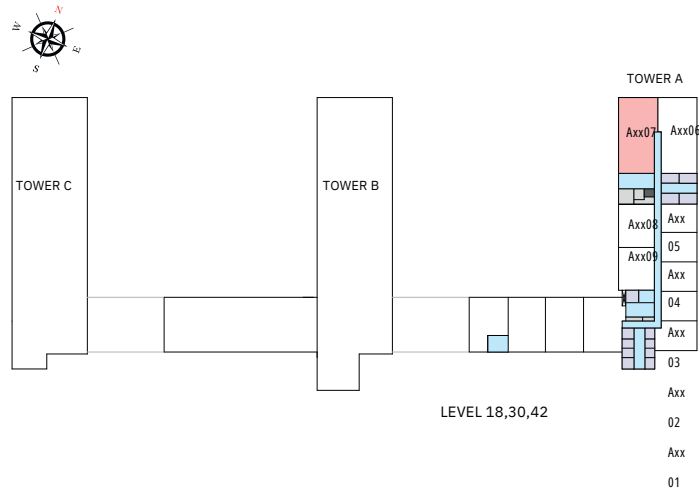

List of unit numbers with this unit plan:

VIEWS

Downtown, Ras Al Khor, Creek, Golf Course, water body, Amenities
A1807

Downtown, Ras Al Khor, Creek, Golf Course, water body
A3007, A4207

Disclaimer: 1. All dimensions are in metric, measured to wall finishes. 2. All materials, dimensions & drawings are approximate. 3. Information is subject to change without notice, at developer's absolute discretion. 4. Actual area may vary from the stated area. 5. Drawing are not to scale. 6. All images used are for illustrative purpose only and do not represent the actual size, features, specifications, fittings and furnishings. 7. The developer reserves the right to make revisions/ alterations, at its absolute discretion, without any liability whatsoever.

3 BEDROOM APARTMENT

TYPE D (with store room and maid room + yard)

TOTAL SALEABLE AREA
 SUITE = 1,708.66 SQ.FT.
 YARD = 536.03 SQ.FT.
 TOTAL = 2,244.69 SQ.FT.

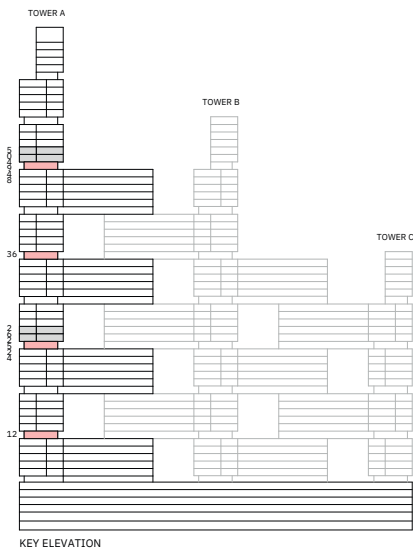

List of unit numbers with this unit plan:

VIEWS

Downtown, Ras Al Khor, Creek, Golf Course, water body, Amenities
 A1207, A2407

Downtown, Ras Al Khor, Creek, Golf Course, water body
 A3607, A4807

Disclaimer: 1. All dimensions are in metric, measured to wall finishes. 2. All materials, dimensions & drawings are approximate. 3. Information is subject to change without notice, at developer's absolute discretion. 4. Actual area may vary from the stated area. 5. Drawing are not to scale. 6. All images used are for illustrative purpose only and do not represent the actual size, features, specifications, fittings and furnishings. 7. The developer reserves the right to make revisions/ alterations, at its absolute discretion, without any liability whatsoever.

3 BEDROOM APARTMENT

TYPE D (with store room and maid room + yard)

TOTAL SALEABLE AREA
SUITE = 1,708.66 SQ.FT.
YARD = 536.03 SQ.FT.
TOTAL = 2,244.69 SQ.FT.

UNIT

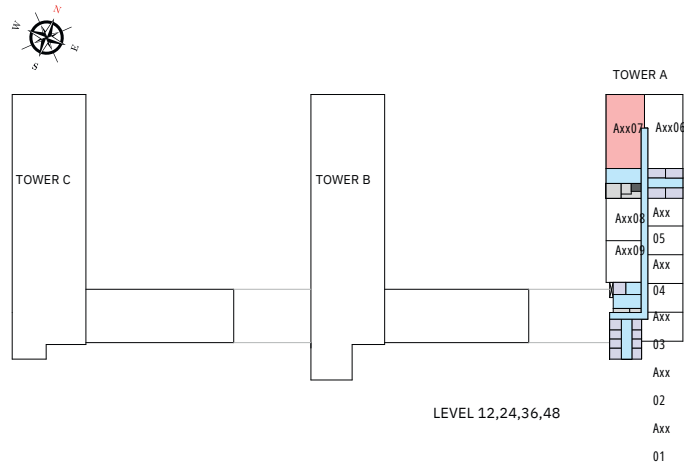

List of unit numbers with this unit plan:

VIEWS

Downtown, Ras Al Khor, Creek, Golf Course, water body, Amenities
A1207, A2407

Downtown, Ras Al Khor, Creek, Golf Course, water body
A3607, A4807

Disclaimer: 1. All dimensions are in metric, measured to wall finishes. 2. All materials, dimensions & drawings are approximate. 3. Information is subject to change without notice, at developer's absolute discretion. 4. Actual area may vary from the stated area. 5. Drawing are not to scale. 6. All images used are for illustrative purpose only and do not represent the actual size, features, specifications, fittings and furnishings. 7. The developer reserves the right to make revisions/ alterations, at its absolute discretion, without any liability whatsoever.

3 BEDROOM APARTMENT

TYPE D (with store room and maid room + yard) VARIANT 1

TOTAL SALEABLE AREA

SUITE = 1,708.66 SQ.FT.

YARD = 536.03 SQ.FT.

TOTAL = 2,244.69 SQ.FT.

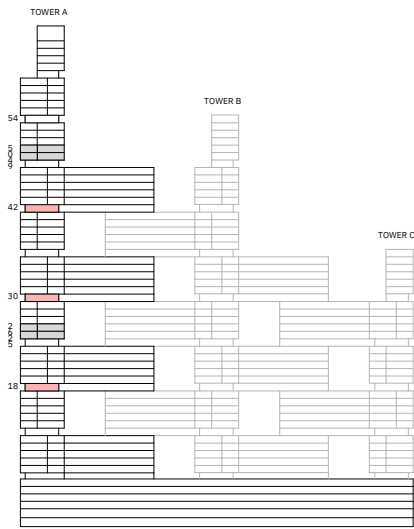

KEY ELEVATION

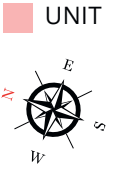

List of unit numbers with this unit plan:

VIEWS

Downtown, Ras Al Khor, Creek, Golf Course, water body
A1806, A3006, A4206

Disclaimer: 1. All dimensions are in metric, measured to wall finishes. 2. All materials, dimensions & drawings are approximate. 3. Information is subject to change without notice, at developer's absolute discretion. 4. Actual area may vary from the stated area. 5. Drawing are not to scale. 6. All images used are for illustrative purpose only and do not represent the actual size, features, specifications, fittings and furnishings. 7. The developer reserves the right to make revisions/ alterations, at its absolute discretion, without any liability whatsoever.

3 BEDROOM APARTMENT

TYPE D (with store room and maid room + yard) VARIANT 1

TOTAL SALEABLE AREA
SUITE = 1,708.66 SQ.FT.
YARD = 536.03 SQ.FT.
TOTAL = 2,244.69 SQ.FT.

UNIT

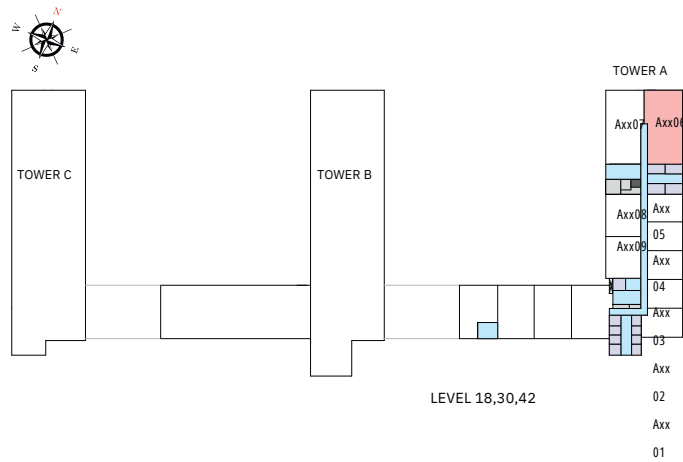

List of unit numbers with this unit plan:

VIEWS

Downtown, Ras Al Khor, Creek, Golf Course, water body
A1806, A3006, A4206

Disclaimer: 1. All dimensions are in metric, measured to wall finishes. 2. All materials, dimensions & drawings are approximate. 3. Information is subject to change without notice, at developer's absolute discretion. 4. Actual area may vary from the stated area. 5. Drawing are not to scale. 6. All images used are for illustrative purpose only and do not represent the actual size, features, specifications, fittings and furnishings. 7. The developer reserves the right to make revisions/ alterations, at its absolute discretion, without any liability whatsoever.

3 BEDROOM APARTMENT

TYPE E (with maid room + yard)

TOTAL SALEABLE AREA
 SUITE = 1,642.57 SQ.FT.
 YARD = 539.66 SQ.FT.
 TOTAL = 2,182.23 SQ.FT.

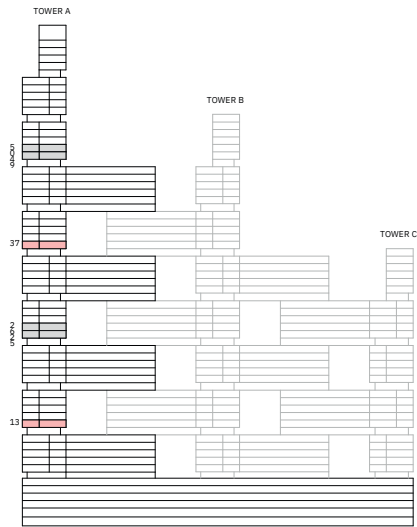

KEY ELEVATION

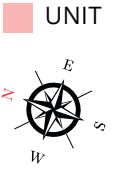

List of unit numbers with this unit plan:

VIEWS

Ras Al Khor, Creek, Golf Course
 A1306, A3706

Disclaimer: 1. All dimensions are in metric, measured to wall finishes. 2. All materials, dimensions & drawings are approximate. 3. Information is subject to change without notice, at developer's absolute discretion. 4. Actual area may vary from the stated area. 5. Drawing are not to scale. 6. All images used are for illustrative purpose only and do not represent the actual size, features, specifications, fittings and furnishings. 7. The developer reserves the right to make revisions/ alterations, at its absolute discretion, without any liability whatsoever.

3 BEDROOM APARTMENT

TYPE E (with maid room + yard)

TOTAL SALEABLE AREA
SUITE = 1,642.57 SQ.FT.
YARD = 539.66 SQ.FT.
TOTAL = 2,182.23 SQ.FT.

UNIT

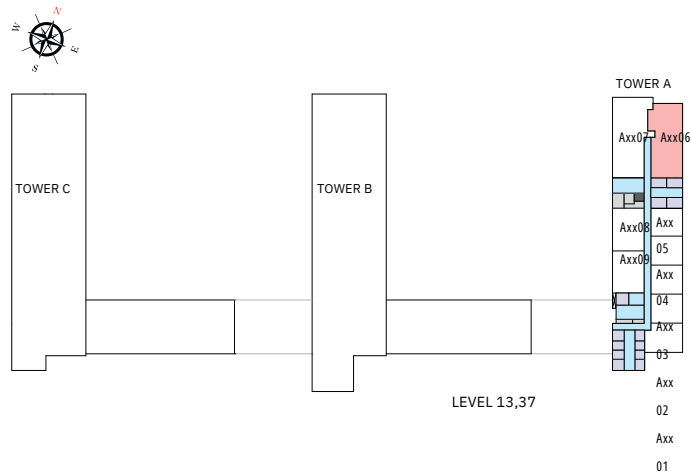

List of unit numbers with this unit plan:

VIEWS

Ras Al Khor, Creek, Golf Course
A1306, A3706

Disclaimer: 1. All dimensions are in metric, measured to wall finishes. 2. All materials, dimensions & drawings are approximate. 3. Information is subject to change without notice, at developer's absolute discretion. 4. Actual area may vary from the stated area. 5. Drawing are not to scale. 6. All images used are for illustrative purpose only and do not represent the actual size, features, specifications, fittings and furnishings. 7. The developer reserves the right to make revisions/ alterations, at its absolute discretion, without any liability whatsoever.

3 BEDROOM APARTMENT

TYPE E (with maid room + yard) VARIANT 1

TOTAL SALEABLE AREA

SUITE = 1,642.57 SQ.FT.

YARD = 539.66 SQ.FT.

TOTAL = 2,182.23 SQ.FT.

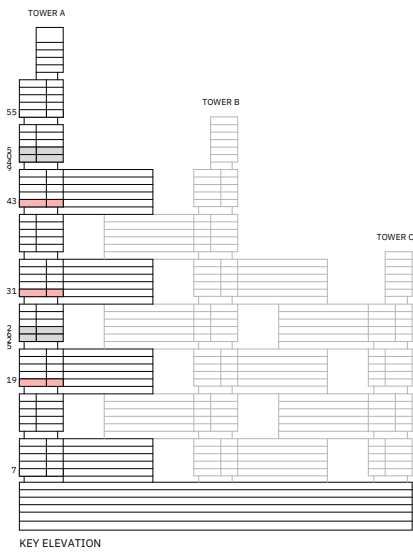

List of unit numbers with this unit plan:

VIEWS

Downtown, Ras Al Khor, Creek, Golf Course, water body, Amenities
A1907

Downtown, Ras Al Khor, Creek, Golf Course, water body
A3107, A4307

Disclaimer: 1. All dimensions are in metric, measured to wall finishes. 2. All materials, dimensions & drawings are approximate. 3. Information is subject to change without notice, at developer's absolute discretion. 4. Actual area may vary from the stated area. 5. Drawing are not to scale. 6. All images used are for illustrative purpose only and do not represent the actual size, features, specifications, fittings and furnishings. 7. The developer reserves the right to make revisions/ alterations, at its absolute discretion, without any liability whatsoever.

3 BEDROOM APARTMENT

TYPE E (with maid room + yard) VARIANT 1

TOTAL SALEABLE AREA
 SUITE = 1,642.57 SQ.FT.
 YARD = 539.66 SQ.FT.
 TOTAL = 2,182.23 SQ.FT.

■ UNIT

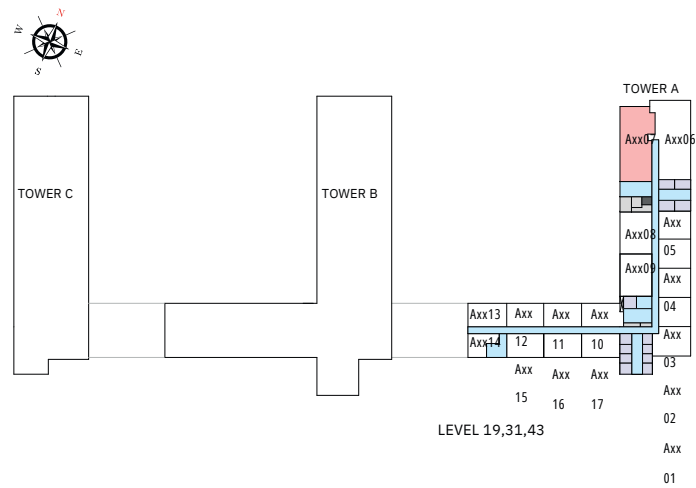

List of unit numbers with this unit plan:

VIEWS

Downtown, Ras Al Khor, Creek, Golf Course, water body, Amenities
 A1907

Downtown, Ras Al Khor, Creek, Golf Course, water body
 A3107, A4307

Disclaimer: 1. All dimensions are in metric, measured to wall finishes. 2. All materials, dimensions & drawings are approximate. 3. Information is subject to change without notice, at developer's absolute discretion. 4. Actual area may vary from the stated area. 5. Drawing are not to scale. 6. All images used are for illustrative purpose only and do not represent the actual size, features, specifications, fittings and furnishings. 7. The developer reserves the right to make revisions/ alterations, at its absolute discretion, without any liability whatsoever.

4 BEDROOM APARTMENT

TYPE A (with store room, maid room and powder room + balcony)

TOTAL SALEABLE AREA
 SUITE = 2,080.88 SQ.FT.
 BALCONY = 196.34 SQ.FT.
 TOTAL = 2,277.22 SQ.FT.

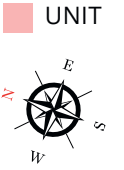
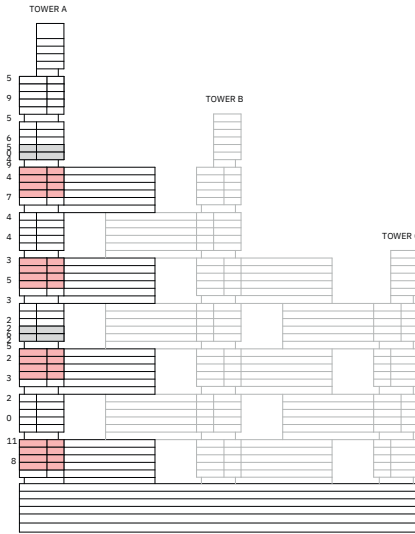

List of unit numbers with this unit plan:

VIEWS

Downtown, Ras Al Khor, Creek, Golf Course, waterbody
 A806, A906, A1006, A1106, A2006, A2106, A2206, A2306, A3206, A3306, A3406, A3506, A4406, A4506, A4606, A4706

Disclaimer: 1. All dimensions are in metric, measured to wall finishes. 2. All materials, dimensions & drawings are approximate. 3. Information is subject to change without notice, at developer's absolute discretion. 4. Actual area may vary from the stated area. 5. Drawing are not to scale. 6. All images used are for illustrative purpose only and do not represent the actual size, features, specifications, fittings and furnishings. 7. The developer reserves the right to make revisions/ alterations, at its absolute discretion, without any liability whatsoever.

4 BEDROOM APARTMENT

TYPE A (with store room, maid room and powder room + balcony)

TOTAL SALEABLE AREA
 SUITE = 2,080.88 SQ.FT.
 BALCONY = 196.34 SQ.FT.
 TOTAL = 2,277.22 SQ.FT.

UNIT

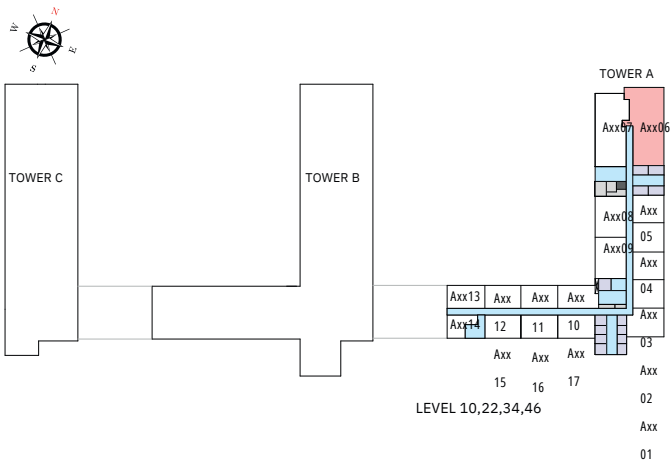
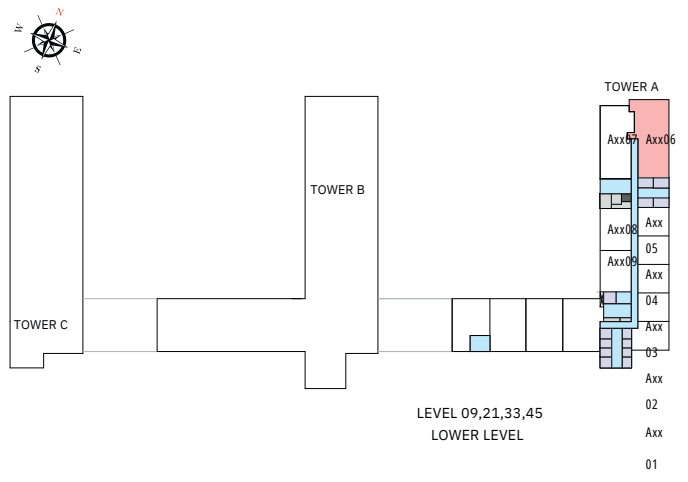
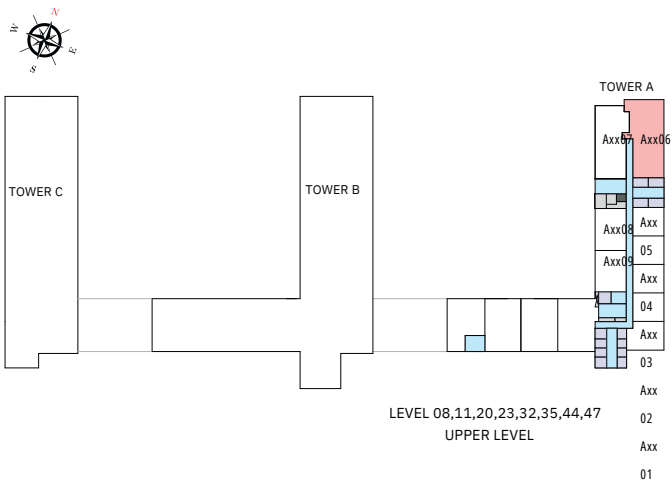

List of unit numbers with this unit plan:

VIEWS

Downtown, Ras Al Khor, Creek, Golf Course, waterbody
 A806, A906, A1006, A1106, A2006, A2106, A2206, A2306, A3206, A3306, A3406, A3506, A4406, A4506, A4606, A4706

Disclaimer: 1. All dimensions are in metric, measured to wall finishes. 2. All materials, dimensions & drawings are approximate. 3. Information is subject to change without notice, at developer's absolute discretion. 4. Actual area may vary from the stated area. 5. Drawing are not to scale. 6. All images used are for illustrative purpose only and do not represent the actual size, features, specifications, fittings and furnishings. 7. The developer reserves the right to make revisions/ alterations, at its absolute discretion, without any liability whatsoever.

4 BEDROOM APARTMENT

TYPE A (with store room, maid room and powder room + balcony) VARIANT 1

TOTAL SALEABLE AREA
 SUITE = 2,080.88 SQ.FT.
 BALCONY = 196.34 SQ.FT.
 TOTAL = 2,277.22 SQ.FT.

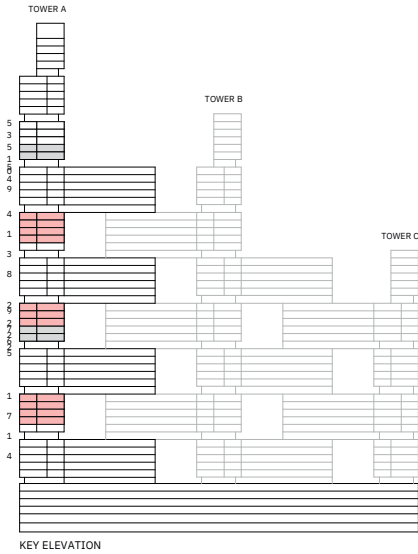

List of unit numbers with this unit plan:

VIEWS

Downtown, Ras Al Khor, Creek, Golf Course, water body, Amenities
 A1407, A1507, A1607, A1707

Downtown, Ras Al Khor, Creek, Golf Course, water body
 A2707, A2807, A2907, A3807, A3907, A4007, A4107

Disclaimer: 1. All dimensions are in metric, measured to wall finishes. 2. All materials, dimensions & drawings are approximate. 3. Information is subject to change without notice, at developer's absolute discretion. 4. Actual area may vary from the stated area. 5. Drawing are not to scale. 6. All images used are for illustrative purpose only and do not represent the actual size, features, specifications, fittings and furnishings. 7. The developer reserves the right to make revisions/ alterations, at its absolute discretion, without any liability whatsoever.

4 BEDROOM APARTMENT

TYPE A (with store room, maid room and powder room + balcony) VARIANT 1

TOTAL SALEABLE AREA
SUITE = 2,080.88 SQ.FT.
BALCONY = 196.34 SQ.FT.
TOTAL = 2,277.22 SQ.FT.

UNIT

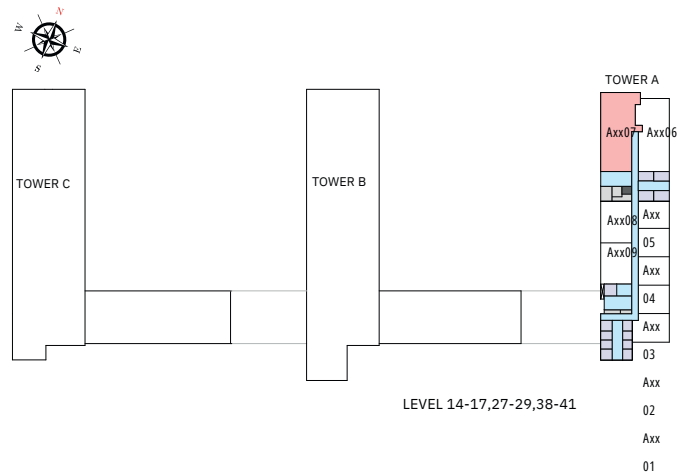

List of unit numbers with this unit plan:

VIEWS

Downtown, Ras Al Khor, Creek, Golf Course, water body, Amenities
A1407, A1507, A1607, A1707

Downtown, Ras Al Khor, Creek, Golf Course, water body
A2707, A2807, A2907, A3807, A3907, A4007, A4107

Disclaimer: 1. All dimensions are in metric, measured to wall finishes. 2. All materials, dimensions & drawings are approximate. 3. Information is subject to change without notice, at developer's absolute discretion. 4. Actual area may vary from the stated area. 5. Drawing are not to scale. 6. All images used are for illustrative purpose only and do not represent the actual size, features, specifications, fittings and furnishings. 7. The developer reserves the right to make revisions/ alterations, at its absolute discretion, without any liability whatsoever.

4 BEDROOM APARTMENT

TYPE B (with store room, maid room and powder room + yard)

TOTAL SALEABLE AREA
 SUITE = 2,084.43 SQ.FT.
 YARD = 477.92 SQ.FT.
 TOTAL = 2,562.35 SQ.FT.

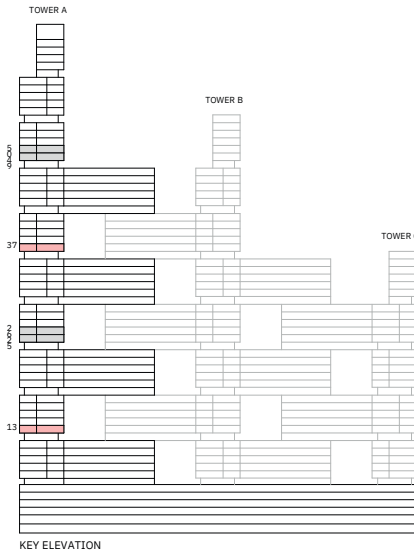

List of unit numbers with this unit plan:

VIEWS

Downtown, Ras Al Khor, Creek, Golf Course, water body, Amenities
 A1307

Downtown, Ras Al Khor, Creek, Golf Course, water body
 A3707

Disclaimer: 1. All dimensions are in metric, measured to wall finishes. 2. All materials, dimensions & drawings are approximate. 3. Information is subject to change without notice, at developer's absolute discretion. 4. Actual area may vary from the stated area. 5. Drawing are not to scale. 6. All images used are for illustrative purpose only and do not represent the actual size, features, specifications, fittings and furnishings. 7. The developer reserves the right to make revisions/ alterations, at its absolute discretion, without any liability whatsoever.

4 BEDROOM APARTMENT

TYPE B (with store room, maid room and powder room + yard)

TOTAL SALEABLE AREA
SUITE = 2,084.43 SQ.FT.
YARD = 477.92 SQ.FT.
TOTAL = 2,562.35 SQ.FT.

UNIT

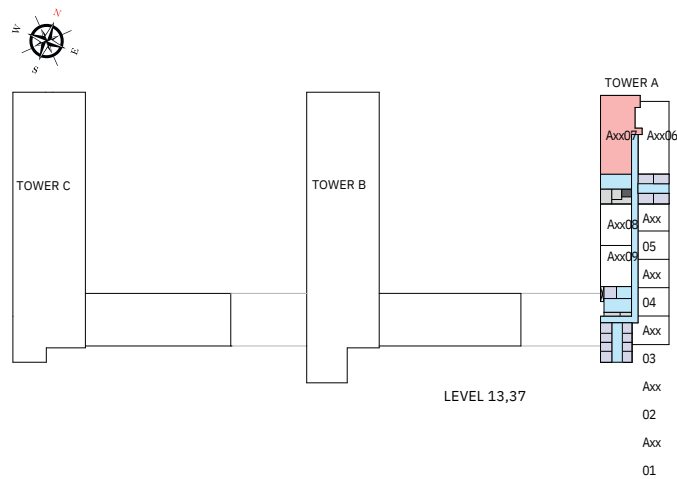

List of unit numbers with this unit plan:

VIEWS

Downtown, Ras Al Khor, Creek, Golf Course, water body, Amenities
A1307

Downtown, Ras Al Khor, Creek, Golf Course, water body
A3707

Disclaimer: 1. All dimensions are in metric, measured to wall finishes. 2. All materials, dimensions & drawings are approximate. 3. Information is subject to change without notice, at developer's absolute discretion. 4. Actual area may vary from the stated area. 5. Drawing are not to scale. 6. All images used are for illustrative purpose only and do not represent the actual size, features, specifications, fittings and furnishings. 7. The developer reserves the right to make revisions/ alterations, at its absolute discretion, without any liability whatsoever.

4 BEDROOM APARTMENT

TYPE B (with store room, maid room and powder room + yard) VARIANT 1

TOTAL SALEABLE AREA
 SUITE = 2,084.43 SQ.FT.
 YARD = 477.32 SQ.FT.
 TOTAL = 2,562.35 SQ.FT.

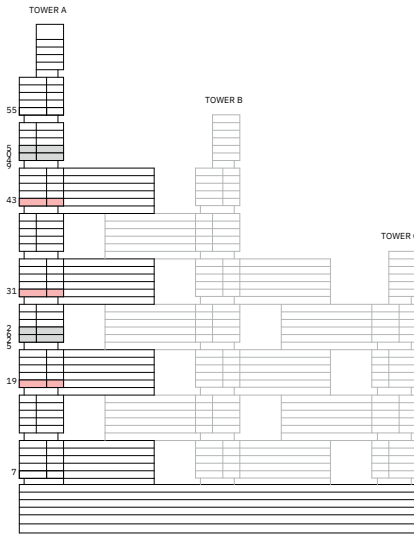

KEY ELEVATION

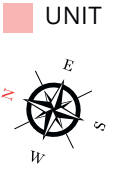

List of unit numbers with this unit plan:

VIEWS

Downtown, Ras Al Khor, Creek, Golf Course, waterbody
 A1906, A3106, A4306

Disclaimer: 1. All dimensions are in metric, measured to wall finishes. 2. All materials, dimensions & drawings are approximate. 3. Information is subject to change without notice, at developer's absolute discretion. 4. Actual area may vary from the stated area. 5. Drawing are not to scale. 6. All images used are for illustrative purpose only and do not represent the actual size, features, specifications, fittings and furnishings. 7. The developer reserves the right to make revisions/ alterations, at its absolute discretion, without any liability whatsoever.

4 BEDROOM APARTMENT

TYPE B (with store room, maid room and powder room + yard) VARIANT 1

TOTAL SALEABLE AREA
 SUITE = 2,084.43 SQ.FT.
 YARD = 477.32 SQ.FT.
 TOTAL = 2,562.35 SQ.FT.

■ UNIT

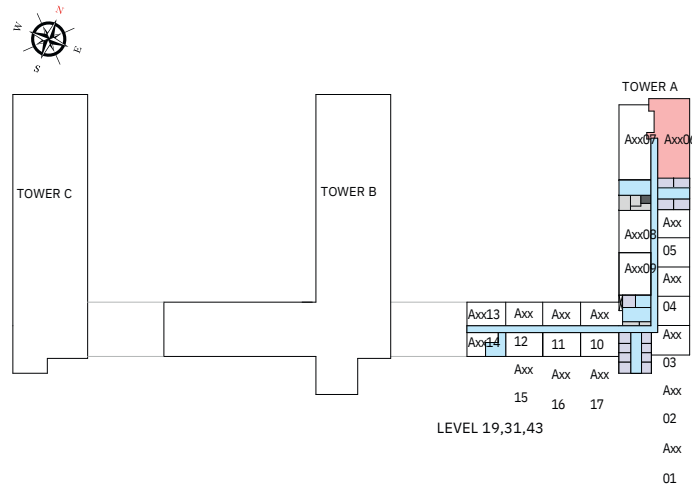

List of unit numbers with this unit plan:

VIEWS

Downtown, Ras Al Khor, Creek, Golf Course, waterbody
 A1906, A3106, A4306

Disclaimer: 1. All dimensions are in metric, measured to wall finishes. 2. All materials, dimensions & drawings are approximate. 3. Information is subject to change without notice, at developer's absolute discretion. 4. Actual area may vary from the stated area. 5. Drawing are not to scale. 6. All images used are for illustrative purpose only and do not represent the actual size, features, specifications, fittings and furnishings. 7. The developer reserves the right to make revisions/ alterations, at its absolute discretion, without any liability whatsoever.

2 BEDROOM DUPLEX APARTMENT

TYPE A (with store room, maid room and powder room + balcony)

TOTAL SALEABLE AREA
 SUITE = 1,701.76 SQ.FT.
 BALCONY = 178.96 SQ.FT.
 TOTAL = 1,880.72 SQ.FT.

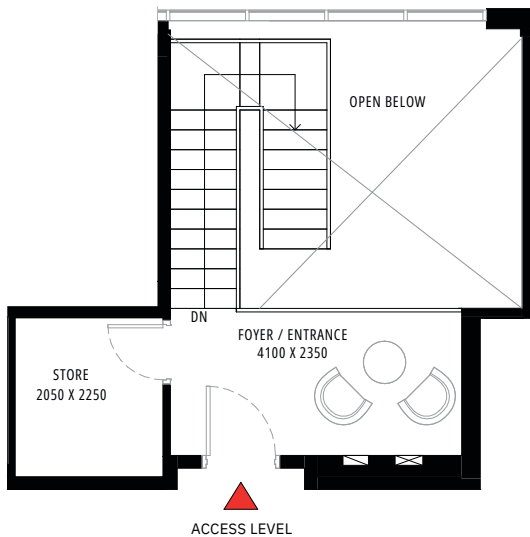
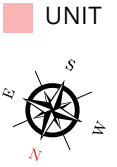
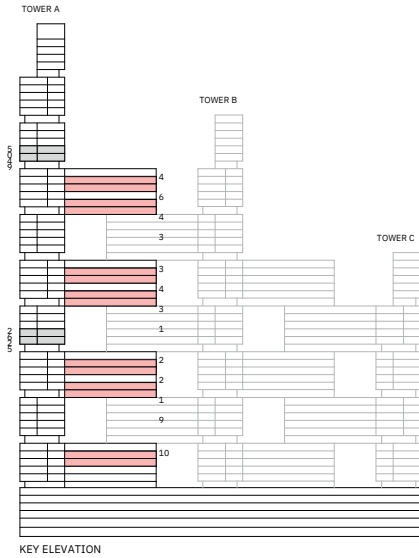

LOWER LEVEL

List of unit numbers with this unit plan:

VIEWS

Ras Al Khor, Golf Course, Amenities
 A1014, A1914, A2214

Ras Al Khor, Golf Course
 A3114, A3414, A4314, A4614

Disclaimer: 1. All dimensions are in metric, measured to wall finishes. 2. All materials, dimensions & drawings are approximate. 3. Information is subject to change without notice, at developer's absolute discretion. 4. Actual area may vary from the stated area. 5. Drawing are not to scale. 6. All images used are for illustrative purpose only and do not represent the actual size, features, specifications, fittings and furnishings. 7. The developer reserves the right to make revisions/ alterations, at its absolute discretion, without any liability whatsoever.

2 BEDROOM DUPLEX APARTMENT

TYPE A (with store room, maid room and powder room + balcony)

TOTAL SALEABLE AREA
 SUITE = 1,701.76 SQ.FT.
 BALCONY = 178.96 SQ.FT.
 TOTAL = 1,880.72 SQ.FT.

■ UNIT

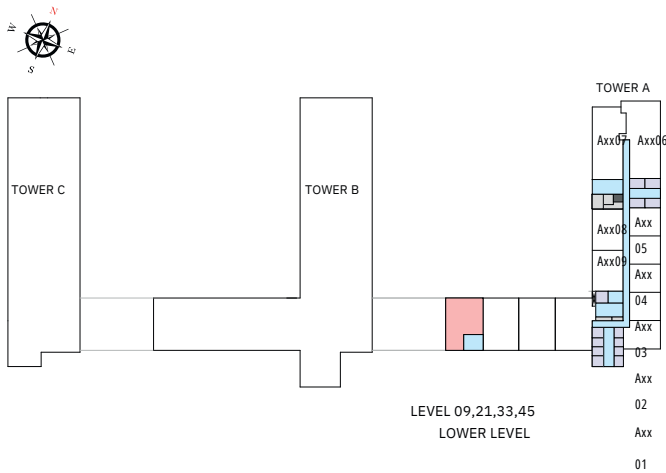
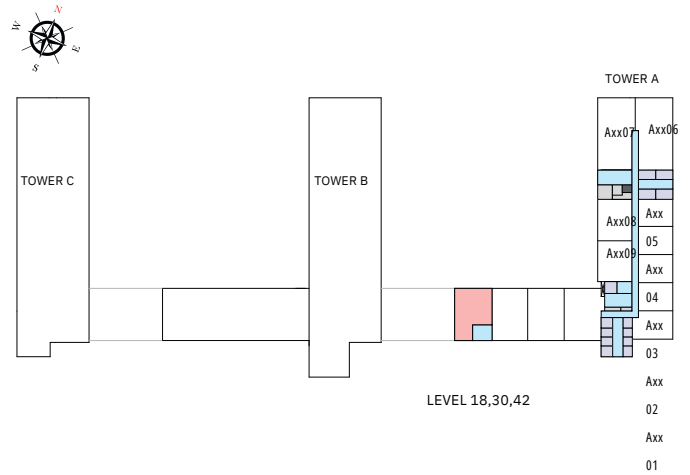
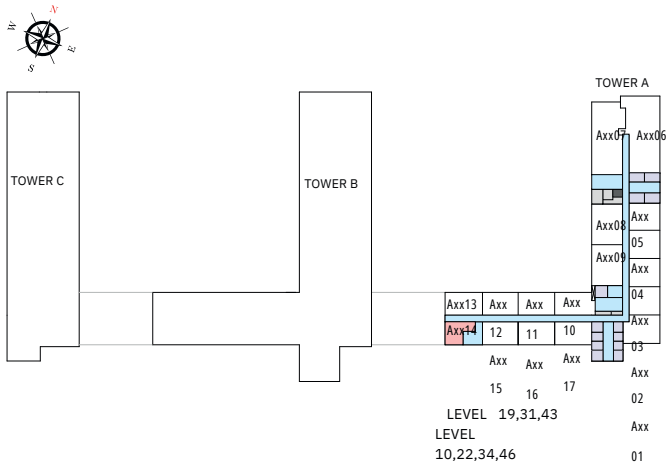

List of unit numbers with this unit plan:

VIEWS

Ras Al Khor, Golf Course, Amenities
 A1014, A1914, A2214

Ras Al Khor, Golf Course
 A3114, A3414, A4314, A4614

Disclaimer: 1. All dimensions are in metric, measured to wall finishes. 2. All materials, dimensions & drawings are approximate. 3. Information is subject to change without notice, at developer's absolute discretion. 4. Actual area may vary from the stated area. 5. Drawing are not to scale. 6. All images used are for illustrative purpose only and do not represent the actual size, features, specifications, fittings and furnishings. 7. The developer reserves the right to make revisions/ alterations, at its absolute discretion, without any liability whatsoever.

4 BEDROOM DUPLEX APARTMENT

TYPE A (with maid room and powder room + balcony)

TOTAL SALEABLE AREA
 SUITE = 2,176.53 SQ.FT.
 BALCONY = 176.25 SQ.FT.
 TOTAL = 2,352.78 SQ.FT.

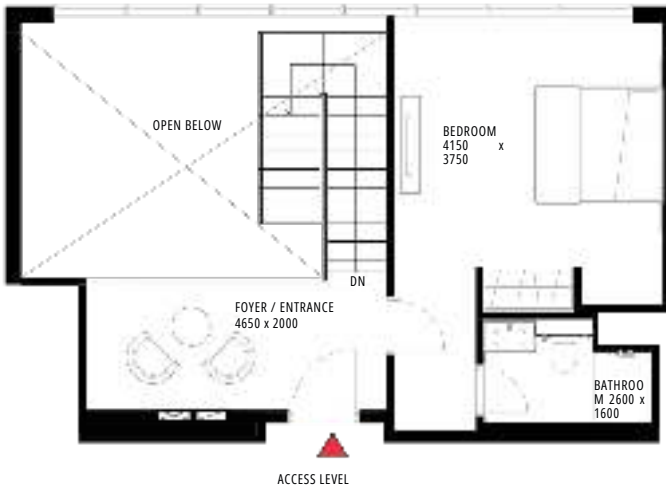
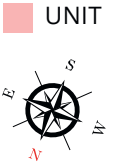
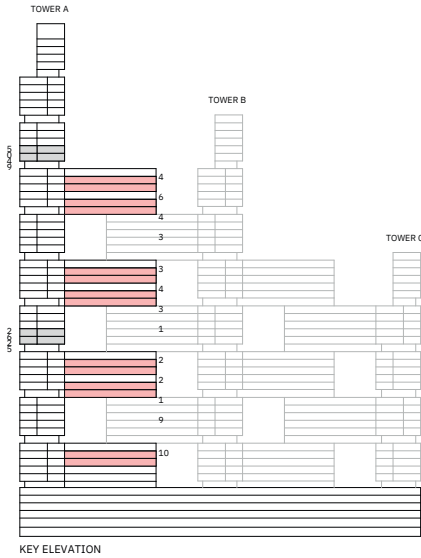

List of unit numbers with this unit plan:

VIEWS

Ras Al Khor, Golf Course, Amenities
 A1015, A1915, A2215

Ras Al Khor, Golf Course
 A3115, A3415, A4315, A4615

Disclaimer: 1. All dimensions are in metric, measured to wall finishes. 2. All materials, dimensions & drawings are approximate. 3. Information is subject to change without notice, at developer's absolute discretion. 4. Actual area may vary from the stated area. 5. Drawing are not to scale. 6. All images used are for illustrative purpose only and do not represent the actual size, features, specifications, fittings and furnishings. 7. The developer reserves the right to make revisions/ alterations, at its absolute discretion, without any liability whatsoever.

4 BEDROOM DUPLEX APARTMENT

TYPE A (with maid room and powder room + balcony)

TOTAL SALEABLE AREA
 SUITE = 2,176.53 SQ.FT.
 BALCONY = 176.25 SQ.FT.
 TOTAL = 2,352.78 SQ.FT.

■ UNIT

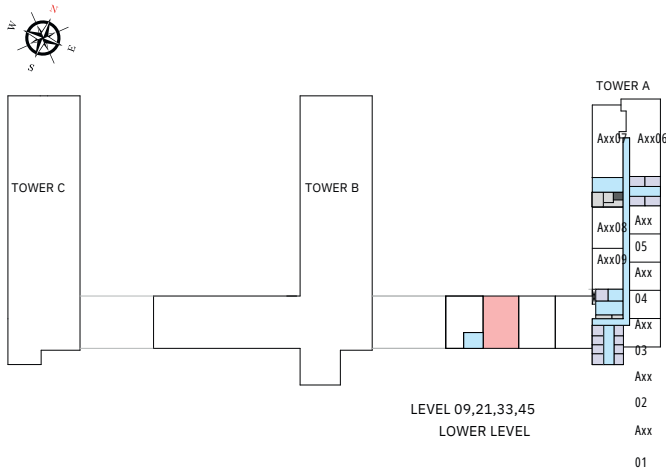
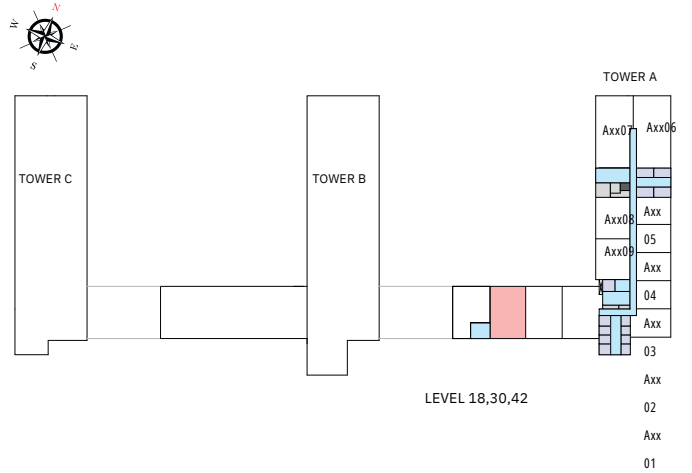
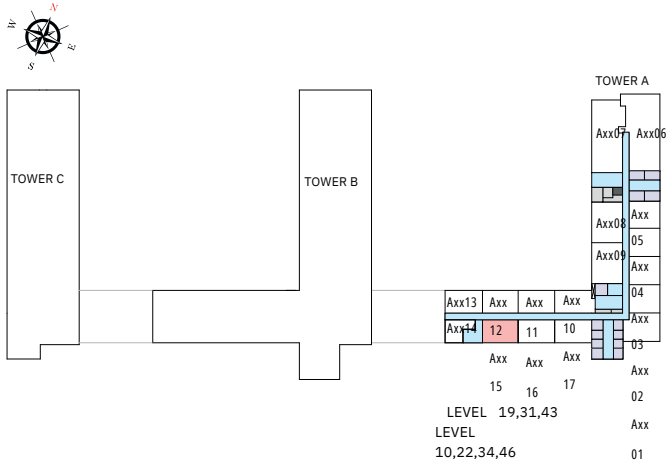

List of unit numbers with this unit plan:

VIEWS

Ras Al Khor, Golf Course, Amenities
 A1015, A1915, A2215

Ras Al Khor, Golf Course
 A3115, A3415, A4315, A4615

Disclaimer: 1. All dimensions are in metric, measured to wall finishes. 2. All materials, dimensions & drawings are approximate. 3. Information is subject to change without notice, at developer's absolute discretion. 4. Actual area may vary from the stated area. 5. Drawing are not to scale. 6. All images used are for illustrative purpose only and do not represent the actual size, features, specifications, fittings and furnishings. 7. The developer reserves the right to make revisions/ alterations, at its absolute discretion, without any liability whatsoever.

4 BEDROOM DUPLEX APARTMENT

TYPE A (with maid room and powder room + balcony) VARIANT 1

TOTAL SALEABLE AREA
 SUITE = 2,172.85 SQ.FT.
 BALCONY = 176.25 SQ.FT.
 TOTAL = 2,349.10 SQ.FT.

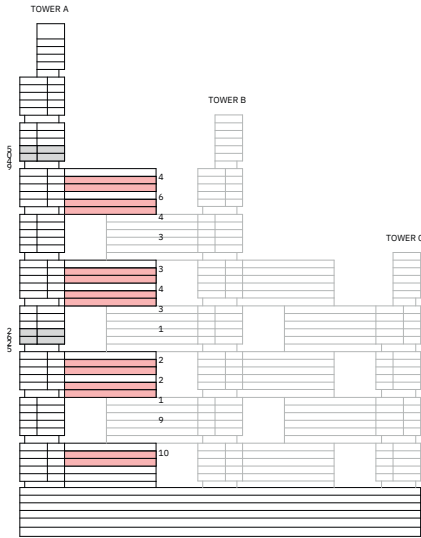

KEY ELEVATION

UNIT

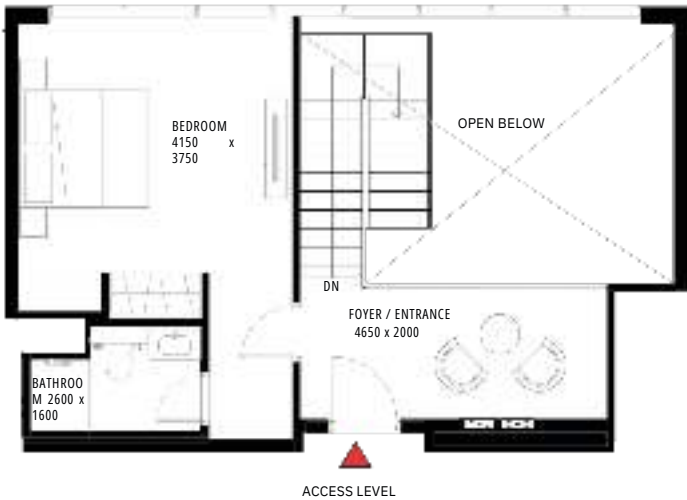
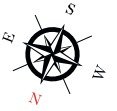

LOWER LEVEL

List of unit numbers with this unit plan:

VIEWS

Ras Al Khor, Golf Course, Amenities
 A1016, A1916, A2216

Ras Al Khor, Golf Course
 A3116, A3416, A4316, A4616

Disclaimer: 1. All dimensions are in metric, measured to wall finishes. 2. All materials, dimensions & drawings are approximate. 3. Information is subject to change without notice, at developer's absolute discretion. 4. Actual area may vary from the stated area. 5. Drawing are not to scale. 6. All images used are for illustrative purpose only and do not represent the actual size, features, specifications, fittings and furnishings. 7. The developer reserves the right to make revisions/ alterations, at its absolute discretion, without any liability whatsoever.

4 BEDROOM DUPLEX APARTMENT

TYPE A (with maid room and powder room + balcony) VARIANT 1

TOTAL SALEABLE AREA
 SUITE = 2,172.85 SQ.FT.
 BALCONY = 176.25 SQ.FT.
 TOTAL = 2,349.10 SQ.FT.

■ UNIT

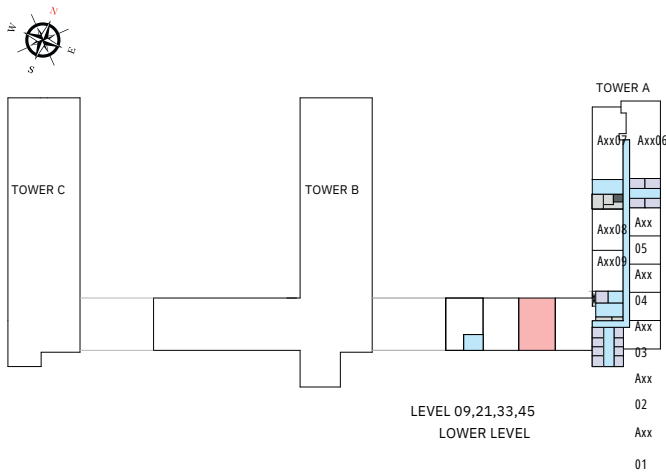
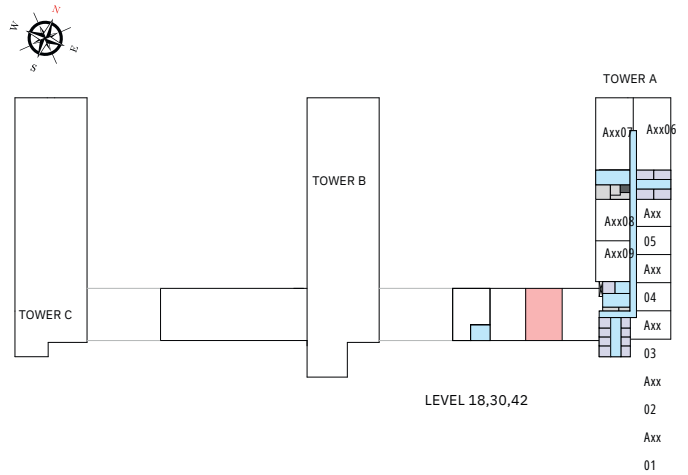
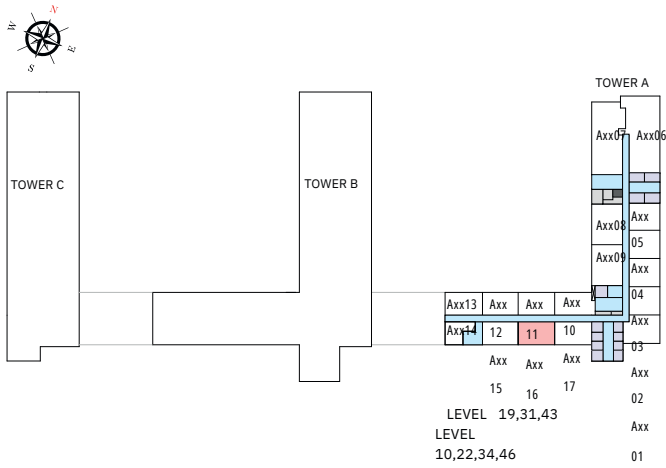

List of unit numbers with this unit plan:

VIEWS

Ras Al Khor, Golf Course, Amenities
 A1016, A1916, A2216

Ras Al Khor, Golf Course
 A3116, A3416, A4316, A4616

Disclaimer: 1. All dimensions are in metric, measured to wall finishes. 2. All materials, dimensions & drawings are approximate. 3. Information is subject to change without notice, at developer's absolute discretion. 4. Actual area may vary from the stated area. 5. Drawing are not to scale. 6. All images used are for illustrative purpose only and do not represent the actual size, features, specifications, fittings and furnishings. 7. The developer reserves the right to make revisions/ alterations, at its absolute discretion, without any liability whatsoever.

4 BEDROOM DUPLEX APARTMENT

TYPE A1 (with maid room and powder room + balcony)

TOTAL SALEABLE AREA
 SUITE = 2,227.74 SQ.FT.
 BALCONY = 173.33 SQ.FT.
 TOTAL = 2,401.07 SQ.FT.

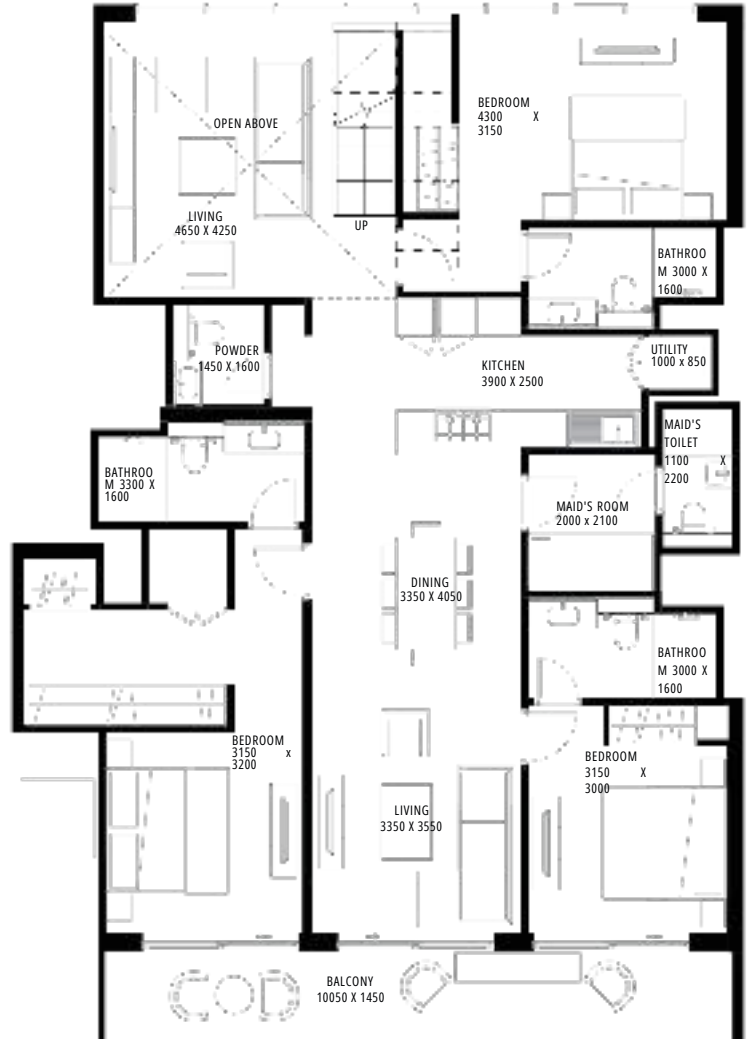
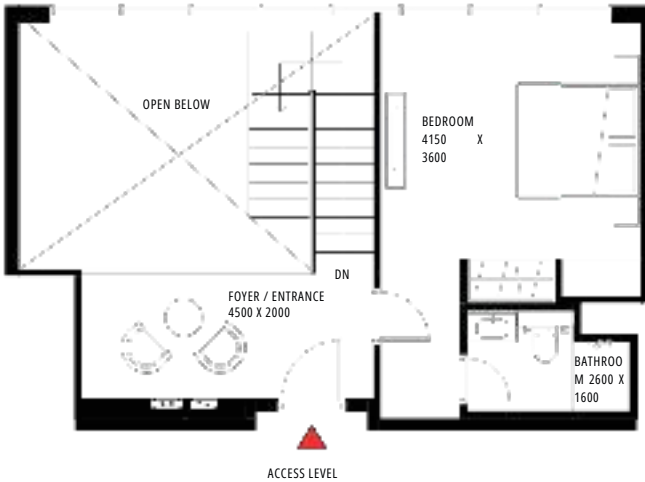
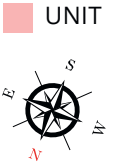
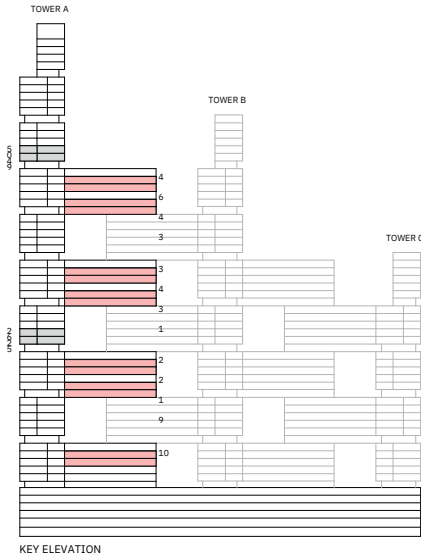

List of unit numbers with this unit plan:

VIEWS

Ras Al Khor, Golf Course, Amenities
 A1017, A1917, A2217

Ras Al Khor, Golf Course
 A3117, A3417, A4317, A4617

Disclaimer: 1. All dimensions are in metric, measured to wall finishes. 2. All materials, dimensions & drawings are approximate. 3. Information is subject to change without notice, at developer's absolute discretion. 4. Actual area may vary from the stated area. 5. Drawing are not to scale. 6. All images used are for illustrative purpose only and do not represent the actual size, features, specifications, fittings and furnishings. 7. The developer reserves the right to make revisions/ alterations, at its absolute discretion, without any liability whatsoever.

4 BEDROOM DUPLEX APARTMENT

TYPE A1 (with maid room and powder room + balcony)

TOTAL SALEABLE AREA
 SUITE = 2,227.74 SQ.FT.
 BALCONY = 173.33 SQ.FT.
 TOTAL = 2,401.07 SQ.FT.

■ UNIT

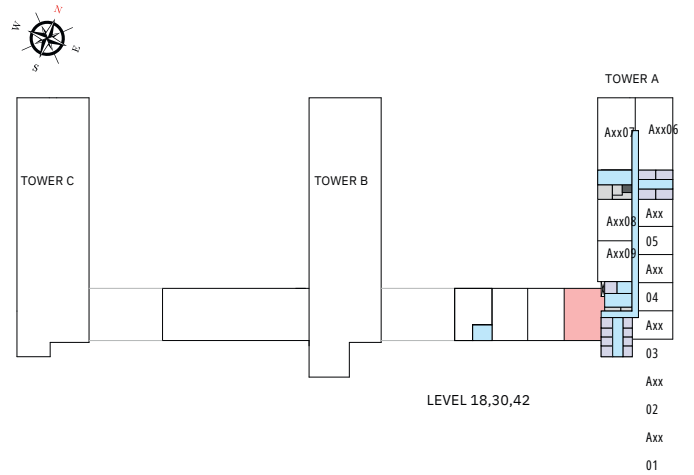
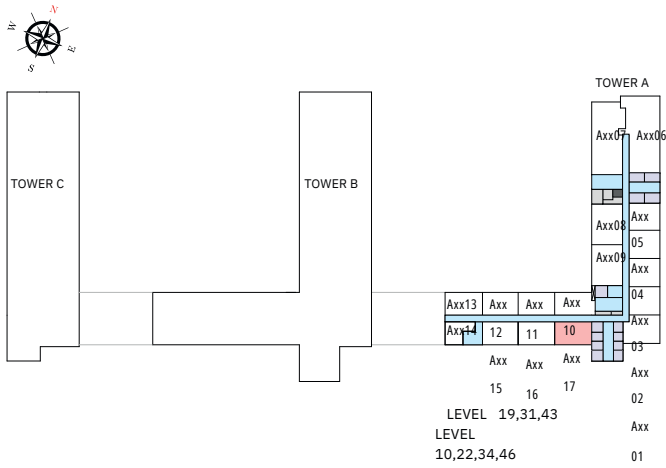

List of unit numbers with this unit plan:

VIEWS

Ras Al Khor, Golf Course, Amenities
 A1017, A1917, A2217

Ras Al Khor, Golf Course
 A3117, A3417, A4317, A4617

Disclaimer: 1. All dimensions are in metric, measured to wall finishes. 2. All materials, dimensions & drawings are approximate. 3. Information is subject to change without notice, at developer's absolute discretion. 4. Actual area may vary from the stated area. 5. Drawing are not to scale. 6. All images used are for illustrative purpose only and do not represent the actual size, features, specifications, fittings and furnishings. 7. The developer reserves the right to make revisions/ alterations, at its absolute discretion, without any liability whatsoever.

TOWER B

UNIT PLANS

1 BEDROOM APARTMENT

TYPE D (with balcony)

TOTAL SALEABLE AREA
 SUITE = 490.21 SQ.FT.
 BALCONY = 49.51 SQ.FT.
 TOTAL = 539.72 SQ.FT.

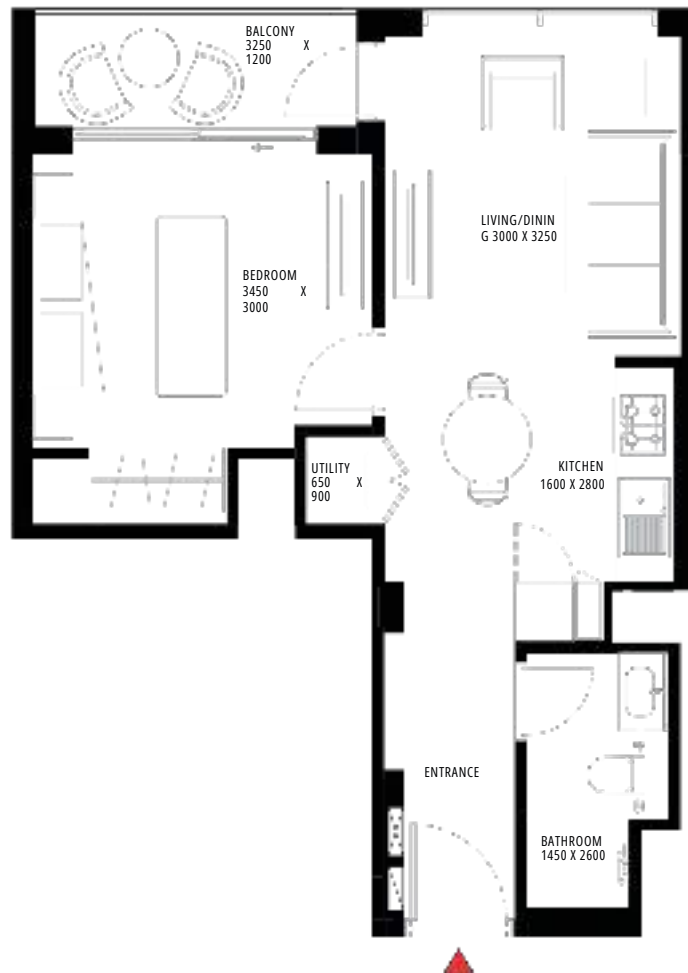
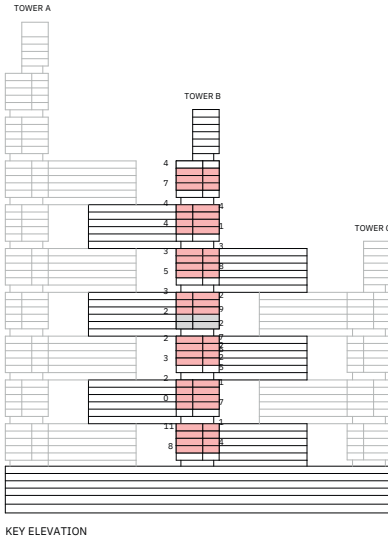

List of unit numbers with this unit plan:

VIEWS

Ras Al Khor, Golf Course, Amenities
 B806, B906, B1006, B1106, B1406, B1506, B1606, B1706, B2006, B2106, B2206, B2306

Ras Al Khor, Golf Course, Water Body
 B2706, B2806, B2906, B3206, B3306, B3406, B3506

Ras Al Khor, Golf Course
 B3806, B3906, B4006, B4106, B4406, B4506, B4606

Disclaimer: 1. All dimensions are in metric, measured to wall finishes. 2. All materials, dimensions & drawings are approximate. 3. Information is subject to change without notice, at developer's absolute discretion. 4. Actual area may vary from the stated area. 5. Drawing are not to scale. 6. All images used are for illustrative purpose only and do not represent the actual size, features, specifications, fittings and furnishings. 7. The developer reserves the right to make revisions/ alterations, at its absolute discretion, without any liability whatsoever.

1 BEDROOM APARTMENT

TYPE D (with balcony)

TOTAL SALEABLE AREA

SUITE = 490.21 SQ.FT.

BALCONY = 49.51 SQ.FT.

TOTAL = 539.72 SQ.FT.

 UNIT

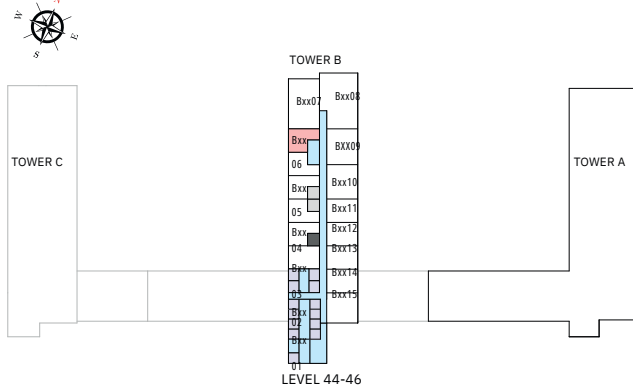
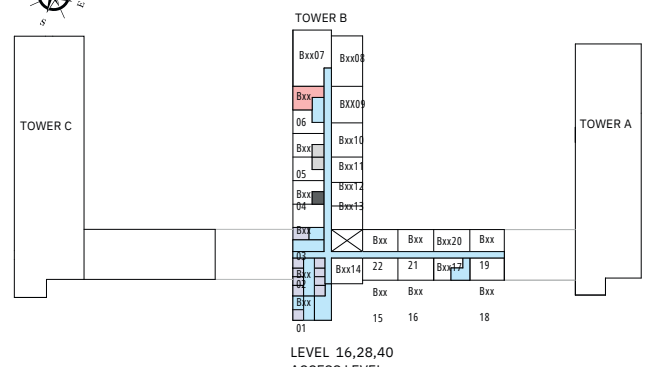
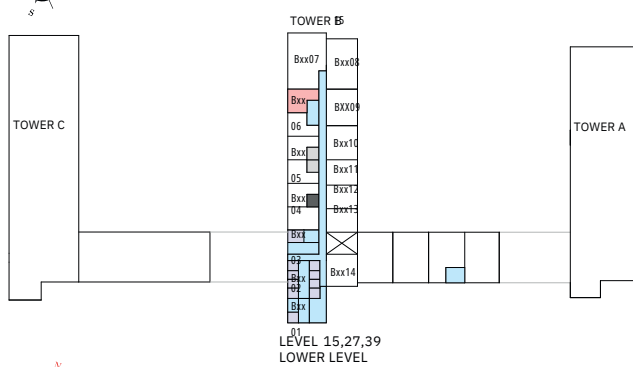
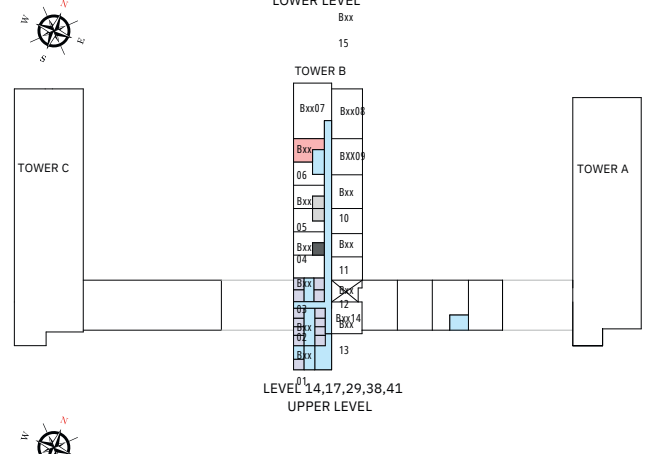
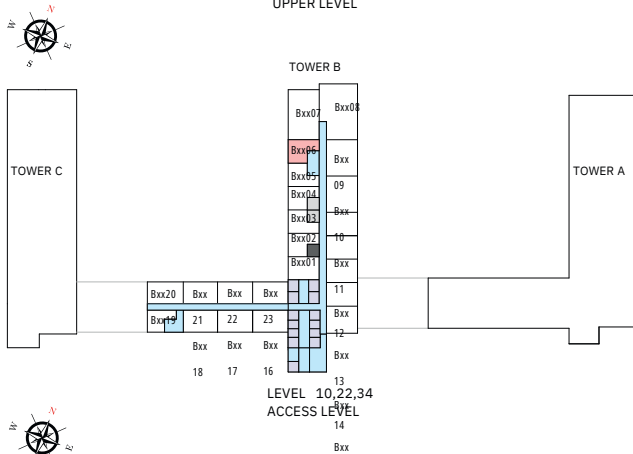
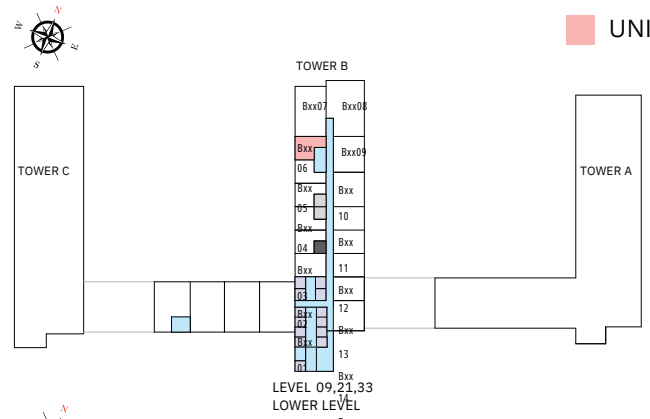
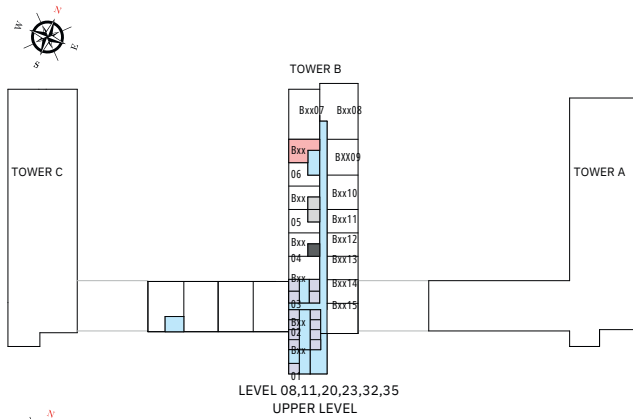

List of unit numbers with this unit plan:

VIEWS

Ras Al Khor, Golf Course, Amenities

B806, B906, B1006, B1106, B1406, B1506, B1606, B1706, B2006, B2106, B2206, B2306

Ras Al Khor, Golf Course, Water Body

B2706, B2806, B2906, B3206, B3306, B3406, B3506

Ras Al Khor, Golf Course

B3806, B3906, B4006, B4106, B4406, B4506, B4606

Disclaimer: 1. All dimensions are in metric, measured to wall finishes. 2. All materials, dimensions & drawings are approximate. 3. Information is subject to change without notice, at developer's absolute discretion. 4. Actual area may vary from the stated area. 5. Drawing are not to scale. 6. All images used are for illustrative purpose only and do not represent the actual size, features, specifications, fittings and furnishings. 7. The developer reserves the right to make revisions/ alterations, at its absolute discretion, without any liability whatsoever.

1 BEDROOM APARTMENT

TYPE D (with balcony) VARIANT 1

TOTAL SALEABLE AREA
 SUITE = 491.58 SQ.FT.
 BALCONY = 46.05 SQ.FT.
 TOTAL = 537.63 SQ.FT.

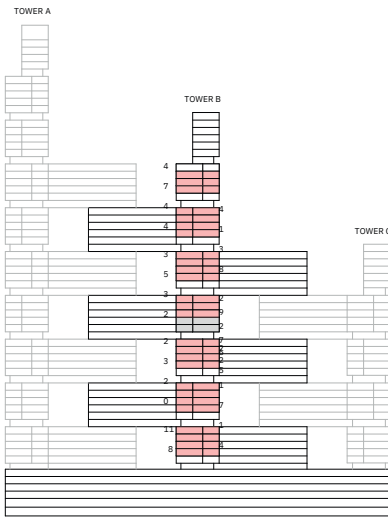

KEY ELEVATION



List of unit numbers with this unit plan:

VIEWS

Ras Al Khor, Golf Course, Amenities
 B805, B905, B1005, B1105, B1405, B1505, B1605, B1705, B2005, B2105, B2205, B2305

Ras Al Khor, Golf Course
 B3805, B3905, B4005, B4105, B4405, B4505, B4605

Ras Al Khor, Golf Course, Water Body
 B2705, B2805, B2905, B3205, B3305, B3405, B3505

Disclaimer: 1. All dimensions are in metric, measured to wall finishes. 2. All materials, dimensions & drawings are approximate. 3. Information is subject to change without notice, at developer's absolute discretion. 4. Actual area may vary from the stated area. 5. Drawing are not to scale. 6. All images used are for illustrative purpose only and do not represent the actual size, features, specifications, fittings and furnishings. 7. The developer reserves the right to make revisions/ alterations, at its absolute discretion, without any liability whatsoever.

1 BEDROOM APARTMENT

TYPE D (with balcony) VARIANT 1

TOTAL SALEABLE AREA

SUITE = 491.58 SQ.FT.

BALCONY = 46.05 SQ.FT.

TOTAL = 537.63 SQ.FT.

 UNIT

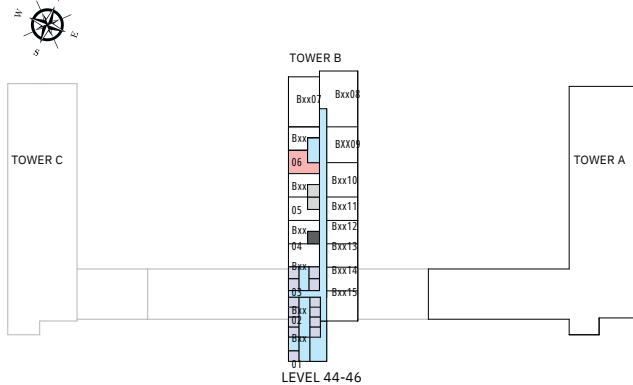
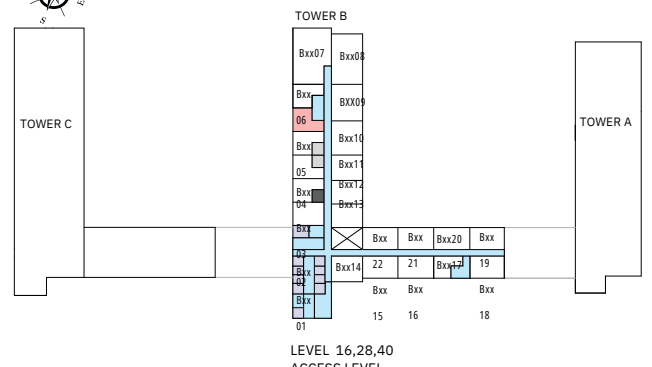
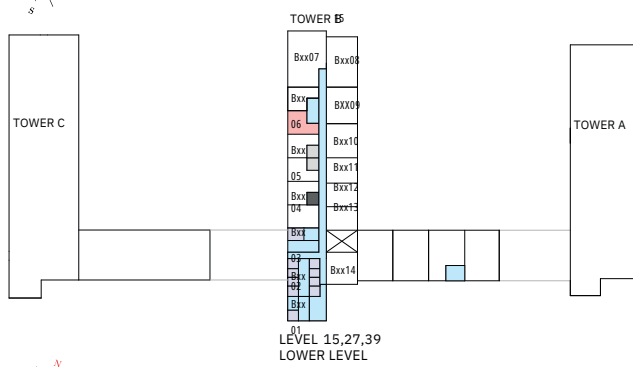
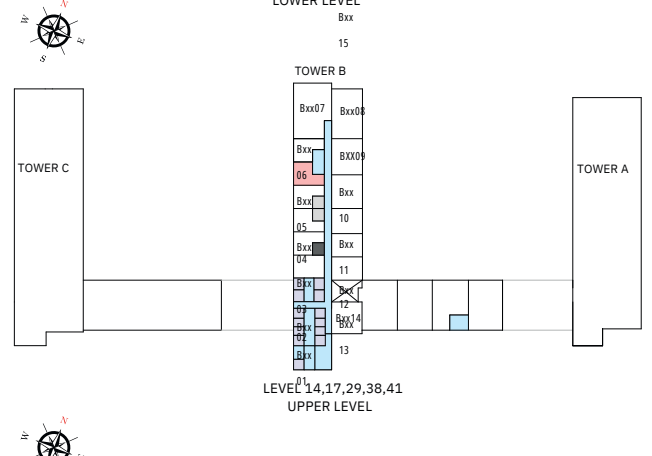
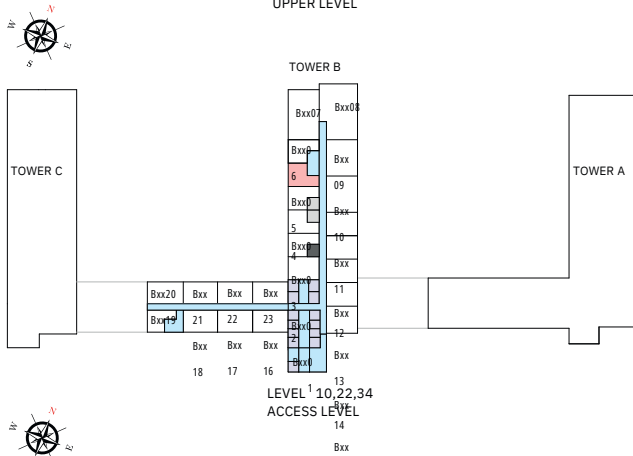
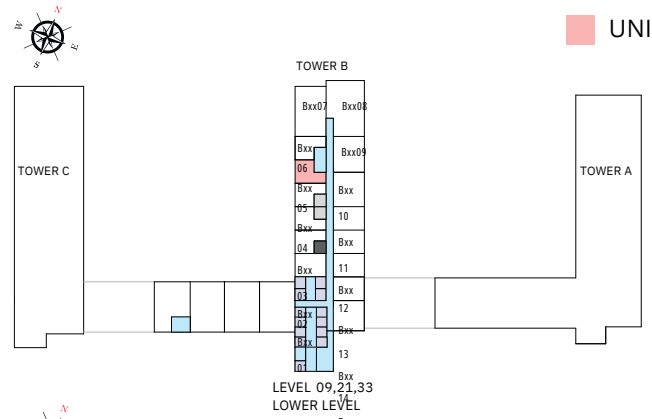
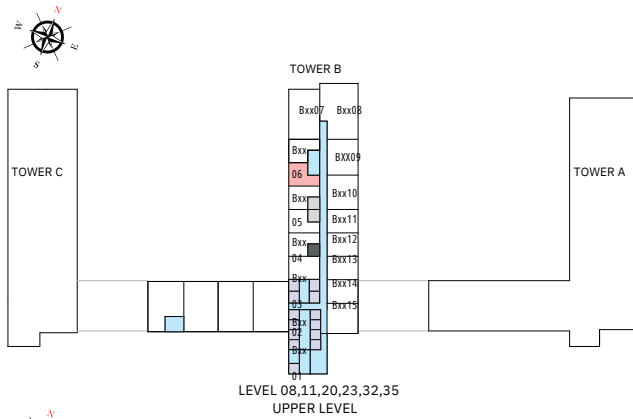

List of unit numbers with this unit plan:

VIEWS

Ras Al Khor, Golf Course, Amenities
B805, B905, B1005, B1105, B1405, B1505, B1605, B1705, B2005, B2105, B2205, B2305

Ras Al Khor, Golf Course
B3805, B3905, B4005, B4105, B4405, B4505, B4605

Ras Al Khor, Golf Course, Water Body
B2705, B2805, B2905, B3205, B3305, B3405, B3505

Disclaimer: 1. All dimensions are in metric, measured to wall finishes. 2. All materials, dimensions & drawings are approximate. 3. Information is subject to change without notice, at developer's absolute discretion. 4. Actual area may vary from the stated area. 5. Drawing are not to scale. 6. All images used are for illustrative purpose only and do not represent the actual size, features, specifications, fittings and furnishings. 7. The developer reserves the right to make revisions/ alterations, at its absolute discretion, without any liability whatsoever.

1 BEDROOM APARTMENT

TYPE E (with balcony)

TOTAL SALEABLE AREA
 SUITE = 503.94 SQ.FT.
 BALCONY = 45.08 SQ.FT.
 TOTAL = 549.02 SQ.FT.

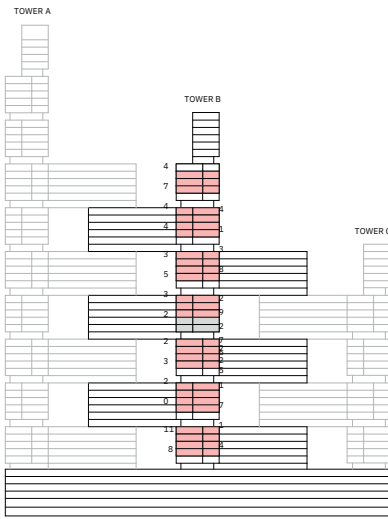

KEY ELEVATION



List of unit numbers with this unit plan:

VIEWS

Ras Al Khor, Amenities
 B803, B903, B1003

Ras Al Khor, Golf Course, Water Body
 B2703, B2803, B2903, B3203, B3303, B3403, B3503,

Ras Al Khor, Golf Course, Amenities
 B1103, B1403, B1503, B1603, B1703, B2003, B2103, B2203, B2303

Ras Al Khor, Golf Course
 B3803, B3903, B4003, B4103, B4403, B 4503, B4603

Disclaimer: 1. All dimensions are in metric, measured to wall finishes. 2. All materials, dimensions & drawings are approximate. 3. Information is subject to change without notice, at developer's absolute discretion. 4. Actual area may vary from the stated area. 5. Drawing are not to scale. 6. All images used are for illustrative purpose only and do not represent the actual size, features, specifications, fittings and furnishings. 7. The developer reserves the right to make revisions/ alterations, at its absolute discretion, without any liability whatsoever.

1 BEDROOM APARTMENT

TYPE E (with balcony)

TOTAL SALEABLE AREA
 SUITE = 503.94 SQ.FT.
 BALCONY = 45.08 SQ.FT.
 TOTAL = 549.02 SQ.FT.

■ UNIT

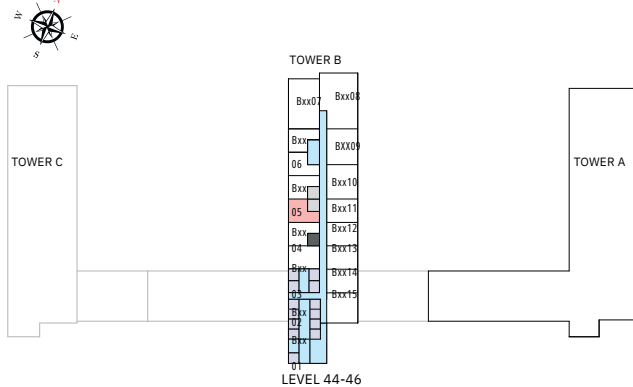
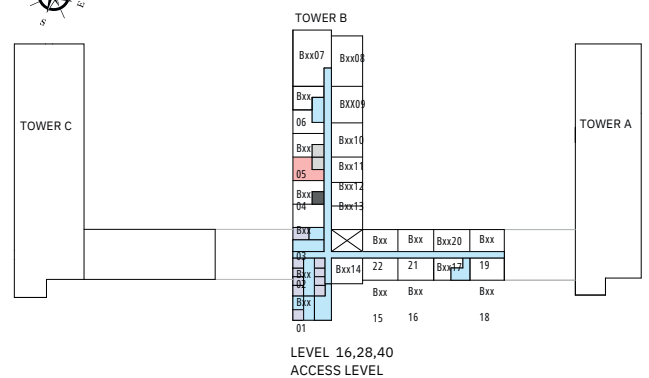
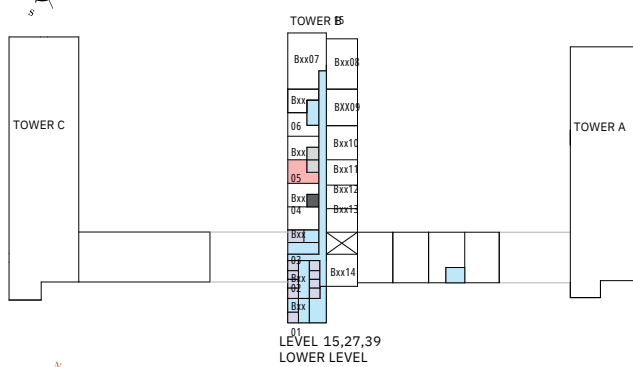
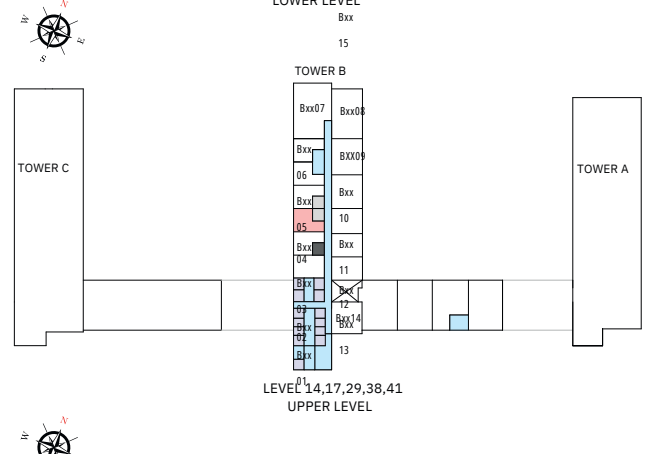
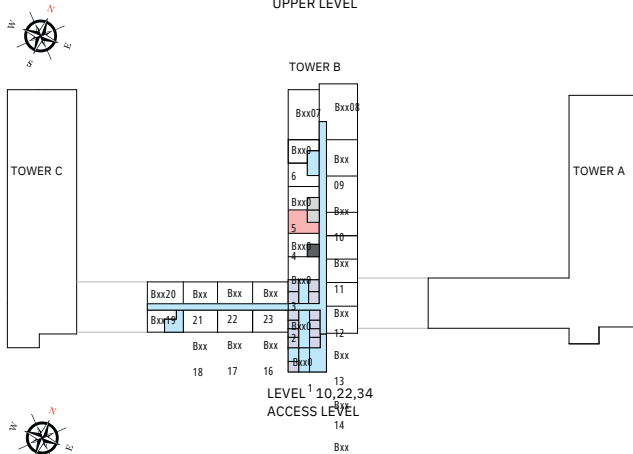
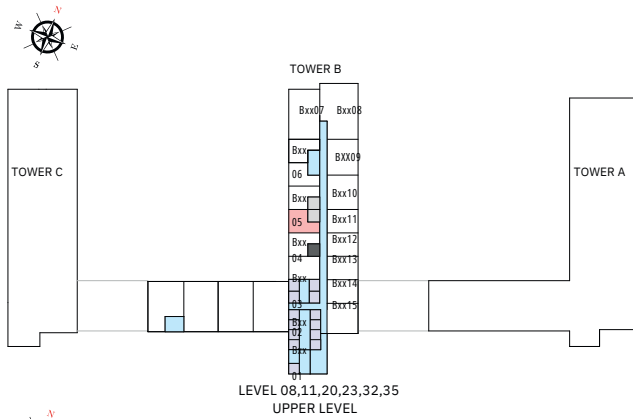

List of unit numbers with this unit plan:

VIEWS

Ras Al Khor, Amenities
 B803, B903, B1003

Ras Al Khor, Golf Course, Water Body
 B2703, B2803, B2903, B3203, B3303, B3403, B3503,

Ras Al Khor, Golf Course, Amenities
 B1103, B1403, B1503, B1603, B1703, B2003, B2103, B2203, B2303

Ras Al Khor, Golf Course
 B3803, B3903, B4003, B4103, B4403, B4503, B4603

Disclaimer: 1. All dimensions are in metric, measured to wall finishes. 2. All materials, dimensions & drawings are approximate. 3. Information is subject to change without notice, at developer's absolute discretion. 4. Actual area may vary from the stated area. 5. Drawing are not to scale. 6. All images used are for illustrative purpose only and do not represent the actual size, features, specifications, fittings and furnishings. 7. The developer reserves the right to make revisions/ alterations, at its absolute discretion, without any liability whatsoever.

1 BEDROOM APARTMENT

TYPE E (with balcony) VARIANT 1

TOTAL SALEABLE AREA
 SUITE = 503.94 SQ.FT.
 BALCONY = 45.08 SQ.FT.
 TOTAL = 549.02 SQ.FT.

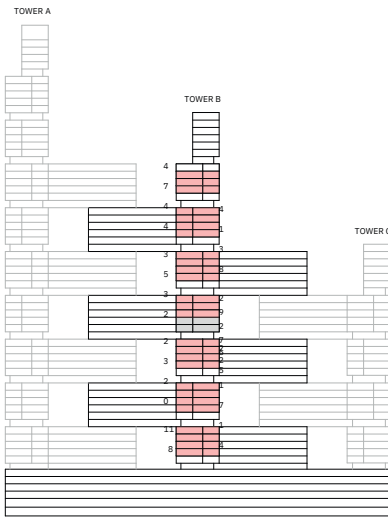

KEY ELEVATION



List of unit numbers with this unit plan:

VIEWS

Ras Al Khor, Amenities
 B802, B902, B1002

Ras Al Khor, Golf Course, Amenities
 B1102, B1402, B1502, B1602, B1702, B2002, B2102, B2202, B2302

Ras Al Khor, Golf Course
 B2702, B2802, B2902, B3202, B3302, B3402, B3502, B3802, B3902, B4002,
 B4102, B4402, B4502, B4602

Disclaimer: 1. All dimensions are in metric, measured to wall finishes. 2. All materials, dimensions & drawings are approximate. 3. Information is subject to change without notice, at developer's absolute discretion. 4. Actual area may vary from the stated area. 5. Drawing are not to scale. 6. All images used are for illustrative purpose only and do not represent the actual size, features, specifications, fittings and furnishings. 7. The developer reserves the right to make revisions/ alterations, at its absolute discretion, without any liability whatsoever.

1 BEDROOM APARTMENT

TYPE E (with balcony) VARIANT 1

TOTAL SALEABLE AREA

SUITE = 503.94 SQ.FT.

BALCONY = 45.08 SQ.FT.

TOTAL = 549.02 SQ.FT.

 UNIT

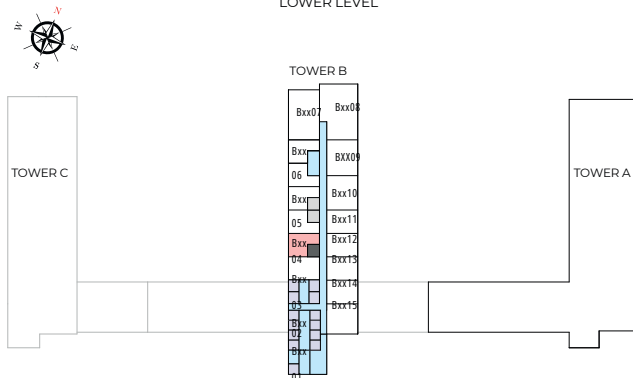
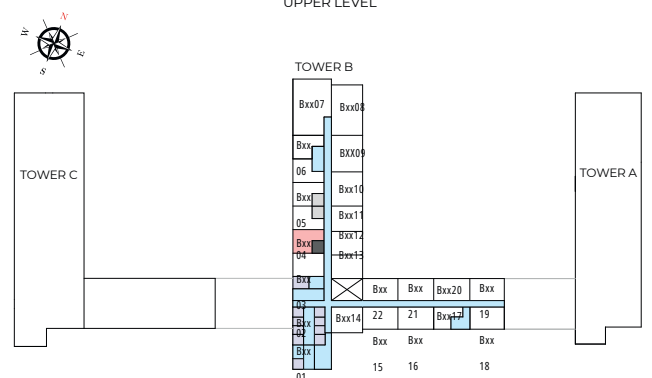
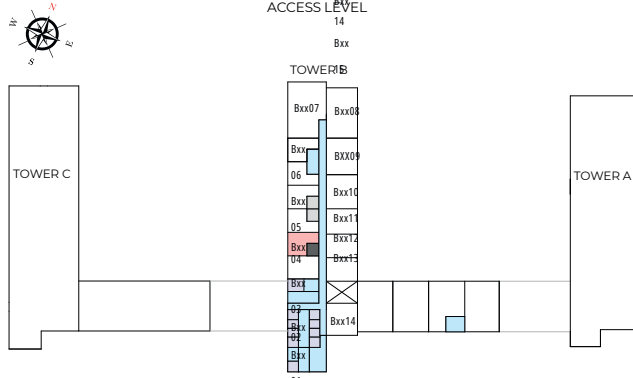
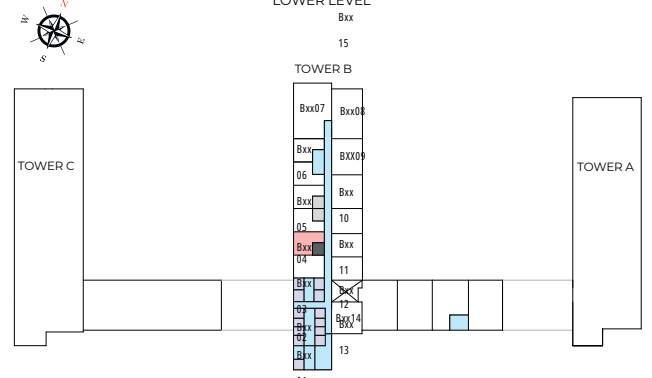
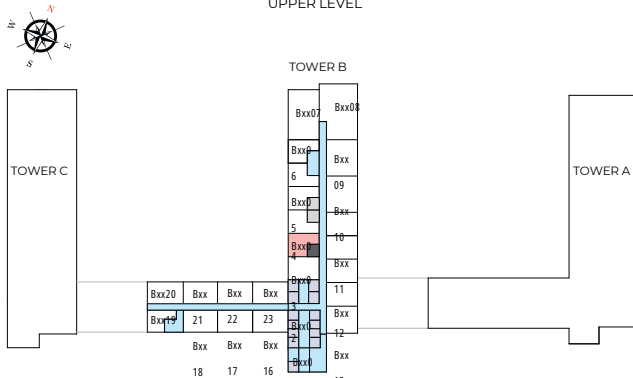
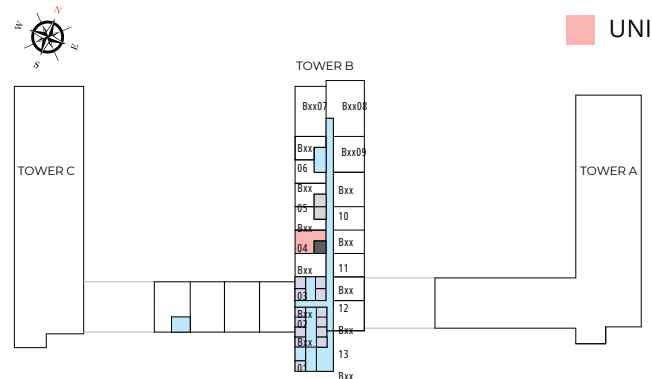
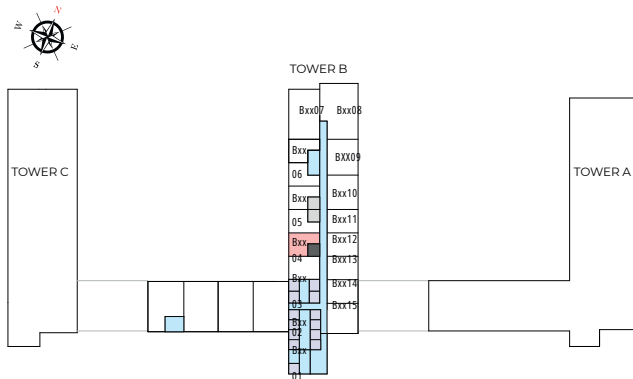

List of unit numbers with this unit plan:

VIEWS

Ras Al Khor, Amenities
B802, B902, B1002

Ras Al Khor, Golf Course, Amenities
B1102, B1402, B1502, B1602, B1702, B2002, B2102, B2202, B2302

Ras Al Khor, Golf Course
B2702, B2802, B2902, B3202, B3302, B3402, B3502, B3802, B3902, B4002, B4102, B4402, B4502, B4602

Disclaimer: 1. All dimensions are in metric, measured to wall finishes. 2. All materials, dimensions & drawings are approximate. 3. Information is subject to change without notice, at developer's absolute discretion. 4. Actual area may vary from the stated area. 5. Drawing are not to scale. 6. All images used are for illustrative purpose only and do not represent the actual size, features, specifications, fittings and furnishings. 7. The developer reserves the right to make revisions/ alterations, at its absolute discretion, without any liability whatsoever.

1 BEDROOM APARTMENT

TYPE F (with balcony)

TOTAL SALEABLE AREA
 SUITE = 508.06 SQ.FT.
 BALCONY = 45.35 SQ.FT.
 TOTAL = 553.41 SQ.FT.

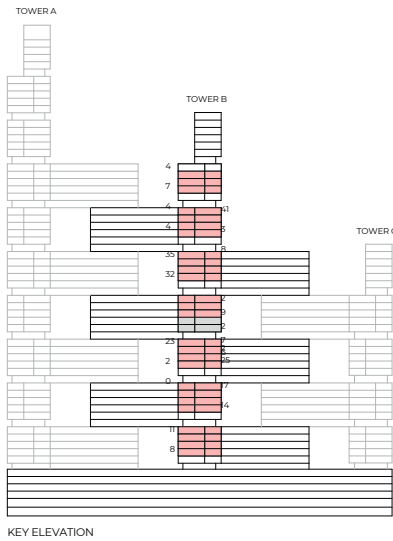

List of unit numbers with this unit plan:

VIEWS

Ras Al Khor, Amenities
 B804, B904, B1004

Ras Al Khor, Golf Course, Water Body
 B2704, B2804, B2904, B3204, B3304, B3404, B3504

Ras Al Khor, Golf Course, Amenities
 B1104, B1404, B1504, B1604, B1704, B2004, B2104, B2204, B2304

Ras Al Khor, Golf Course
 B3804, B3904, B4004, B4104, B4404, B4504, B4604

Disclaimer: 1. All dimensions are in metric, measured to wall finishes. 2. All materials, dimensions & drawings are approximate. 3. Information is subject to change without notice, at developer's absolute discretion. 4. Actual area may vary from the stated area. 5. Drawing are not to scale. 6. All images used are for illustrative purpose only and do not represent the actual size, features, specifications, fittings and furnishings. 7. The developer reserves the right to make revisions/ alterations, at its absolute discretion, without any liability whatsoever.

1 BEDROOM APARTMENT

TYPE F (with balcony)

TOTAL SALEABLE AREA

SUITE = 508.06 SQ.FT.

BALCONY = 45.35 SQ.FT.

TOTAL = 553.41 SQ.FT.

 UNIT

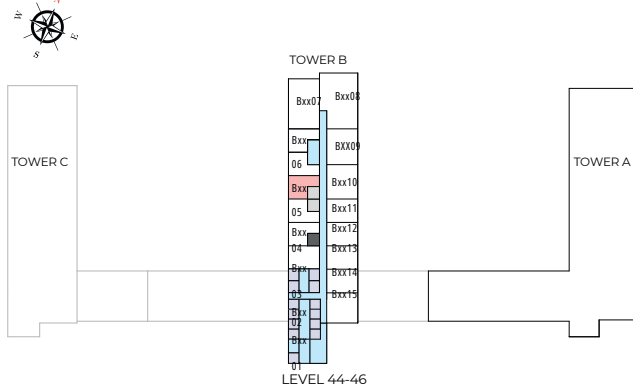
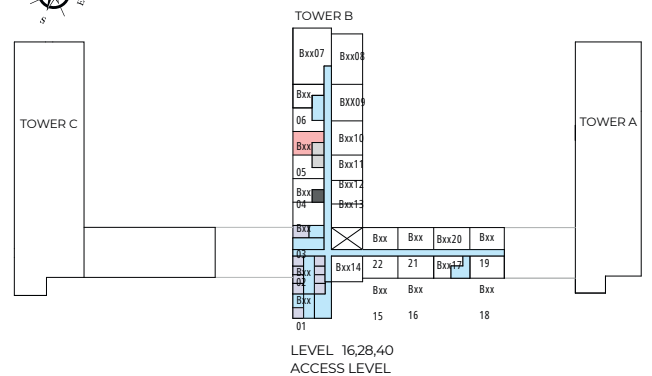
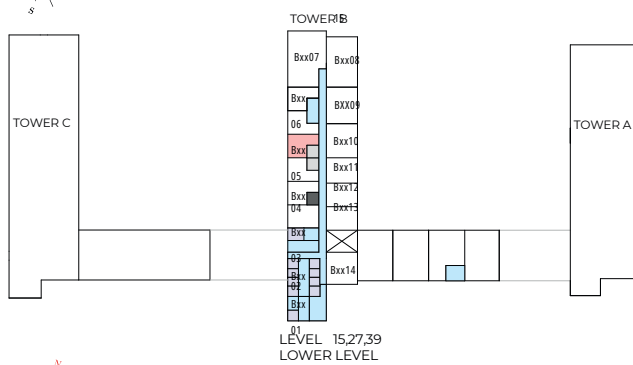
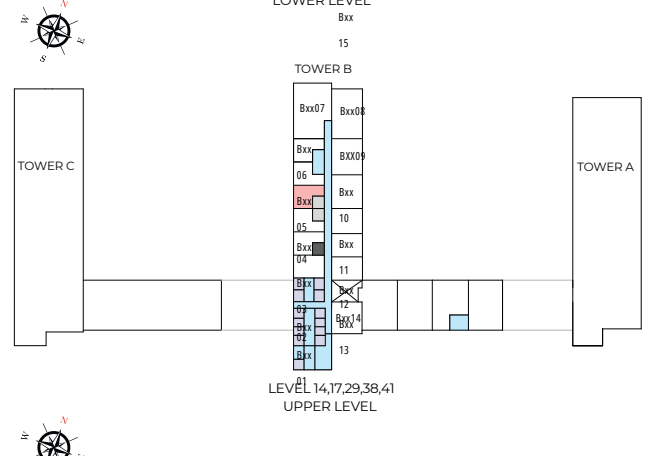
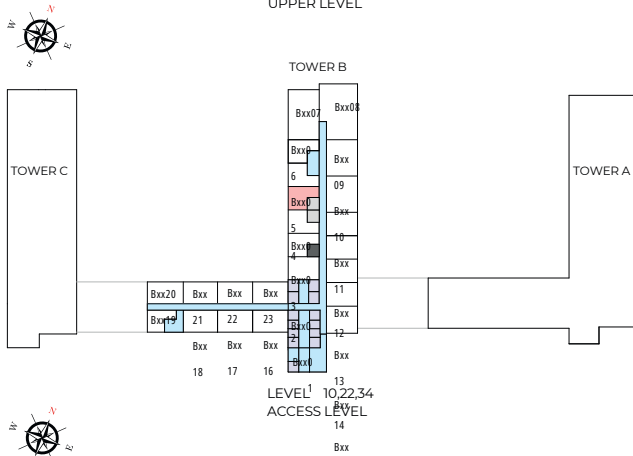
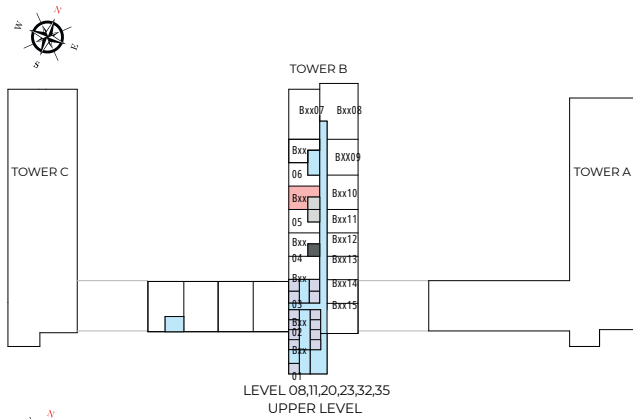

List of unit numbers with this unit plan:

VIEWS

Ras Al Khor, Amenities
B804, B904, B1004

Ras Al Khor, Golf Course, Amenities
B1104, B1404, B1504, B1604, B1704, B2004, B2104, B2204, B2304

Ras Al Khor, Golf Course, Water Body
B2704, B2804, B2904, B3204, B3304, B3404, B3504

Ras Al Khor, Golf Course
B3804, B3904, B4004, B4104, B4404, B4504, B4604

Disclaimer: 1. All dimensions are in metric, measured to wall finishes. 2. All materials, dimensions & drawings are approximate. 3. Information is subject to change without notice, at developer's absolute discretion. 4. Actual area may vary from the stated area. 5. Drawing are not to scale. 6. All images used are for illustrative purpose only and do not represent the actual size, features, specifications, fittings and furnishings. 7. The developer reserves the right to make revisions/ alterations, at its absolute discretion, without any liability whatsoever.

1.5 BEDROOM APARTMENT

TYPE A (with study room + balcony)

TOTAL SALEABLE AREA
 SUITE = 630.99 SQ.FT.
 BALCONY = 45.99 SQ.FT.
 TOTAL = 676.98 SQ.FT.

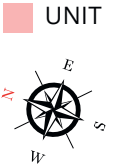
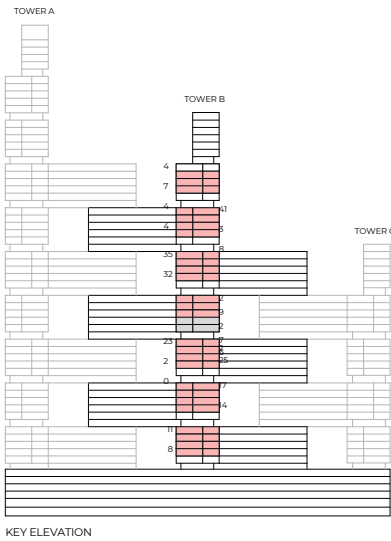

List of unit numbers with this unit plan:

VIEWS

Amenities, Creek
 B813, B913, B1013

Golf Course, Amenities, Creek
 B1113, B1413, B1513, B1613, B1713, B2013, B2113, B2213, B2313

Golf Course, Creek
 B2713, B2813, B2913, B3213, B3313, B3413, B3513, B3813, B3913, B4013, B4113, B4413, B4513, B4613

Disclaimer: 1. All dimensions are in metric, measured to wall finishes. 2. All materials, dimensions & drawings are approximate. 3. Information is subject to change without notice, at developer's absolute discretion. 4. Actual area may vary from the stated area. 5. Drawing are not to scale. 6. All images used are for illustrative purpose only and do not represent the actual size, features, specifications, fittings and furnishings. 7. The developer reserves the right to make revisions/ alterations, at its absolute discretion, without any liability whatsoever.

1.5 BEDROOM APARTMENT

TYPE A (with study room + balcony)

TOTAL SALEABLE AREA
 SUITE = 630.99 SQ.FT.
 BALCONY = 45.99 SQ.FT.
 TOTAL = 676.98 SQ.FT.

■ UNIT

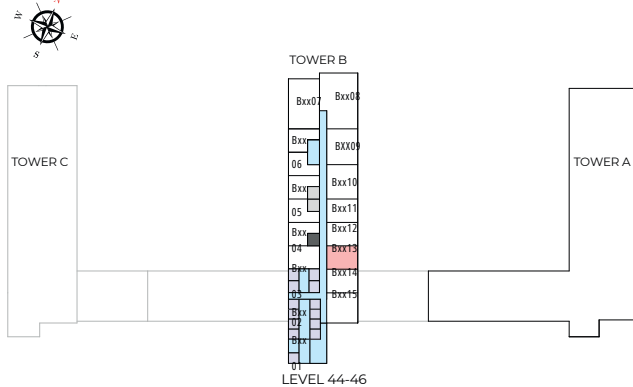
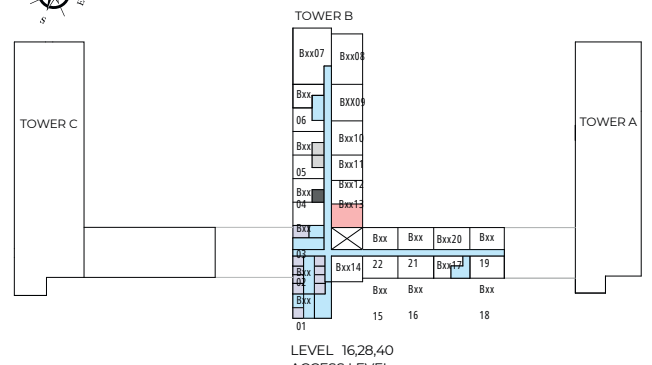
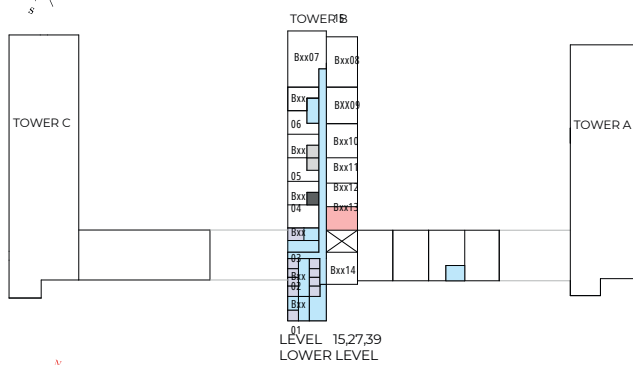
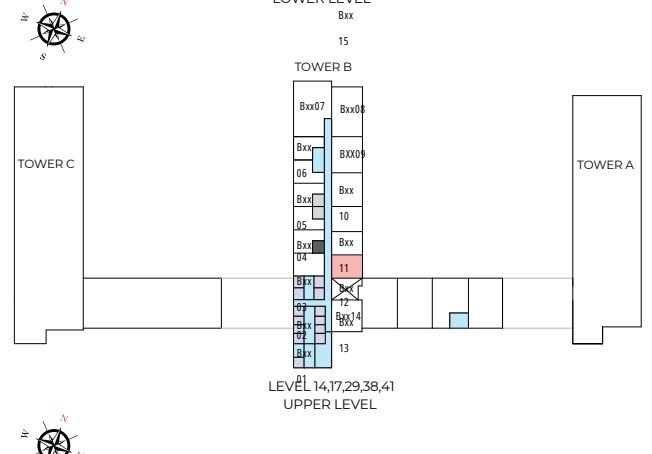
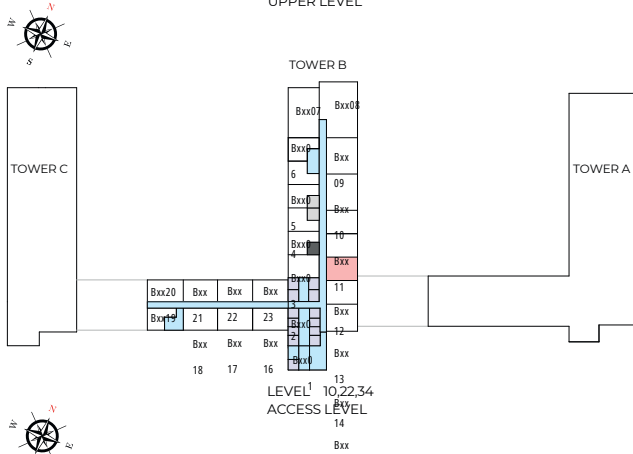
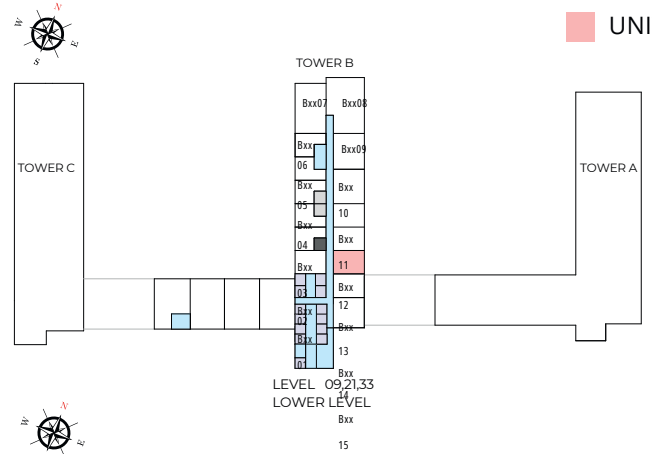
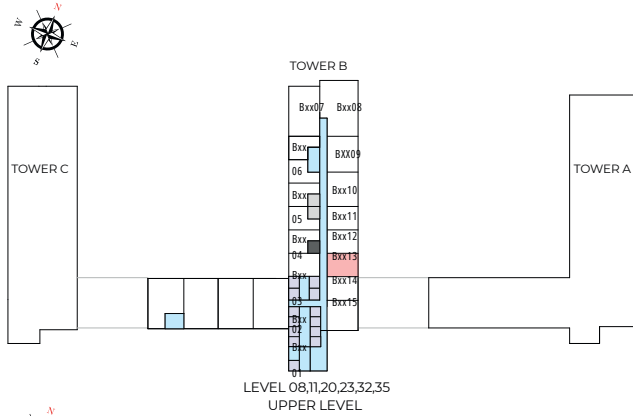

List of unit numbers with this unit plan:

VIEWS

Amenities, Creek
 B813, B913, B1013

Golf Course, Amenities, Creek
 B1113, B1413, B1513, B1613, B1713, B2013, B2113, B2213, B2313

Golf Course, Creek
 B2713, B2813, B2913, B3213, B3313, B3413, B3513, B3813, B3913, B4013, B4113, B4413, B4513, B4613

Disclaimer: 1. All dimensions are in metric, measured to wall finishes. 2. All materials, dimensions & drawings are approximate. 3. Information is subject to change without notice, at developer's absolute discretion. 4. Actual area may vary from the stated area. 5. Drawing are not to scale. 6. All images used are for illustrative purpose only and do not represent the actual size, features, specifications, fittings and furnishings. 7. The developer reserves the right to make revisions/ alterations, at its absolute discretion, without any liability whatsoever.

1.5 BEDROOM APARTMENT

TYPE A (with study room + balcony) VARIANT 1

TOTAL SALEABLE AREA
 SUITE = 630.99 SQ.FT.
 BALCONY = 45.99 SQ.FT.
 TOTAL = 676.98 SQ.FT.

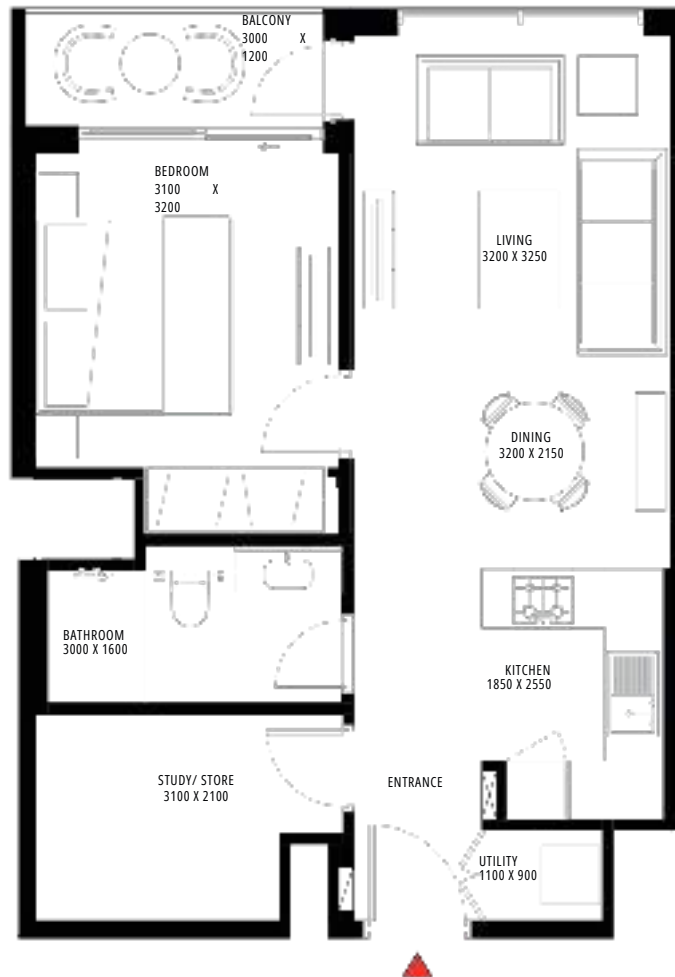
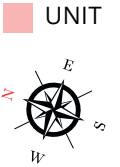
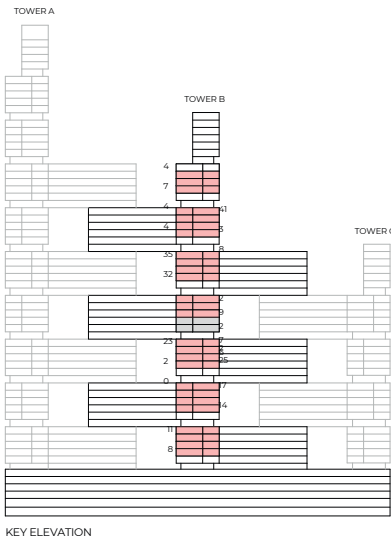

List of unit numbers with this unit plan:

VIEWS

Amenities, Creek
 B812, B912, B1012

Golf Course, Amenities, Creek
 B1112, B1412, B1512, B1612, B1712, B2012, B2112, B2212, B2312

Golf Course, Creek
 B2712, B2812, B2912, B3212, B3312, B3412, B3512, B3812, B3912, B4012, B4112, B4412, B4512, B4612

Disclaimer: 1. All dimensions are in metric, measured to wall finishes. 2. All materials, dimensions & drawings are approximate. 3. Information is subject to change without notice, at developer's absolute discretion. 4. Actual area may vary from the stated area. 5. Drawing are not to scale. 6. All images used are for illustrative purpose only and do not represent the actual size, features, specifications, fittings and furnishings. 7. The developer reserves the right to make revisions/ alterations, at its absolute discretion, without any liability whatsoever.

1.5 BEDROOM APARTMENT

TYPE A (with study room + balcony) VARIANT 1

TOTAL SALEABLE AREA

SUITE = 630.99 SQ.FT.

BALCONY = 45.99 SQ.FT.

TOTAL = 676.98 SQ.FT.

UNIT

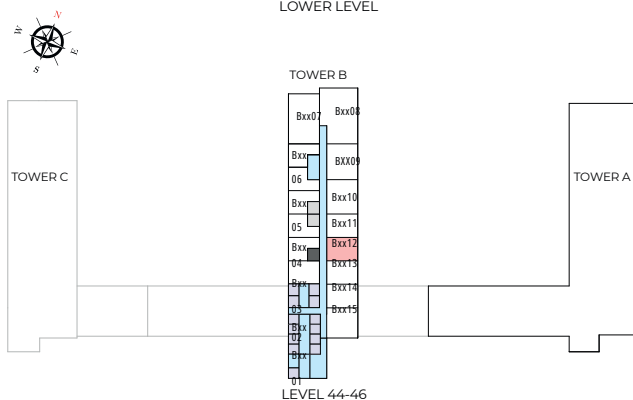
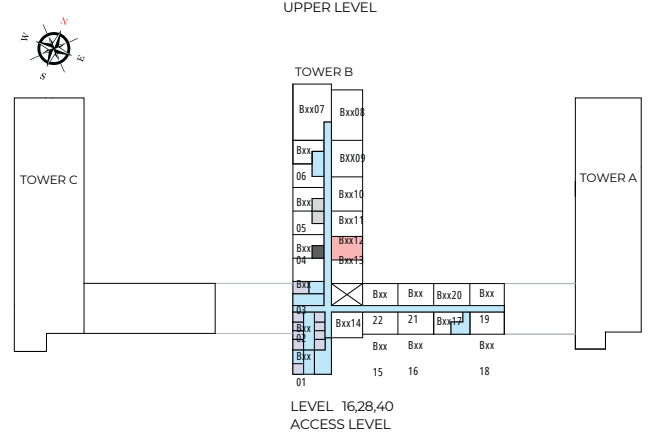
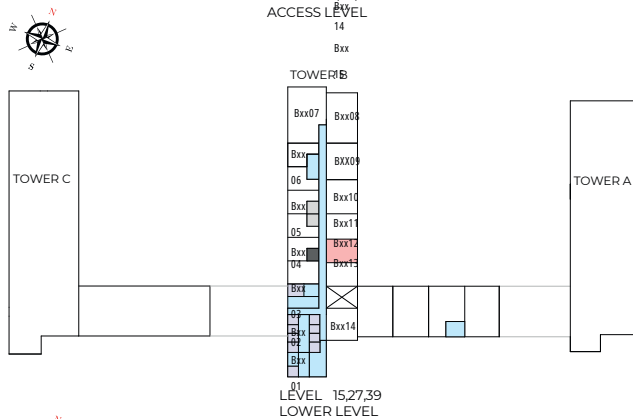
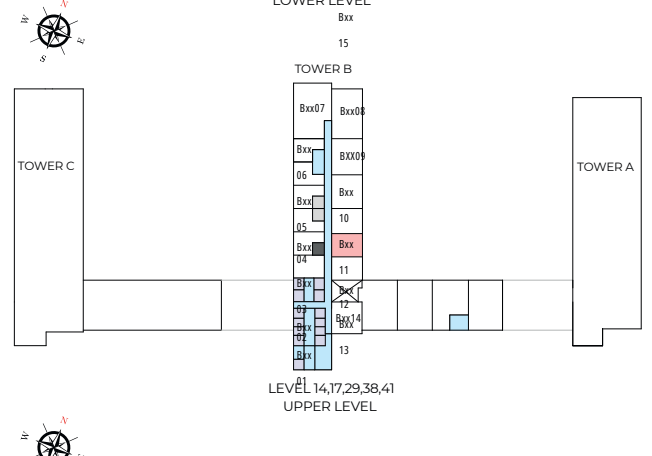
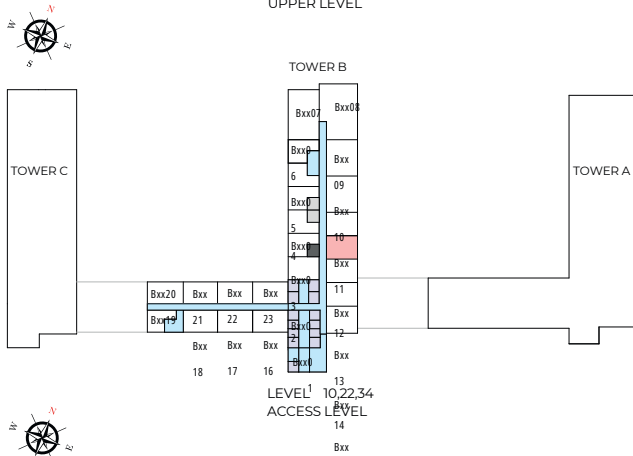
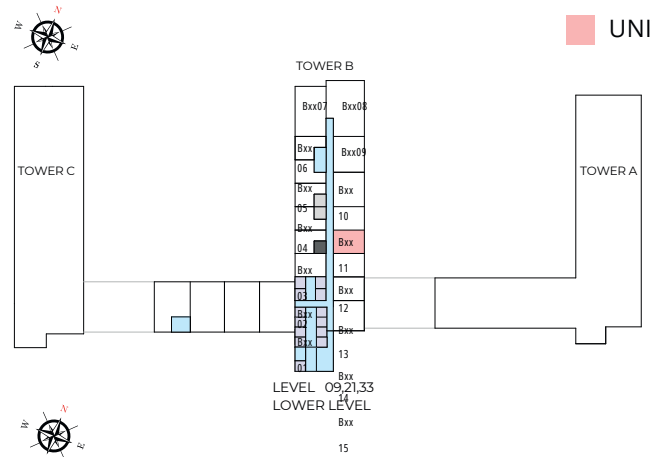
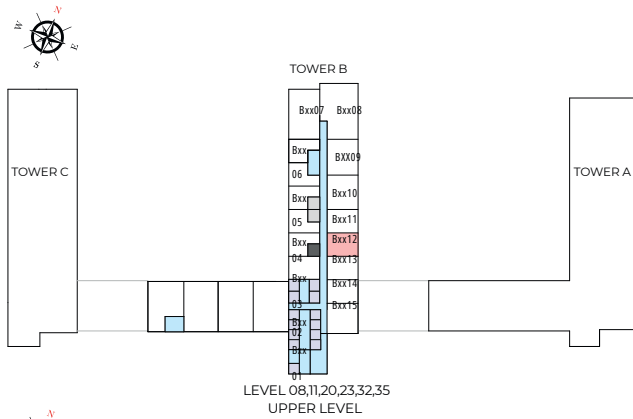

List of unit numbers with this unit plan:

VIEWS

Amenities, Creek
B812, B912, B1012

Golf Course, Amenities, Creek
B1112, B1412, B1512, B1612, B1712, B2012, B2112, B2212, B2312

Golf Course, Creek
B2712, B2812, B2912, B3212, B3312, B3412, B3512, B3812, B3912, B4012, B4112, B4412, B4512, B4612

Disclaimer: 1. All dimensions are in metric, measured to wall finishes. 2. All materials, dimensions & drawings are approximate. 3. Information is subject to change without notice, at developer's absolute discretion. 4. Actual area may vary from the stated area. 5. Drawing are not to scale. 6. All images used are for illustrative purpose only and do not represent the actual size, features, specifications, fittings and furnishings. 7. The developer reserves the right to make revisions/ alterations, at its absolute discretion, without any liability whatsoever.

1.5 BEDROOM APARTMENT

TYPE A (with study room + balcony) VARIANT 2

TOTAL SALEABLE AREA
 SUITE = 635.38 SQ.FT.
 BALCONY = 45.90 SQ.FT.
 TOTAL = 681.28 SQ.FT.

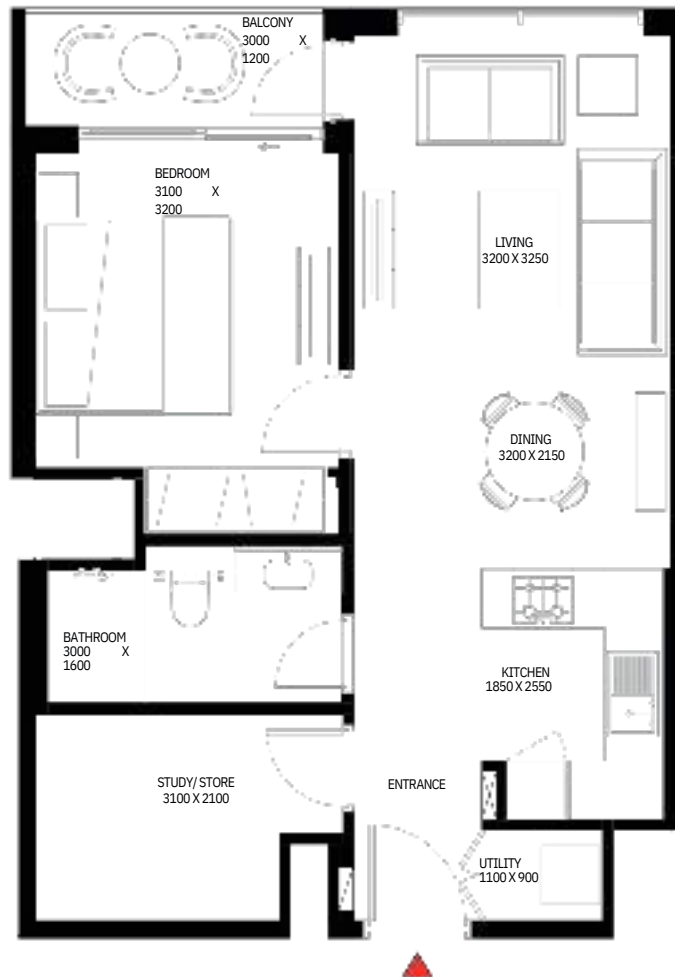
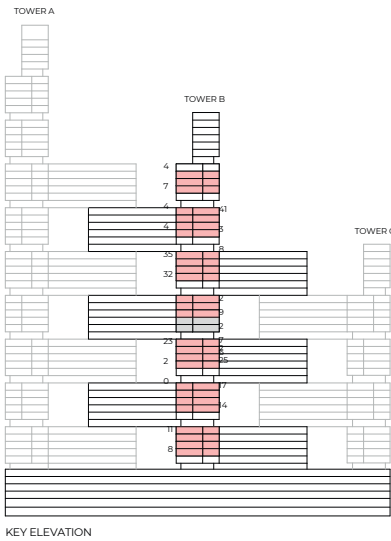

List of unit numbers with this unit plan:

VIEWS

Ras Al Khor, Amenities
 B801, B901, B1001

Ras Al Khor, Golf Course, Amenities
 B1101, B1401, B1501, B1601, B1701, B2001, B2101, B2201, B2301

Ras Al Khor, Golf Course
 B2701, B2801, B2901, B3201, B3301, B3401, B3501, B3801, B3901, B4001, B4101, B4401, B4501, B4601

Disclaimer: 1. All dimensions are in metric, measured to wall finishes. 2. All materials, dimensions & drawings are approximate. 3. Information is subject to change without notice, at developer's absolute discretion. 4. Actual area may vary from the stated area. 5. Drawing are not to scale. 6. All images used are for illustrative purpose only and do not represent the actual size, features, specifications, fittings and furnishings. 7. The developer reserves the right to make revisions/ alterations, at its absolute discretion, without any liability whatsoever.

1.5 BEDROOM APARTMENT

TYPE A (with study room + balcony) VARIANT 2

TOTAL SALEABLE AREA

SUITE = 635.38 SQ.FT.

BALCONY = 45.90 SQ.FT.

TOTAL = 681.28 SQ.FT.

■ UNIT

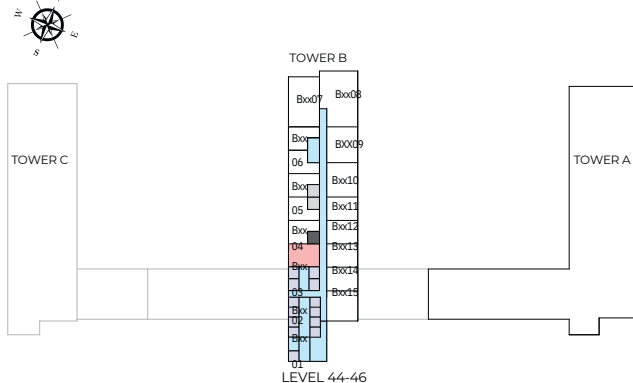
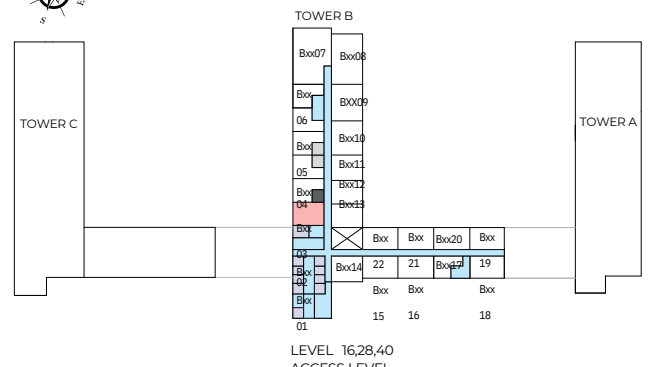
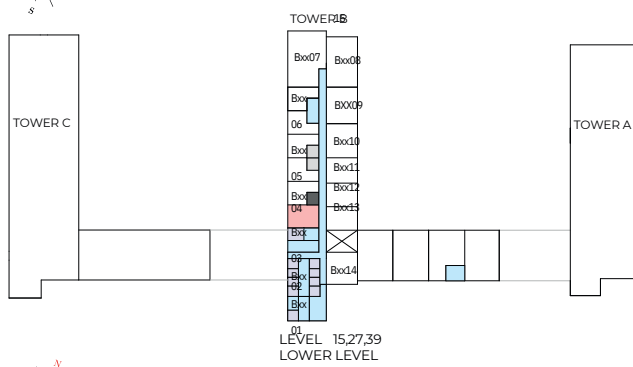
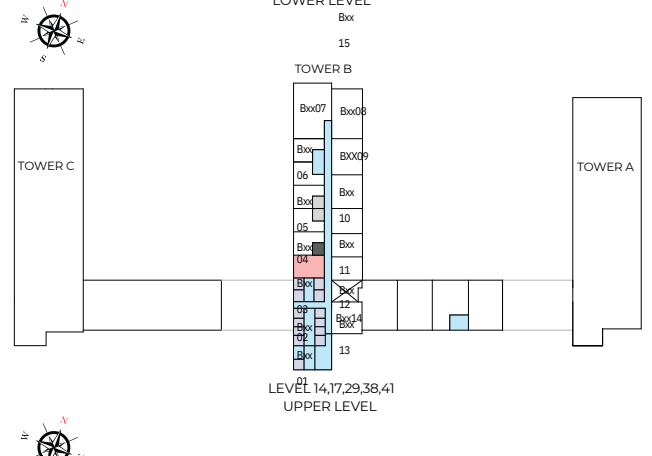
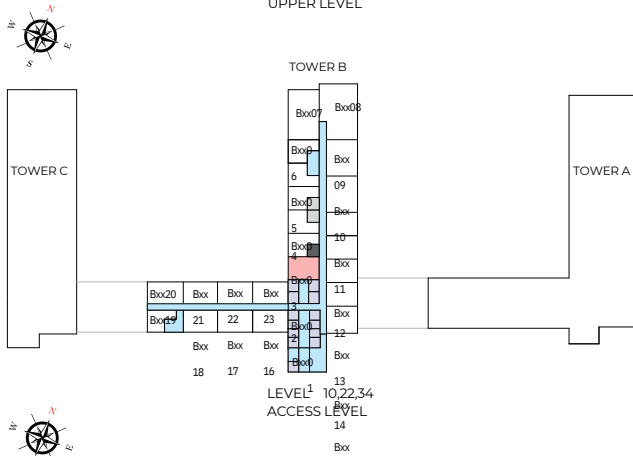
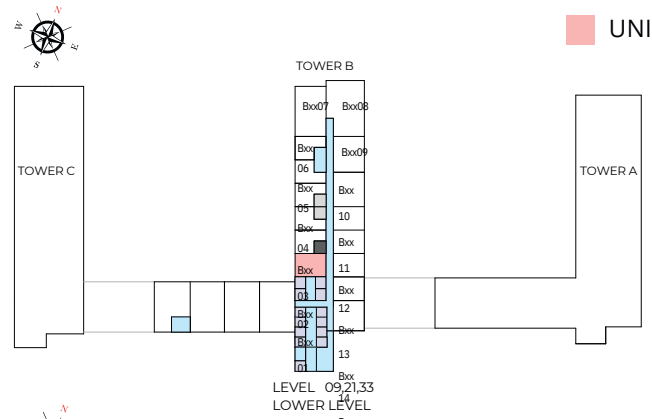
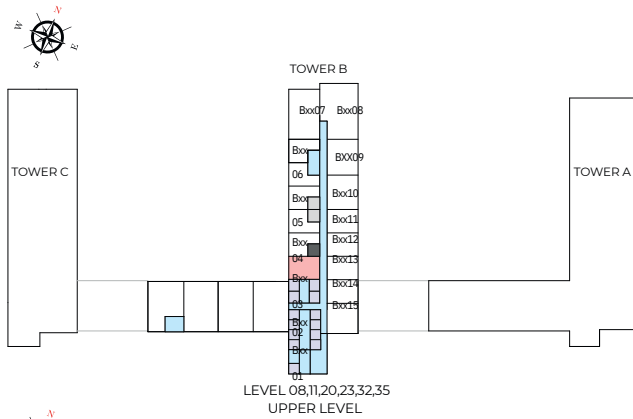

List of unit numbers with this unit plan:

VIEWS

Ras Al Khor, Amenities
B801, B901, B1001

Ras Al Khor, Golf Course, Amenities
B1101, B1401, B1501, B1601, B1701, B2001, B2101, B2201, B2301

Ras Al Khor, Golf Course

B2701, B2801, B2901, B3201, B3301, B3401, B3501, B3801, B3901, B4001, B4101, B4401, B4501, B4601

Disclaimer: 1. All dimensions are in metric, measured to wall finishes. 2. All materials, dimensions & drawings are approximate. 3. Information is subject to change without notice, at developer's absolute discretion. 4. Actual area may vary from the stated area. 5. Drawing are not to scale. 6. All images used are for illustrative purpose only and do not represent the actual size, features, specifications, fittings and furnishings. 7. The developer reserves the right to make revisions/ alterations, at its absolute discretion, without any liability whatsoever.

2 BEDROOM APARTMENT

TYPE D (with powder room + balcony)

TOTAL SALEABLE AREA
 SUITE = 968.11 SQ.FT.
 BALCONY = 48.13 SQ.FT.
 TOTAL = 1,016.24 SQ.FT.

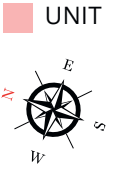
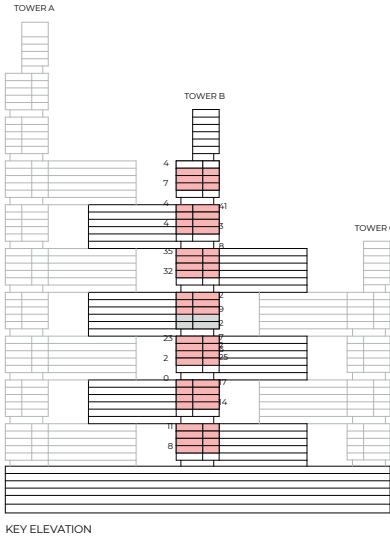

List of unit numbers with this unit plan:

VIEWS

Golf Course, Amenities, Creek
 B809, B909, B1009

Golf Course, Amenities, Creek
 B1109, B1110, B1409, B1410, B1509, B1510, B1609, B1610, B1709, B1710, B2009, B2010, B2109, B2110, B2209, B2210, B2309, B2310

Amenities, Creek
 B810, B910, B1010

Golf Course, Creek
 B2709, B2710, B2809, B2810, B2909, B2910, B3209, B3210, B3309, B3310, B3409, B3410, B3509, B3510, B3809, B3810, B3909, B3910, B4009, B4010, B4109, B4110, B4409, B4410, B4509, B4510, B4609, B4610

Disclaimer: 1. All dimensions are in metric, measured to wall finishes. 2. All materials, dimensions & drawings are approximate. 3. Information is subject to change without notice, at developer's absolute discretion. 4. Actual area may vary from the stated area. 5. Drawing are not to scale. 6. All images used are for illustrative purpose only and do not represent the actual size, features, specifications, fittings and furnishings. 7. The developer reserves the right to make revisions/ alterations, at its absolute discretion, without any liability whatsoever.

2 BEDROOM APARTMENT

TYPE D (with powder room + balcony)

TOTAL SALEABLE AREA
 SUITE = 968.11 SQ.FT.
 BALCONY = 48.13 SQ.FT.
 TOTAL = 1,016.24 SQ.FT.

■ UNIT

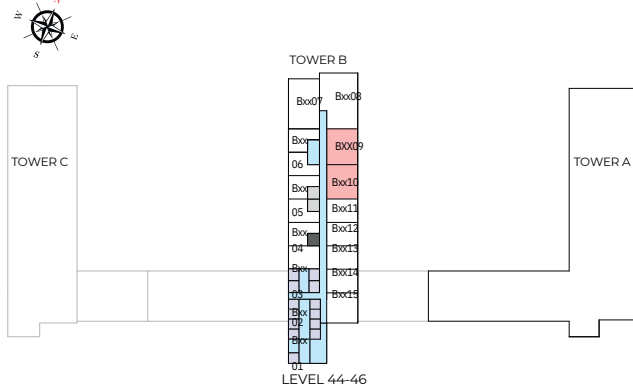
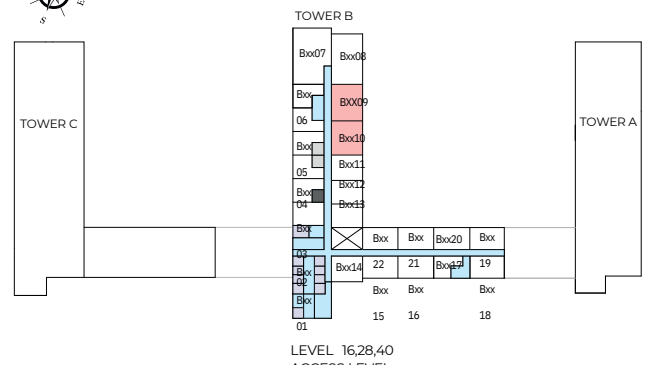
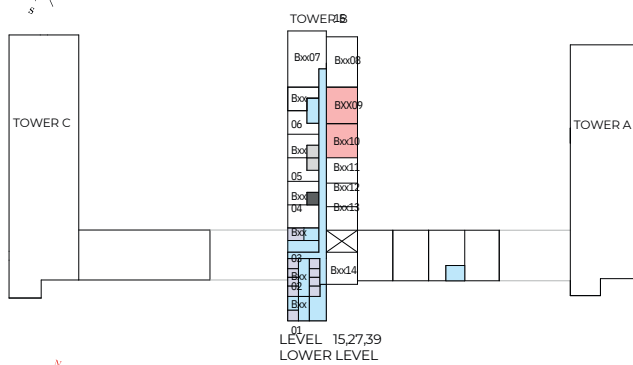
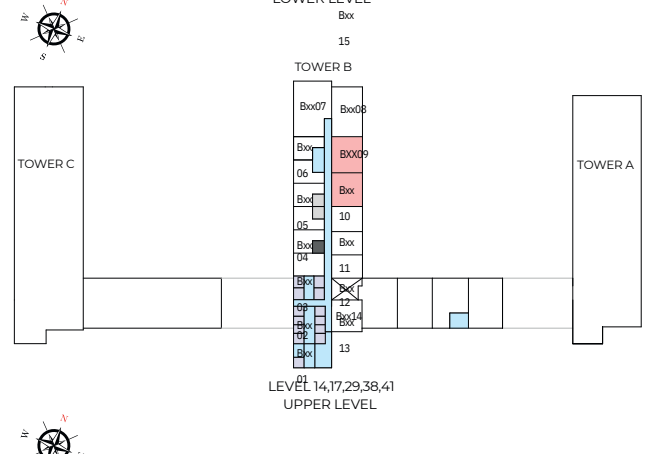
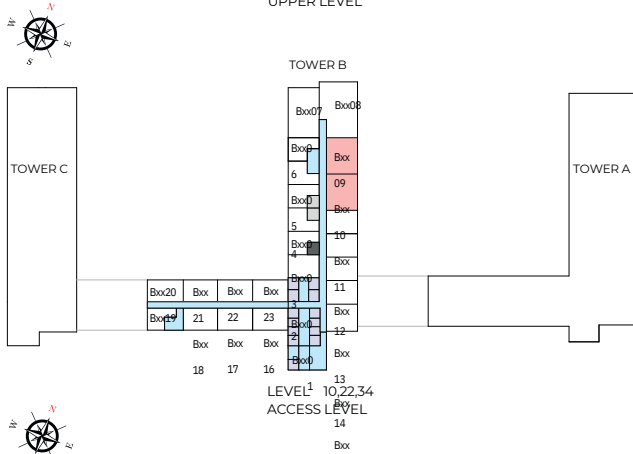

List of unit numbers with this unit plan:

VIEWS

Golf Course, Amenities, Creek
 B809, B909, B1009

Golf Course, Amenities, Creek
 B1109, B1110, B1409, B1410, B1509, B1510, B1609, B1610, B1709, B1710, B2009, B2010, B2109, B2110, B2209, B2210, B2309, B2310

Amenities, Creek
 B810, B910, B1010

Golf Course, Creek
 B2709, B2710, B2809, B2810, B2909, B2910, B3209, B3210, B3309, B3310, B3409, B3410, B3509, B3510, B3809, B3810, B3909, B3910, B4009, B4010, B4109, B4110, B4409, B4410, B4509, B4510, B4609, B4610

Disclaimer: 1. All dimensions are in metric, measured to wall finishes. 2. All materials, dimensions & drawings are approximate. 3. Information is subject to change without notice, at developer's absolute discretion. 4. Actual area may vary from the stated area. 5. Drawing are not to scale. 6. All images used are for illustrative purpose only and do not represent the actual size, features, specifications, fittings and furnishings. 7. The developer reserves the right to make revisions/ alterations, at its absolute discretion, without any liability whatsoever.



TOTALLY HOME

REAL ESTATE



[totallyhomerealestate](#)



[totallyhomerealestate](#)



[totallyhomerealestate](#)



[totallyhomerealestate.com](#)

+971 54 289 7686

sales@totallyhomerealestate.com

support@totallyhomerealestate.com

admin@totallyhomerealestate.com

Office 103, Building 6 Bay Square Tower, Business Bay PO Box 418317, Dubai